

IMPORTANT
Keep manual
on file at all
times.

stryker[®]
Medical

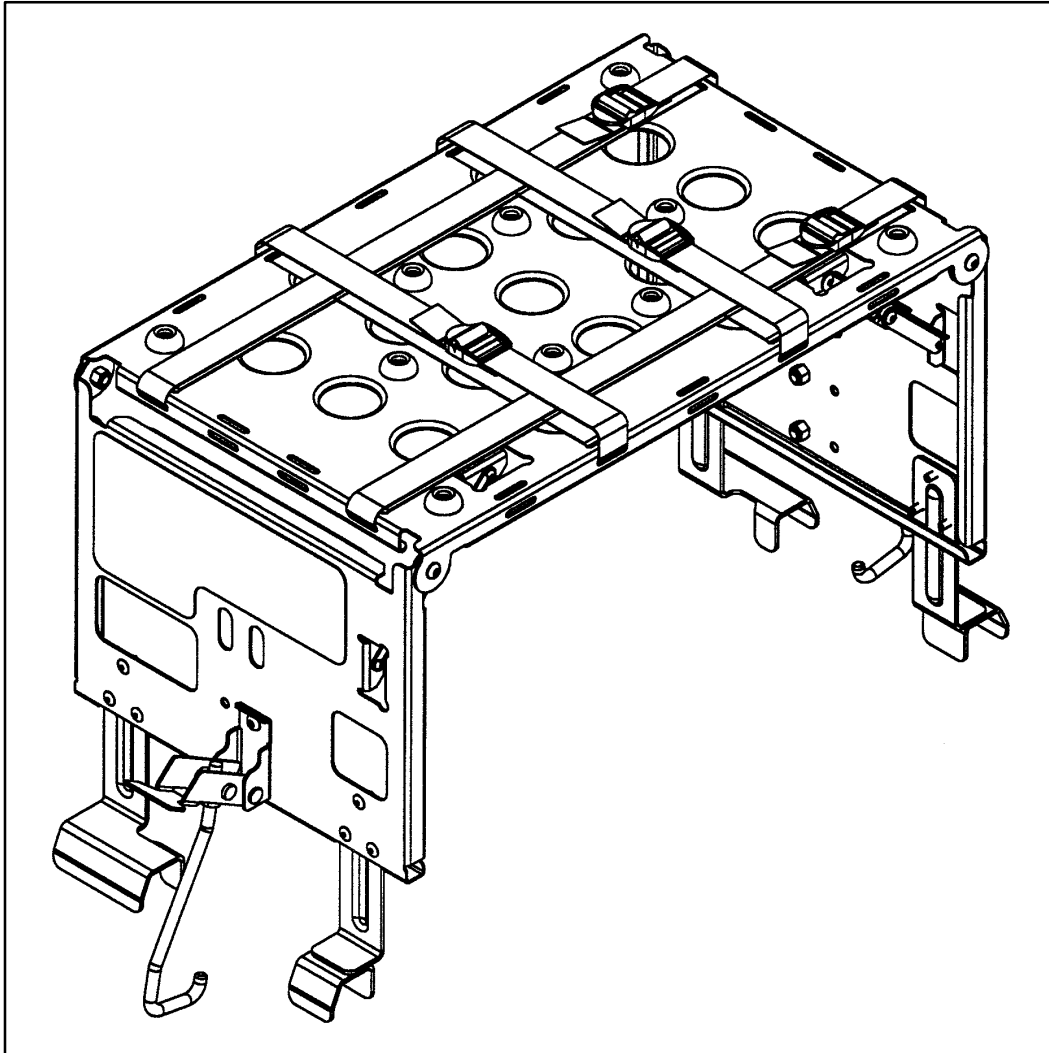

Model 6060-170

▲RUGGED™ Defibrillator Platform

OPERATIONS/MAINTENANCE MANUAL

For Parts or Technical Assistance
1-800-784-4336

Table of Contents

Warranty	
Obtaining Parts and Service	2
Supplemental Warranty Coverage	2
Return Authorization	3
Freight Damage Claims	3
Safety Precautions	4
Preventative Maintenance	5
Operating the Rugged Defibrillator Platform	6–9
Defibrillator Platform Assembly	10, 11
Latch Assembly	12

Warranty

Limited Warranty:

Stryker Medical Division, a division of Stryker Corporation, warrants to the original purchaser that its products should be free from defects in material and workmanship for a period of one (1) year after date of delivery. Stryker's obligation under this warranty is expressly limited to supplying replacement parts and labor for, or replacing, at its option, any product which is, in the sole discretion of Stryker, found to be defective. Stryker warrants to the original purchaser that the frame and welds on its beds will be free from structural defects for as long as the original purchaser owns the bed. If requested by Stryker, products or parts for which a warranty claim is made shall be returned prepaid to Stryker's factory. Any improper use or any alteration or repair by others in such manner as in Stryker's judgement affects the product materially and adversely shall void this warranty. No employee or representative of Stryker is authorized to change this warranty in any way.

This statement constitutes Stryker's entire warranty with respect to the aforesaid equipment. STRYKER MAKES NO OTHER WARRANTY OR REPRESENTATION, EITHER EXPRESSED OR IMPLIED, EXCEPT AS SET FORTH HEREIN. THERE IS NO WARRANTY OF MERCHANTABILITY AND THERE ARE NO WARRANTIES OF FITNESS FOR ANY PARTICULAR PURPOSE. IN NO EVENT SHALL STRYKER BE LIABLE HEREUNDER FOR INCIDENTAL OR CONSEQUENTIAL DAMAGES ARISING FROM OR IN ANY MANNER RELATED TO SALES OR USE OF ANY SUCH EQUIPMENT.

To Obtain Parts and Service:

Stryker products are supported by a nationwide network of dedicated Stryker Field Service Representatives. These representatives are factory trained, available locally, and carry a substantial spare parts inventory to minimize repair time. Simply call your local representative, or call Stryker Customer Service at (800) 327-0770.

Supplemental Warranty Coverage:

Stryker has developed a comprehensive program of extended warranty options designed to keep your equipment operating at peak performance at the same time it eliminates unexpected costs. We recommend that these programs be activated *before* the expiration of the new product warranty to eliminate the potential of additional equipment upgrade charges. Stryker offers the following Supplemental Warranties:

Extended (Parts and Labor)

- All replacement parts (excluding mattresses and consumable items)
- Labor and travel for *all* scheduled and unscheduled calls
- Annual Preventive Maintenance Inspections and repairs
- JCAHO paperwork for preventive maintenance
- Priority Emergency Service

Standard (Labor Only):

- Labor and travel for *all* scheduled and unscheduled calls
- Annual Preventive Maintenance Inspections and repairs
- JCAHO paperwork for preventive maintenance
- Priority Emergency Service

Basic (Parts Only):

- All replacement parts (excluding mattresses and consumable items)
- Priority Emergency Service

Please call your local representative, or call (800) 327-0770 for further information

Warranty

Return Authorization:

Merchandise cannot be returned without approval from the Stryker Customer Service Department. An authorization number will be provided which must be printed on the returned merchandise. Stryker reserves the right to charge shipping and restocking fees on returned items.

SPECIAL, MODIFIED, OR DISCONTINUED ITEMS NOT SUBJECT TO RETURN.

Damaged Merchandise:

ICC Regulations require that claims for damaged merchandise must be made with the carrier within fifteen (15) days of receipt of merchandise. **DO NOT ACCEPT DAMAGED SHIPMENTS UNLESS SUCH DAMAGE IS NOTED ON THE DELIVERY RECEIPT AT THE TIME OF RECEIPT.** Upon prompt notification, Stryker will file a freight claim with the appropriate carrier for damages incurred. Claim will be limited in amount to the actual replacement cost. In the event that this information is not received by Stryker within the fifteen (15) day period following the delivery of the merchandise, or the damage was not noted on the delivery receipt at the time of receipt, the customer will be responsible for payment of the original invoice in full.

Claims for any short shipment must be made within thirty (30) days of invoice.

International Warranty Clause:

This warranty reflects U.S. domestic policy. Warranty outside the U.S. may vary by country. Please contact your local Stryker Medical representative for additional information.

Safety Precautions

The following is a list of safety precautions that must be observed when operating the Defibrillator Platform. The precautions are repeated throughout the manual, where applicable. Carefully read this list before using the unit.



WARNING

- To avoid equipment damage and/or patient injury, the Defibrillator Platform must be mounted and secured properly to the Rugged cot,
 - To avoid equipment damage and/or patient injury, the defibrillator must be secured properly to the Defibrillator Platform with the straps provided.
 - The weight placed on the Defibrillator Platform must not exceed 75 pounds or equipment damage and patient injury could result.
 - Due to the difference in sizes and shapes of available defibrillators, it may be necessary to change the location and adjustment of the straps securing the defibrillator to the Defibrillator Platform. All straps must always be used and adjusted properly to ensure the security of the defibrillator and avoid patient injury or equipment damage.
-

Preventative Maintenance

CLEANING

1. Hand wash all surfaces of the Defibrillator Platform with warm water and mild detergent. Dry thoroughly.

NOTE

Quaternary Germicidal Disinfectants, used as directed, and/or Chlorine Bleach products, typically 5.25% Sodium Hypochlorite in dilutions ranging between 1 part bleach to 100 parts water, and 2 parts bleach to 100 parts water are not considered mild detergents. These products are corrosive in nature and may cause damage to your Defibrillator Platform if used improperly. If these types of products are used to clean Stryker equipment, measures must be taken to insure the Equipment is rinsed with clean water and thoroughly dried following cleaning. Failure to properly rinse and dry the equipment will leave a corrosive residue on the surface of the equipment, possibly causing premature corrosion of critical components. Failure to follow the above directions when using these types of cleaners may void this product's warranty.

CHECKLIST

- _____ All fasteners secure (reference assembly prints)
- _____ Platform straps intact – not frayed or torn
- _____ Both latch hooks intact and secure

Completed By: _____ Date: _____

Parts, Service or Technical Assistance:

Contact Stryker Customer Service at 1-800-784-4336 or

Stryker Medical
6300 Sprinkle Road
Kalamazoo, MI 49001
ATTN: Customer Service

Operating the **RUGGED**™ Defibrillator Platform

1.

Defibrillator Platform in the stored position.

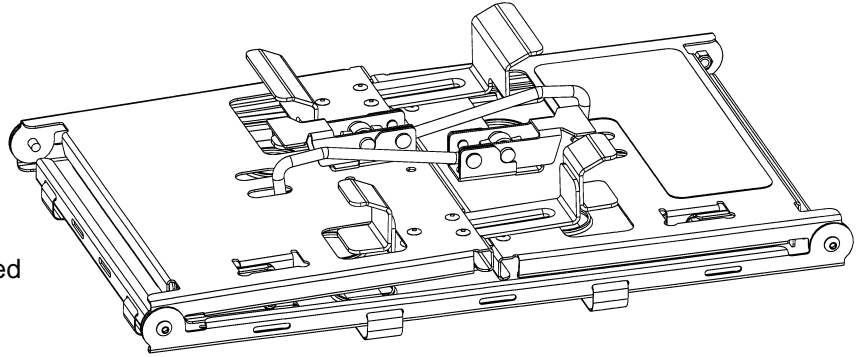

2.

Unlatch and open both legs of the Defibrillator Platform.

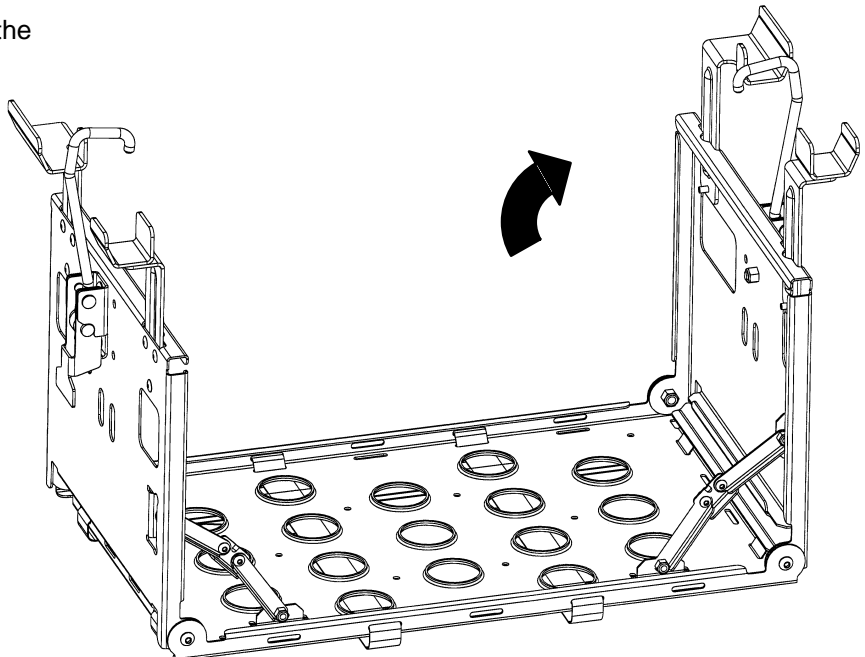
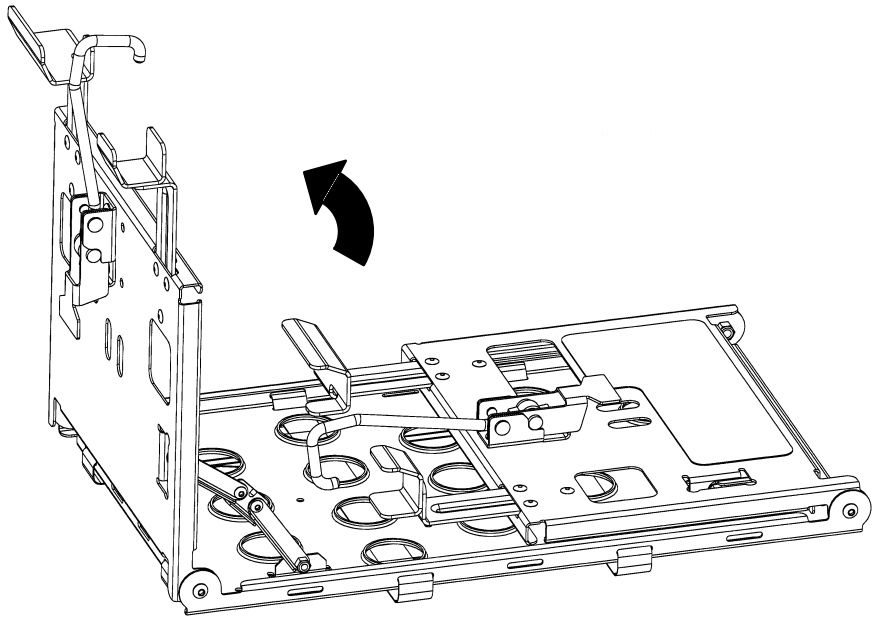

Operating the **RUGGED™** Defibrillator Platform

3.

Turn over the Defibrillator Platform.

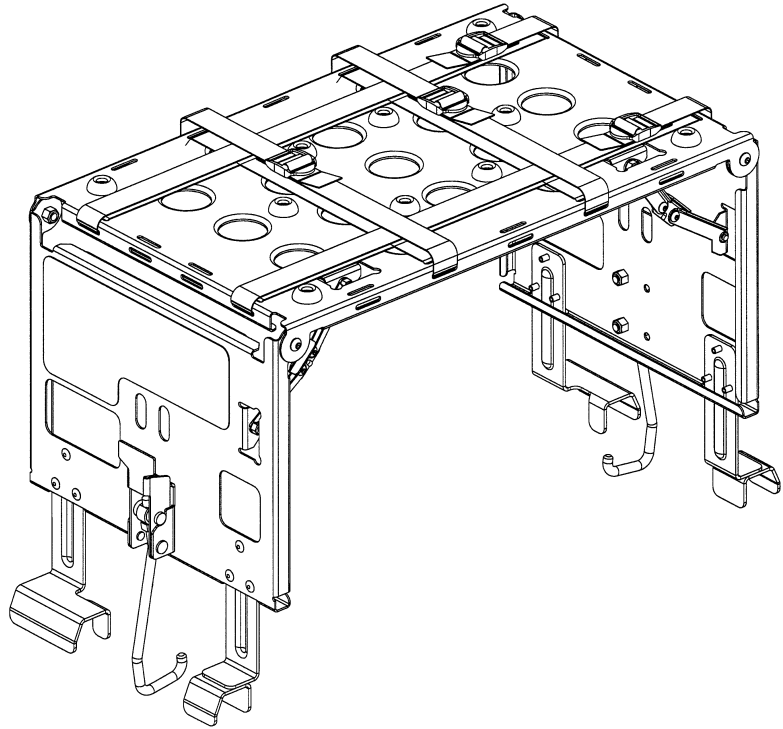

4.

Lift the I.V. pole if the cot is equipped with one.
Place the Defibrillator Platform on the cot frame.

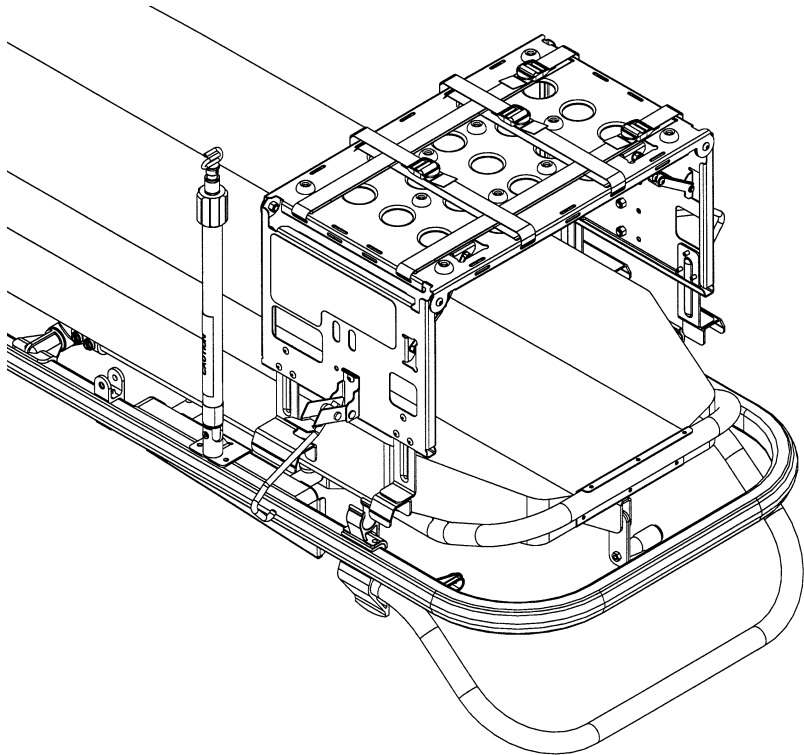

Operating the **RUGGED™** Defibrillator Platform

5.

Place the latch hook (A) under the cot litter frame and push the tab (B) up until it stops. Repeat on the other side of the Defibrillator Platform. Lock the hinge latches (C) on both sides of the platform by pressing the tab downward.

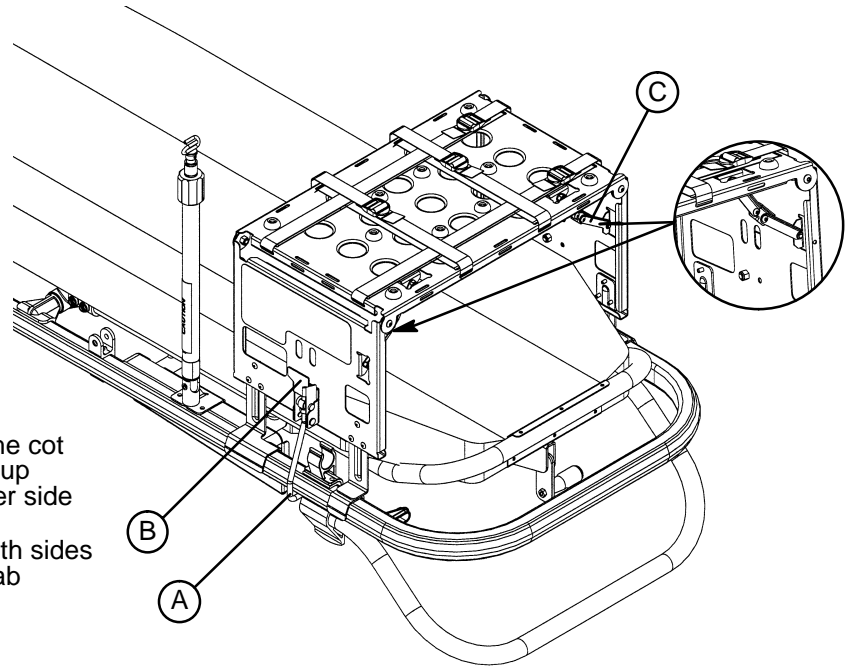

WARNING:

To avoid equipment damage and/or patient injury, the Defibrillator Platform must be mounted and secured properly to the Rugged cot.

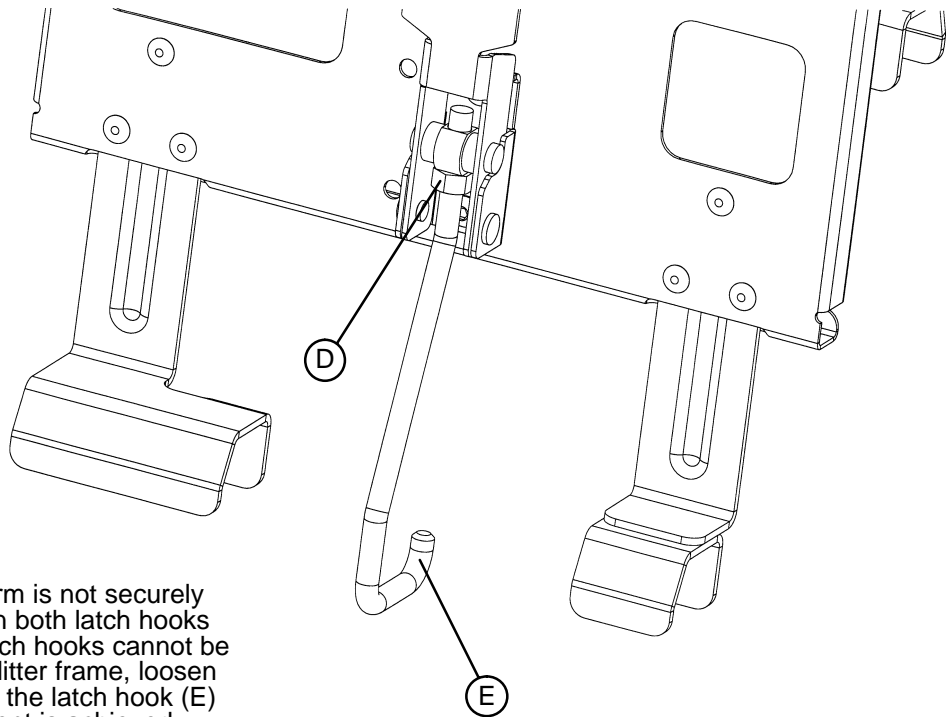

NOTE

If the Defibrillator Platform is not securely attached to the cot when both latch hooks are engaged or if the latch hooks cannot be secured around the cot litter frame, loosen the jam nut (D) and turn the latch hook (E) until the proper adjustment is achieved. Tighten the jam nut (D) securely.

6.

Ensure the Defibrillator Platform is properly secured to the cot. Place the defibrillator on the Defibrillator Platform and secure it with the straps.



WARNING:

To avoid equipment damage and/or patient injury, the defibrillator must be secured properly to the Defibrillator Platform with the straps provided.

Due to the difference in sizes and shapes of available defibrillators, it may be necessary to change the location and adjustment of the straps securing the defibrillator to the Defibrillator Platform. All straps must always be used and adjusted properly to ensure the security of the defibrillator and avoid patient injury or equipment damage.

The weight placed on the Defibrillator Platform must not exceed 75 pounds or equipment damage and patient injury could result.

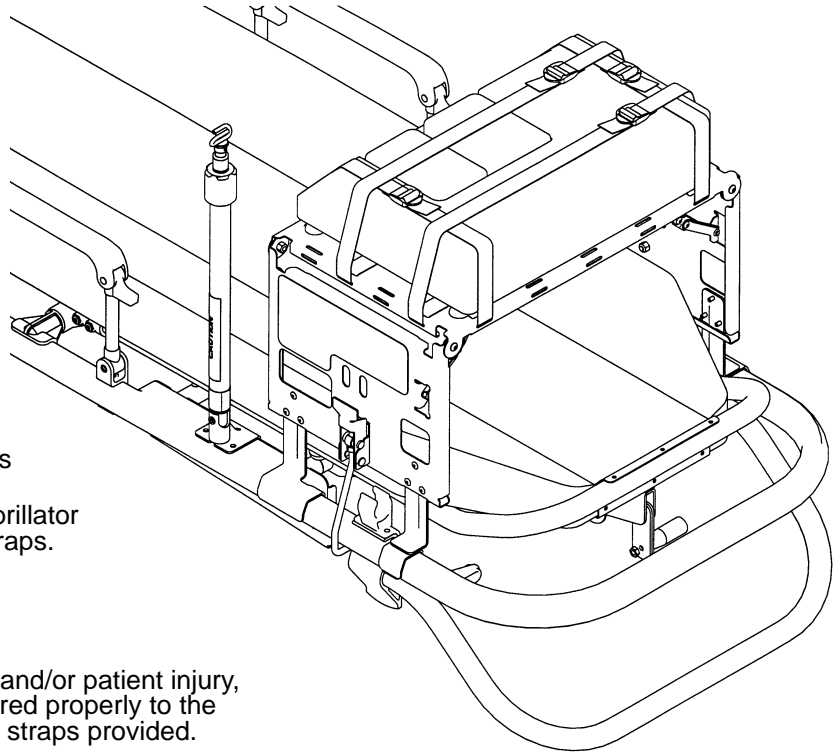

Defibrillator Platform Assembly

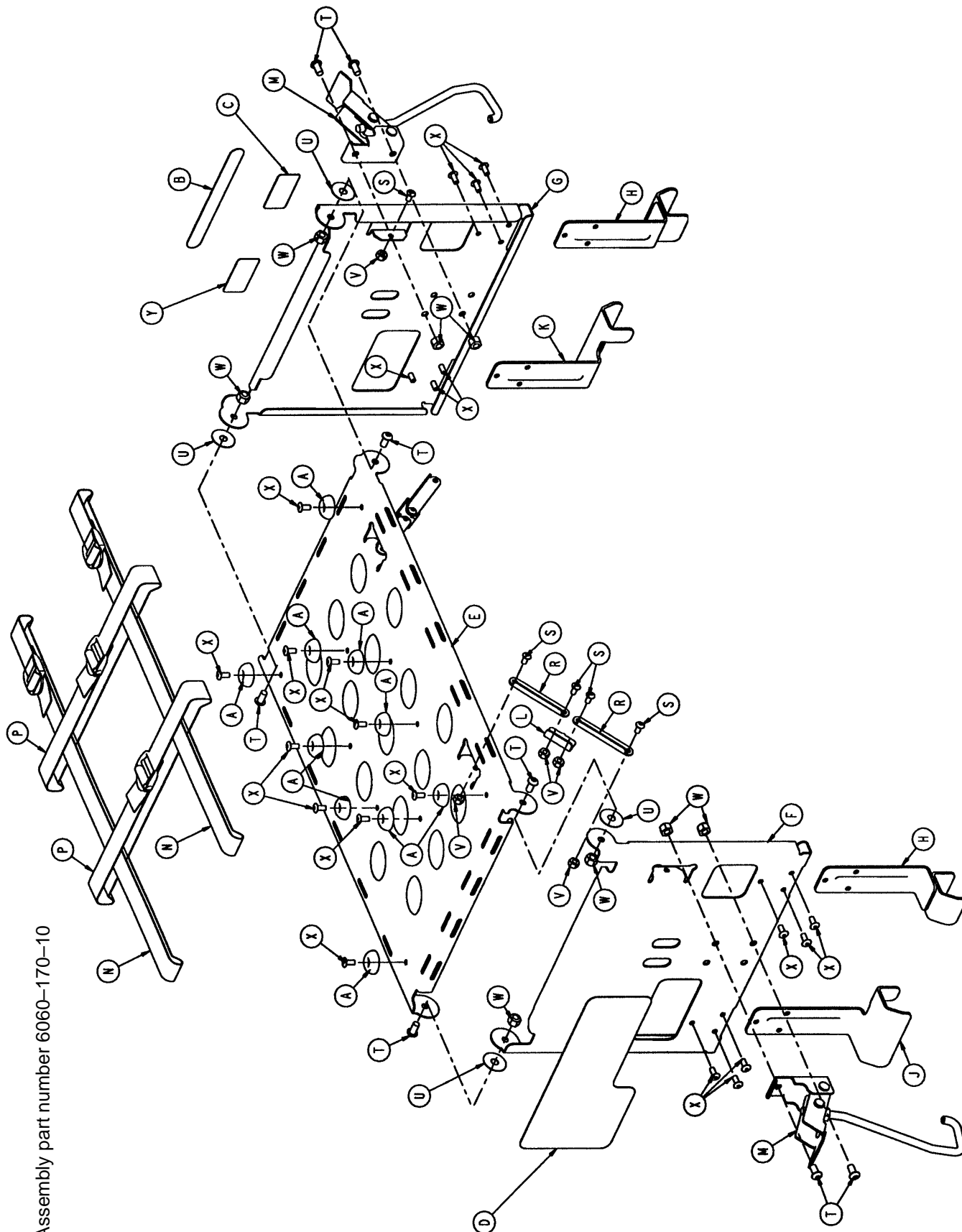

Assembly part number 6060-170-10

Defibrillator Platform Assembly

Assembly part number 6060-170-10

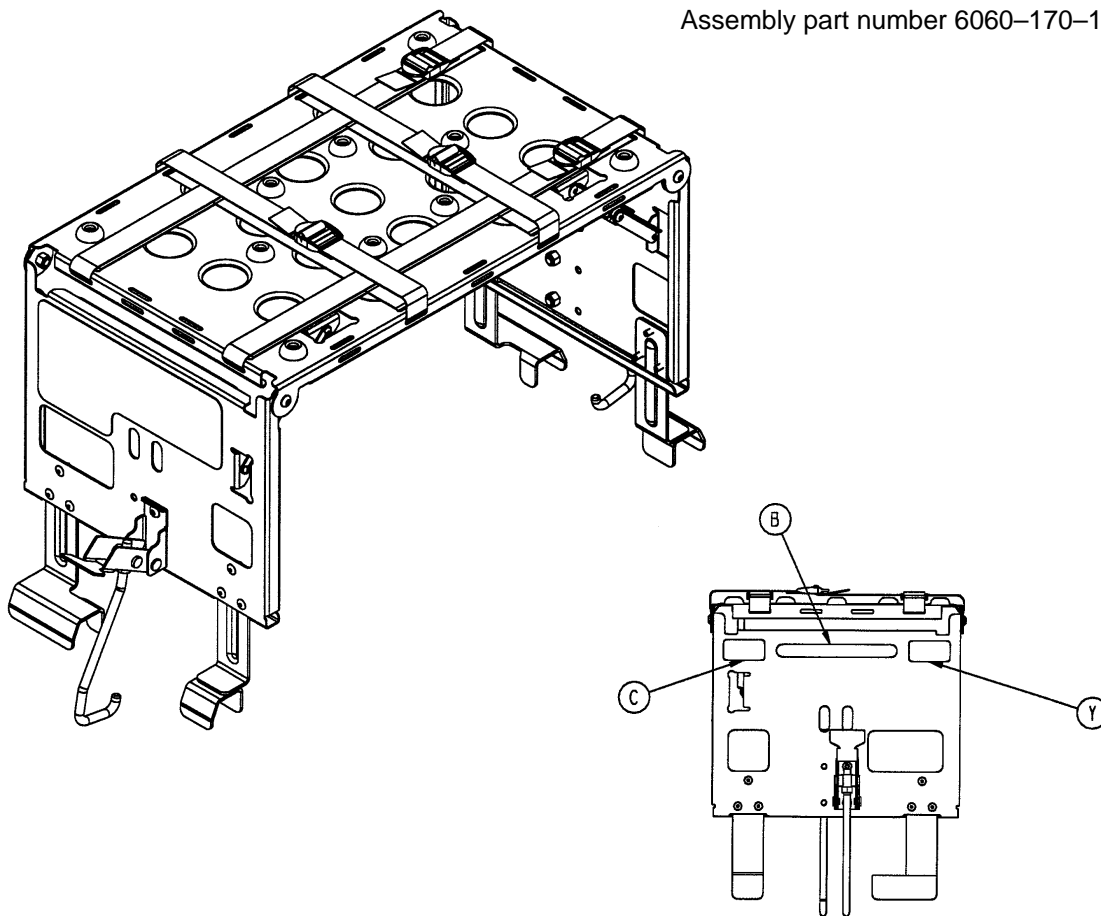

Item	Part No.	Part Name	Qty.
A	946-1-155	Rubber Bumper	10
B	6060-90-4	"Rugged" Label	1
C	6060-90-24	Specification Label	1
D	6060-90-26	Warning and Instruction Label	1
E	6060-170-11	Top Panel	1
F	6060-170-12	Side Panel, Right	1
G	6060-170-13	Side Panel, Left	1
H	6060-170-15	U-Bracket Weldment	2
J	6060-170-16	Guide Bracket, Right	1
K	6060-170-17	Guide Bracket, Left	1
L	6060-170-18	Keeper Bracket	2
M	(page 12)	Latch Assembly	2
N	6060-170-22	Long Strap	2
P	6060-170-23	Short Strap	2
R	6060-170-26	Link	4
S	4-263	Hex Soc. But. Hd. Cap Screw	8
T	4-232	Hex Soc. But. Hd. Cap Screw	8
U	14-19	Nylon Washer	4
V	16-3	Fiberlock Nut	8
W	16-28	Nylock Nut	8
X	25-79	Dome Head Rivet	22
Y	6060-90-27	Weight Limit Label	1

Defibrillator Platform Latch Assembly

Assembly part number 6060-170-20

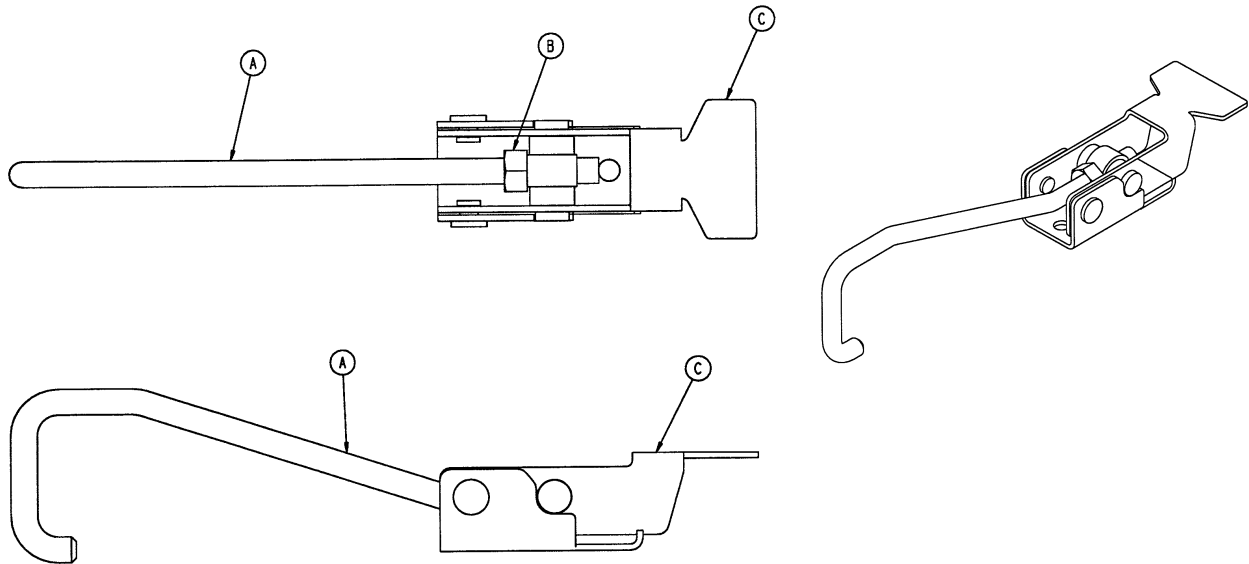

Item	Part No.	Part Name	Qty.
A	6060-170-21	Latch Hook	1
B	16-33	Hex Nut	1
C	6060-170-24	Adjustable Latch	1



European Representative

Stryker France
BP 50040–95946 Roissy Ch. de Gaulle
Cedex–France

Phone: 33148632290
Fax: 33148632175

stryker[®]
Medical

6300 Sprinkle Road, Kalamazoo, MI 49001–9799

(800) 327–0770



DH 3/99 6060–170–9 REV A