

Symmetry® II
Sleeper Chair Seating
Model 3500

stryker®

Operations/Maintenance Manual



[3500-000-610](#)



[3500-000-630](#)



[3500-000-650](#)

For parts or technical assistance call:
(800) 327-0770 (option 2)



Table of Contents

3500-000-650 Recliner Bed	4
Recliner Bed Parts List	5
3500-000-610 Sleeper Chair.	6
Optional Upholstered Arm View	6
Optional Wood Arm Cap View	6
Sleeper Chair Parts List	7
3500-000-630 Loveseat Sleeper.	8
Optional Upholstered Arm View	8
Optional Wood Arm Cap View	8
Loveseat Sleeper Parts List	9
Warranty	10
Limited Lifetime Warranty.	10
One-Year Warranty	10
Service Contract Coverage	11
Service Contract Programs	11
To Obtain Parts and Service	12
Return Authorization.	12
Damaged Merchandise	12
International Warranty Clause.	12

3500-000-650 Recliner Bed

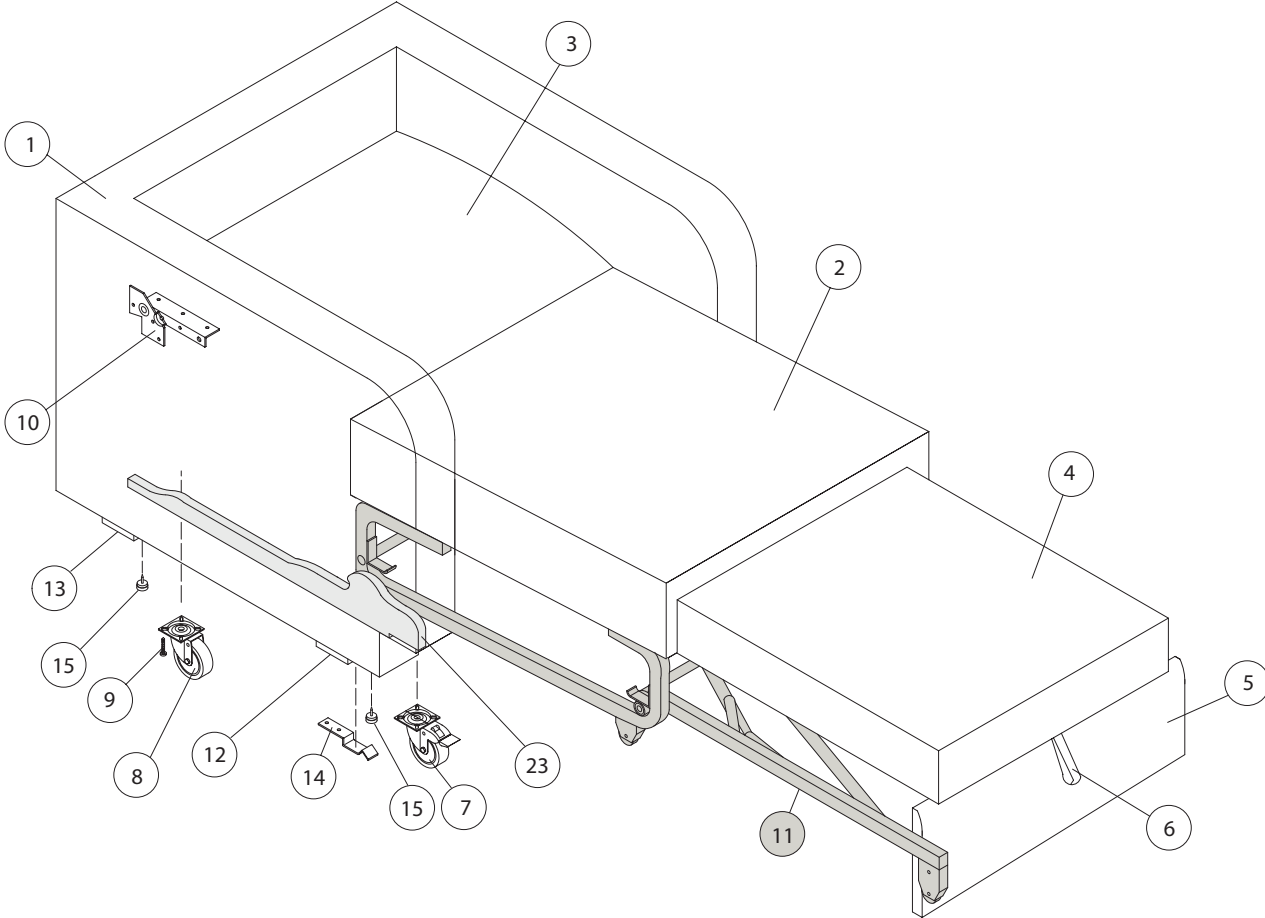

3500-000-650 Recliner Bed

RECLINER BED PARTS LIST

Item	Stryker P/N	Part Description	Qty.
1	<i>(not serviceable)</i>	Arm Frame / Body Upholstered	1
* 2	3500-100-088	Seat Frame Upholstered	1
* 3	3500-100-051	Headrest Upholstered w/Hinge	1
* 4	3500-100-052	Ottoman Frame Upholstered w/Pull Strap	1
* 5	3500-100-053	Footboard Upholstered	1
6	<i>(not serviceable)</i>	Ottoman Pull Strap (Included with item 4)	1
7	3500-100-054	Front Rigid Locking Casters	2
8	3500-100-055	Rear Swivel Casters	2
9	3500-100-056	1/4"-20 x 1 TRS QD MS BLK HP	16
10	<i>(not serviceable)</i>	Back Hinge (Pair) KP 11-17 (Included with item 3)	2
* 11	3500-100-150	Lusch Mechanism	1
* 12	3500-100-085	Front Cross Bar	1
* 13	3500-100-086	Rear Cross Bar	1
14	<i>(not serviceable)</i>	Caster Holding Device LF 01-92 (Included with item 11)	2
15	3500-100-087	Nail Glide	4
16	3500-100-075	1/4"-20 x 2-3/8" QT TRS SR MS BLK	4
17	3500-100-079	1/4"-20 x 7/8" TRS QD MS BLK SR HP	8
18	3500-100-080	1/4"-20 x 1-1/4" Flat Quad MS Zinc	4
19	3500-100-081	1/4"-20 x 1-1/2" Truss Comb	8
20	3500-100-082	1/4"-20 x 1-3/4" TRS QD SR BK	2
21	3500-100-083	#12 x 2" Pan Quad TS Zinc	4
22	3500-100-084	#10-24 x 3/4" Pan HD Zinc	4
23	3500-100-089	Track Rail (Left and Right)	1 set

* When ordering the selected items from the part list above, order the hardware as referenced below:

- For **item 5**: order quantity 4 of item 17 for attachment.
- For **item 4**: order quantity 4 of item 17 for attachment.
- For **item 2**: order quantity 4 of item 16 for attachment.
- For **item 12**: order quantity 4 of item 19 for attachment.
- For **item 13**: order quantity 4 of item 19 for attachment.
- For **item 3**: order quantity 4 of item 18 for attachment.
- For **item 11**: order quantity 2 of item 20, quantity 4 of item 21, and quantity 4 of item 22 for attachment.

[Return To Table of Contents](#)

3500-000-610 Sleeper Chair

OPTIONAL UPHOLSTERED ARM VIEW

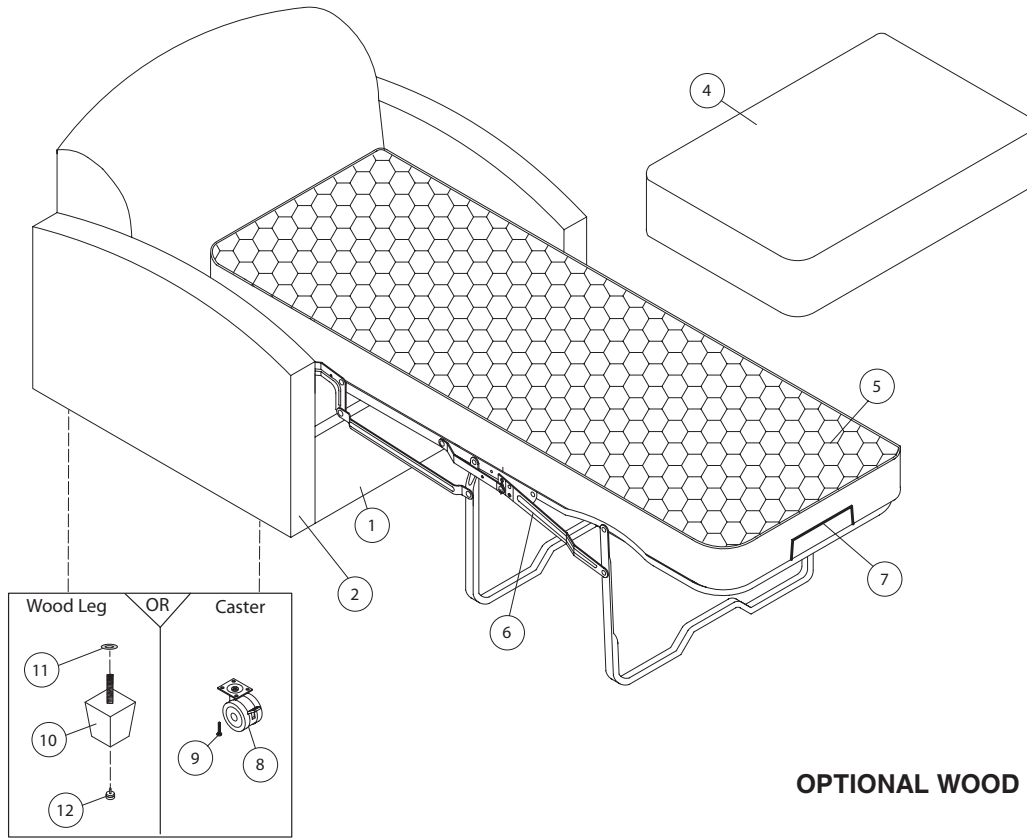

OPTIONAL WOOD ARM CAP VIEW

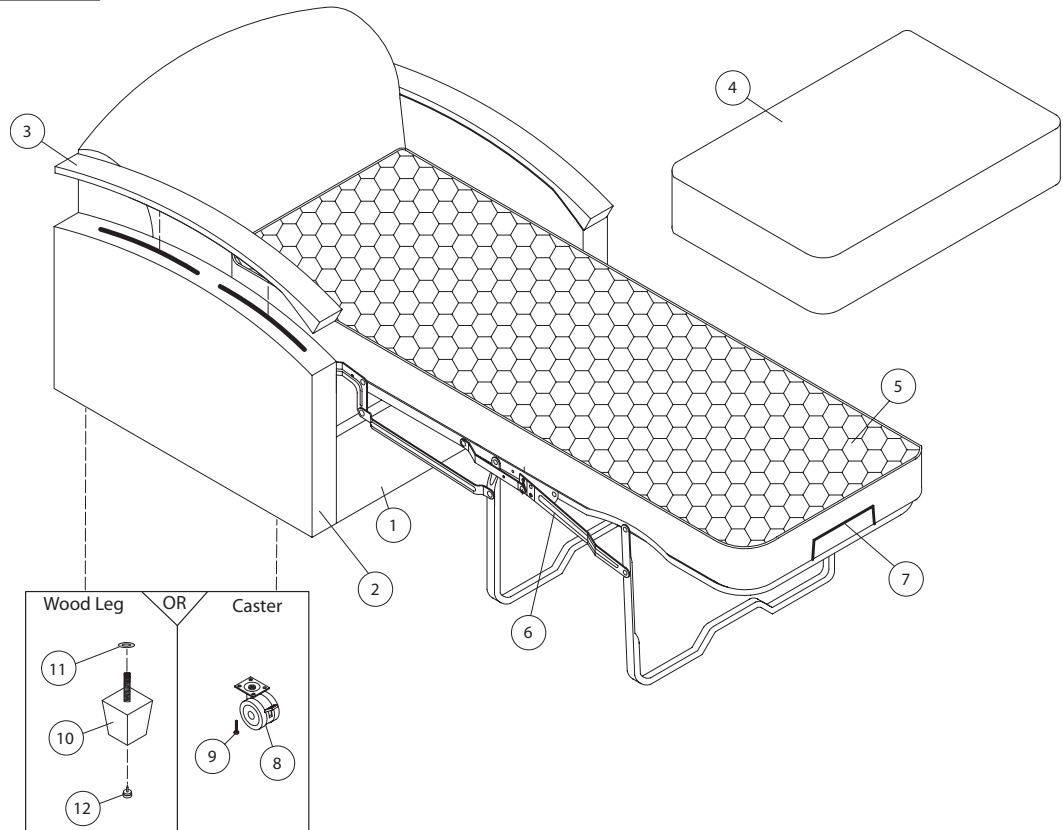

[Return To Table of Contents](#)

3500-000-610 Sleeper Chair

SLEEPER CHAIR PARTS LIST

Item	Stryker P/N	Part Description	Qty.
1	<i>(not serviceable)</i>	Body Upholstered	1
* 2	3500-100-058	Arms Upholstered, Patient Right, w/Wood Arm Cap	1
	3500-100-059	Arms Upholstered, Patient Left, w/Wood Arm Cap	1
	3500-100-060	Arms Upholstered, Patient Right	1
	3500-100-061	Arms Upholstered, Patient Left	1
3	3500-100-062	Top Arm Finished	2
4	3500-100-063	Seat Cushions Upholstered	1
5	3500-100-064	CAL 129 Inner Spring Mattress	1
* 6	3500-100-065	Classic Sleeper Mechanism - 240968-3548-16D	1
7	3500-100-066	Mattress Retainer - 340849	1
8	3500-100-067	Softech Twin Wheels 3" Locking Casters - SF75116	4
9	3500-100-056	1/4"-20 x 1" TRS QD MS SR BLK HD	24
10	3500-100-068	Wood Leg Finished	4
11	3500-100-069	5/16" ID x 1-1/8" OD x 14 GA Zinc	4
12	3500-100-070	1-1/2" DIA Nail Glide	4
13	3500-100-075	1/4"-20 x 2-3/8" QD TRS SR MS BLK	6
14	3500-100-076	5/16" ID x 3/4" OD x 1/16" THK WSHR Zinc	6
15	3500-100-077	1/4"-20 x 1-1/4" TRS QD SR BK HP	2
16	3500-100-078	#14 x 1" Pan Quad Screw BLK	2

* When ordering the selected items from the part list above, order the hardware as referenced below:

- For **each item 2**: order quantity 3 of item 13 and quantity 3 of item 14 for attachment.
- For **item 6**: order quantity 2 of item 15, quantity 2 of item 16, and quantity 8 of item 9 for attachment.

3500-000-630 Loveseat Sleeper

OPTIONAL UPHOLSTERED ARM VIEW

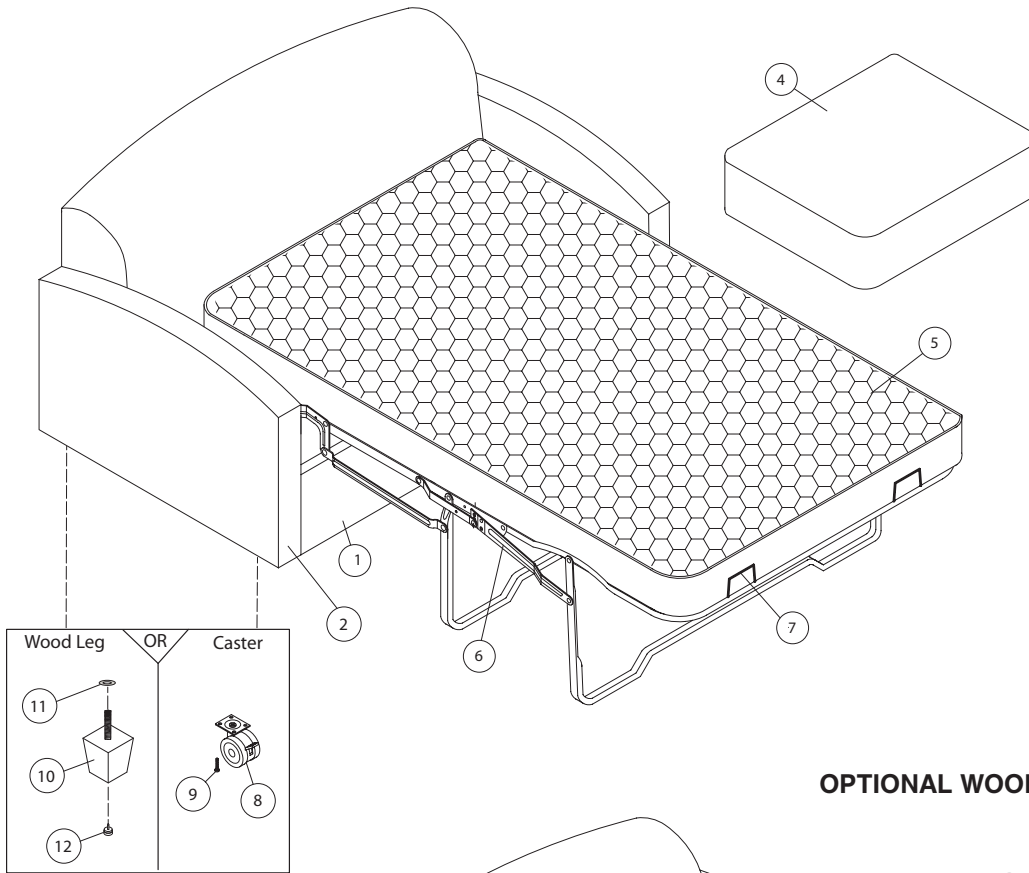

OPTIONAL WOOD ARM CAP VIEW

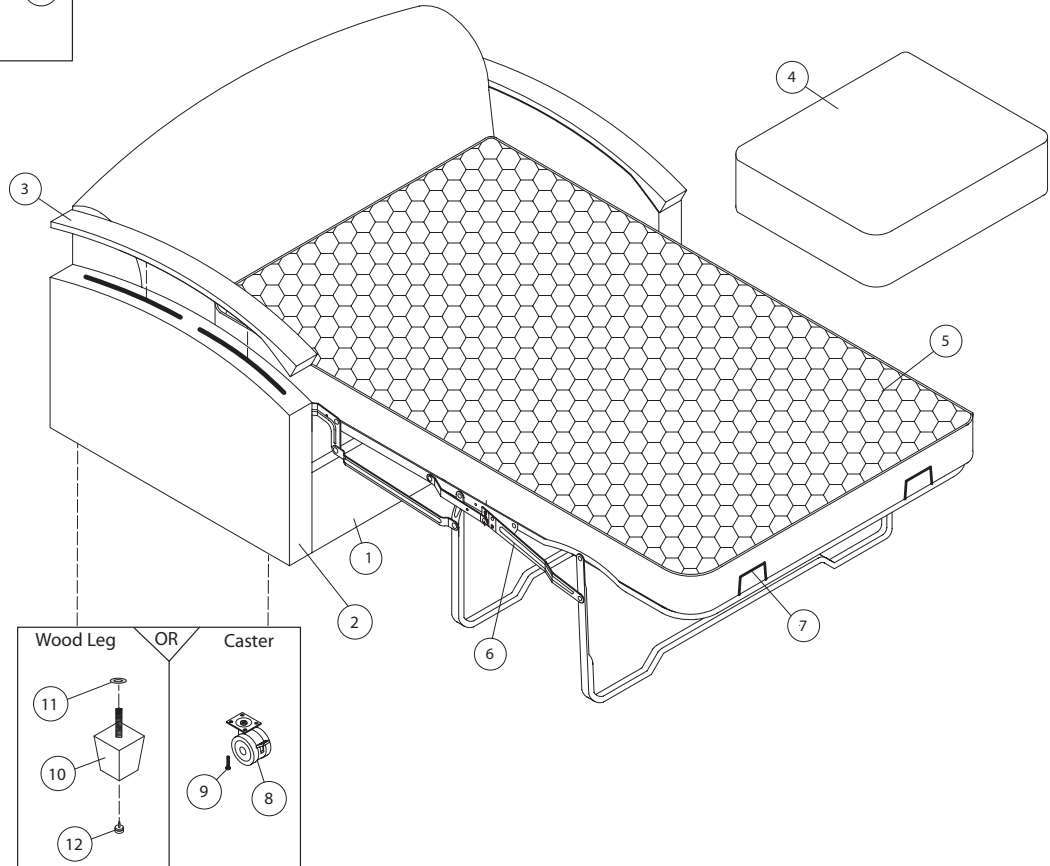

[Return To Table of Contents](#)

3500-000-630 Loveseat Sleeper

LOVESEAT SLEEPER PARTS LIST

Item	Stryker P/N	Part Description	Qty.
1	<i>(not serviceable)</i>	Body Upholstered	1
* 2	3500-100-058	Arms Upholstered, Patient Right, w/Wood Arm Cap	1
	3500-100-059	Arms Upholstered, Patient Left, w/Wood Arm Cap	1
	3500-100-060	Arms Upholstered, Patient Right	1
	3500-100-061	Arms Upholstered, Patient Left	1
3	3500-100-062	Top Arm Finished	2
4	3500-100-071	Seat Cushions Upholstered	2
5	3500-100-072	CAL 129 Inner Spring Mattress	1
* 6	3500-100-073	Classic Sleeper Mechanism - 240968-3548-16D	1
7	3500-100-074	Mattress Retainer - 340849	2
8	3500-100-067	Softech Twin Wheels 3" Locking Casters - SF75116	4
9	3500-100-056	1/4"-20 x 1" TRS QD MS SR BLK HD	24
10	3500-100-068	Wood Leg Finished	4
11	3500-100-069	5/16" ID x 1-1/8" OD x 14 GA Zinc	4
12	3500-100-070	1-1/2" DIA Nail Glide	4
13	3500-100-075	1/4"-20 x 2-3/8" QD TRS SR MS BLK	6
14	3500-100-076	5/16" ID x 3/4" OD x 1/16" THK WSHR Zinc	6
15	3500-100-077	1/4"-20 x 1-1/4" TRS QD SR BK HP	2
16	3500-100-078	#14 x 1" Pan Quad Screw BLK	2

* When ordering the selected items from the part list above, order the hardware as referenced below:

- For **each item 2**: order quantity 3 of item 13 and quantity 3 of item 14 for attachment.
- For **item 6**: order quantity 2 of item 15, quantity 2 of item 16, and quantity 8 of item 9 for attachment.

[Return To Table of Contents](#)

Warranty

Stryker Medical stands behind the craftsmanship of our products. Providing our customers quality products is our mission, and we pledge to do everything we can to quickly resolve any problems encountered within the terms of the warranties listed below. These warranties apply only to products manufactured after January 1, 2008.

LIMITED LIFETIME WARRANTY

Stryker Medical warrants our Symmetry® II and Symmetry® PLUS seating line for the lifetime of the product, classified as 10 years, under normal use and proper care. Subject to the limitations set below, Stryker will repair or, at our option, replace defective merchandise free of charge.

Symmetry® PLUS Recliners

- 10 years on casters, metal arms, metal bases, metal frames, glass-reinforced nylon bases and plastic-engineered components.
- 10 years on metal reclining mechanism (first 5 years—parts, labor and shipping; after 5 years to 10 years—parts only).
- 5 years on seat springs, wood frame components, wood arms and wood bases.
- 3 years on Stryker Medical textiles and foam.

Symmetry® II Patient & Guest Seating

- 10 years on wood.
- 5 years on steel components.
- 3 years on Stryker Medical textiles.
- 3 years on foam.

Symmetry® II Sleepers

- 10 years on wood.
- 5 years on mechanism.
- 3 years on casters, seat springs, mattress and Stryker Medical textiles.
- 3 years on foam.

ONE YEAR WARRANTY

Stryker warrants the following products for one year under normal use and proper care. For one year from date of shipment, Stryker will repair or, at our option, replace defective merchandise free of charge (parts, labor and shipping included).

- Tru-Fit® Overbed Tables.
- Bedside Stands (*Note: LIFETIME WARRANTY on metal drawer frames and glides).
- Maternity Furniture.
- Flexsteel Hospital Recliner.

The Limited Lifetime and One Year warranties listed above are void in cases of modifications, misuse, improper assembly or maintenance, accidents, damage caused by a carrier other than Stryker Medical, and the use of customer's own material.

Stryker makes no other warranty or representation, either expressed or implied, except as set forth herein. There is no warranty of merchantability and there are no warranties of fitness for any particular purpose. In no event shall Stryker be liable hereunder for incidental or consequential damages arising from or in any manner related to sales or use of any such equipment.

Warranty

SERVICE CONTRACT COVERAGE

Stryker has developed a comprehensive program of service contract options designed to keep your equipment operating at peak performance at the same time it eliminates unexpected costs. We recommend that these programs be activated before the expiration of the new product warranty to eliminate the potential of additional equipment upgrade charges.

A Service Contract helps to:

- Ensure equipment reliability
- Stabilize maintenance budgets
- Diminish downtime
- Establish documentation for JCAHO
- Increase product life
- Enhance trade-in value
- Address risk management and safety

SERVICE CONTRACT PROGRAMS

Stryker offers the following service contract programs:

Service Agreement Options *	Gold	Silver	Parts	Labor	PM
Annually scheduled preventative maintenance	X				X
All parts	X	X	X		
All labor and travel	X	X		X	
Unlimited emergency service calls	X	X		X	
Priority one contact: two hour phone response	X	X	X	X	
Most repairs completed within 3 days	X	X		X	
JCAHO documentation	X	X		X	X
On-site record of PM & emergency service	X				X
Factory-trained Stryker service technician	X	X		X	X
Stryker authorized parts used	X	X	X	X	X
Service during regular business hours (8-5)	X	X	X	X	X

* Does not include maintenance due to abuse or for any disposable items. Stryker reserves the right to change options without notice.

Stryker Medical also offers personalized service contracts.
Pricing is determined by age, location, model and condition of product.

**For more information on our service contracts,
please call your local representative.**

[Return To Table of Contents](#)

Warranty

TO OBTAIN PARTS AND SERVICE

Stryker products are supported by a nationwide network of dedicated Stryker Field Service Representatives. These representatives are factory trained, available locally, and carry a substantial spare parts inventory to minimize repair time. Simply call your local representative, or call Stryker Customer Service USA at 1-800-327-0770.

RETURN AUTHORIZATION

Merchandise cannot be returned without approval from the Stryker Customer Service Department. An authorization number will be provided which must be printed on the returned merchandise. Stryker reserves the right to charge shipping and restocking fees on returned items. **Special, modified, or discontinued, items not subject to return.**

DAMAGED MERCHANDISE

ICC Regulations require that claims for damaged merchandise must be made with the carrier within fifteen (15) days of receipt of merchandise. **Do not accept damaged shipments unless such damage is noted on the delivery receipt at the time of receipt.** Upon prompt notification, Stryker will file a freight claim with the appropriate carrier for damages incurred. Claim will be limited in amount to the actual replacement cost. In the event that this information is not received by Stryker within the fifteen (15) day period following the delivery of the merchandise, or the damage was not noted on the delivery receipt at the time of receipt, the customer will be responsible for payment of the original invoice in full. Claims for any short shipment must be made within thirty (30) days of invoice.

INTERNATIONAL WARRANTY CLAUSE

This warranty reflects U.S. domestic policy. Warranty outside the U.S. may vary by country. Please contact your local Stryker Medical representative for additional information.

Stryker Medical
3800 E. Centre Ave.,
Portage, Michigan
49002

stryker[®]

Manufactured for Stryker

2008/01

3501-009-001 REV B

www.stryker.com