

Wide Transport Stretcher

Model 738

stryker[®]

Operation Manual



For Parts or Technical Assistance:
USA: 1-800-327-0770 (option 2)
Canada: 1-888-233-6888

CE

Table of Contents

Introduction	4
Intended Use	4
Specifications	4
Warning / Caution / Note Definition	4
Summary of Safety Precautions	6
Operation Guide	7
Operating Base Controls - Side Control	7
Operating Base Controls - 3-Sided Controls	8
Raising and Lowering Litter Height - Side Control	9
Raising and Lowering Litter Height - 3-Sided Controls	9
Trendelenburg / Reverse Trendelenburg - Side Control	9
Trendelenburg / Reverse Trendelenburg - 3-Sided Controls	9
Applying The Brake System	10
Operating The Fifth Wheel	10
Using the Siderails	11
Using the Push Handles	11
Operating the Fowler	12
Operating the Optional 2-Stage Permanently Attached I.V. Pole	13
Operating Optional 3 - Stage Permanently Attached I.V. Pole	14
Operating the Optional Foot Extension / Defibrillator Tray	15
Preventative Maintenance	16
Checklist	16
Cleaning	17
Warranty	18
Limited Warranty	18
To Obtain Parts and Service	18
Service Contract Coverage	18
Service Contract Programs	19
Return Authorization	19
Damaged Merchandise	19
International Warranty Clause	19

Introduction

INTENDED USE

This manual is designed to assist you with the operation of Stryker Model 738 Wide Transport Stretcher. Carefully read this manual thoroughly before using the equipment or beginning maintenance on it. To ensure safe operation of this equipment, it is recommended that methods and procedures be established for educating and training staff on the safe operation of this stretcher.

SPECIFICATIONS

	Safe Working Load		
	Note: Safe Working Load indicates the sum of the patient, mattress, and accessory weight.	500 pounds	227 kilograms
	Overall Stretcher Length \ Width	83" / 34"	211.65 cm / 86.3 cm
	Minimum \ Maximum Bed Height	21.5" / 36"	54.83 cm / 91.8 cm
	Fowler Angle	0° to 90°	
	Trendelenburg \ Reverse Trendelenburg	+18° to -18°	
	Minimum Under Stretcher Clearance	6" (15 cm) nominal 1.75" (4.5 cm) under the hydraulic cylinders and 5 th wheel	

Stryker reserves the right to change specifications without notice.

Specifications listed are approximate and may vary slightly from unit to unit or by power supply fluctuations.

WARNING / CAUTION / NOTE DEFINITION

The words WARNING, CAUTION, and NOTE carry special meanings and should be carefully reviewed.

WARNING

Alerts the reader about a situation, which if not avoided, could result in death or serious injury. It may also describe potential serious adverse reactions and safety hazards.

CAUTION

Alerts the reader of a potentially hazardous situation, which if not avoided, may result in minor or moderate injury to the user or patient or damage to the equipment or other property. This includes special care necessary for the safe and effective use of the device and the care necessary to avoid damage to a device that may occur as a result of use or misuse.

Note

This provides special information to make maintenance easier or important instructions clearer.

Symbols



Consult accompanying documentation



Safe Working Load Symbol

Summary of Safety Precautions

Before operating this stretcher, it is important to read and understand all information in this manual. Carefully read and strictly follow the warnings and cautions listed on this page.

WARNING

- Always apply the caster brakes when a patient is getting on or off the stretcher. Push on the stretcher to ensure the brakes are securely locked. Always engage the brakes unless the stretcher is being moved. Injury could result if the stretcher moves while a patient is getting on or off the stretcher.
- Be sure the siderail latching mechanism is working properly at all times. If it is not, refer to your stretcher maintenance manual for "Siderail Latch Adjustment".
- When lowering the siderail to the collapsed position, keep extremities of patients and staff away from the siderail spindles or injury could occur.
- Keep fingers/hands clear of area around the Fowler release handle and the Fowler frame when lowering. Injury could result if care is not taken when lowering the Fowler.
- If the stretcher is equipped with the optional foot end I.V. pole, the I.V. pole must be in the raised position when the foot extension/defibrillator tray is installed. If the I.V. pole is not raised, the foot extension will not function properly and injury could occur.

CAUTION

- To avoid damage, remove any equipment that may be in the way before raising or lowering the litter height.
- To avoid injury or damage to the equipment, do not allow the siderail to lower on its own.
- The push handles were designed for use while transporting the stretcher. Avoid using other parts of the stretcher as push/pull devices because damage could occur.
- If the Pneumatic Fowler is difficult to operate, refer to the stretcher maintenance manual for "Pneumatic Fowler Adjustment".
- To avoid damage, the weight of the I.V. bags should not exceed 40 pounds (18 kg).
- To avoid damage while transporting the stretcher, verify the I.V. pole is at a low enough height to allow it to safely pass through door openings and under light fixtures.
- The unit cannot be raised (hydraulics on base) with a patient lift under the stretcher.
- The hood may not be used for stepping.

Note

- Clean hood storage area regularly.
- The bottom of the brake rings should be cleaned regularly to prevent wax and/or floor remnant buildup.

Operation Guide

OPERATING BASE CONTROLS - SIDE CONTROL

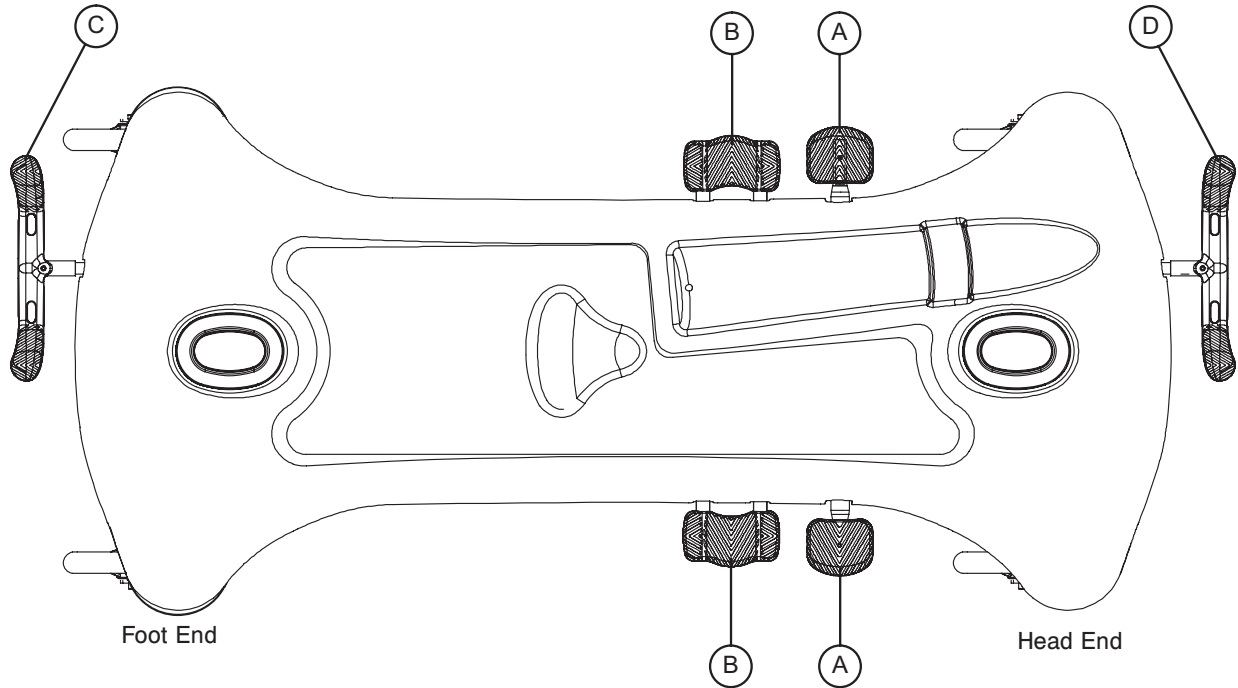

Pump pedal (A) to raise the litter.



Depress in the center of pedal (B) to lower both ends of the stretcher together.

Depress the side of pedal (B) closest to the foot end of the stretcher to lower the foot end.

Depress the side of pedal (B) closest to the head end of the stretcher to lower the head end.

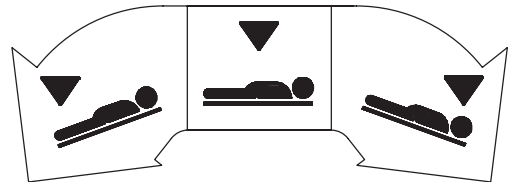

Pedal (C) - Brake and Steer functions (foot end)

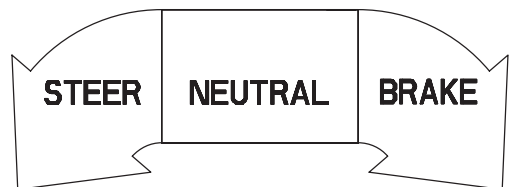

Pedal (D) - Brake and Steer functions (head end)

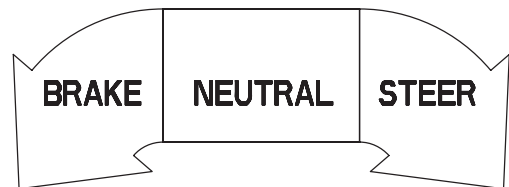

[Return To Table of Contents](#)

Operation Guide

OPERATING BASE CONTROLS - 3-SIDED CONTROLS

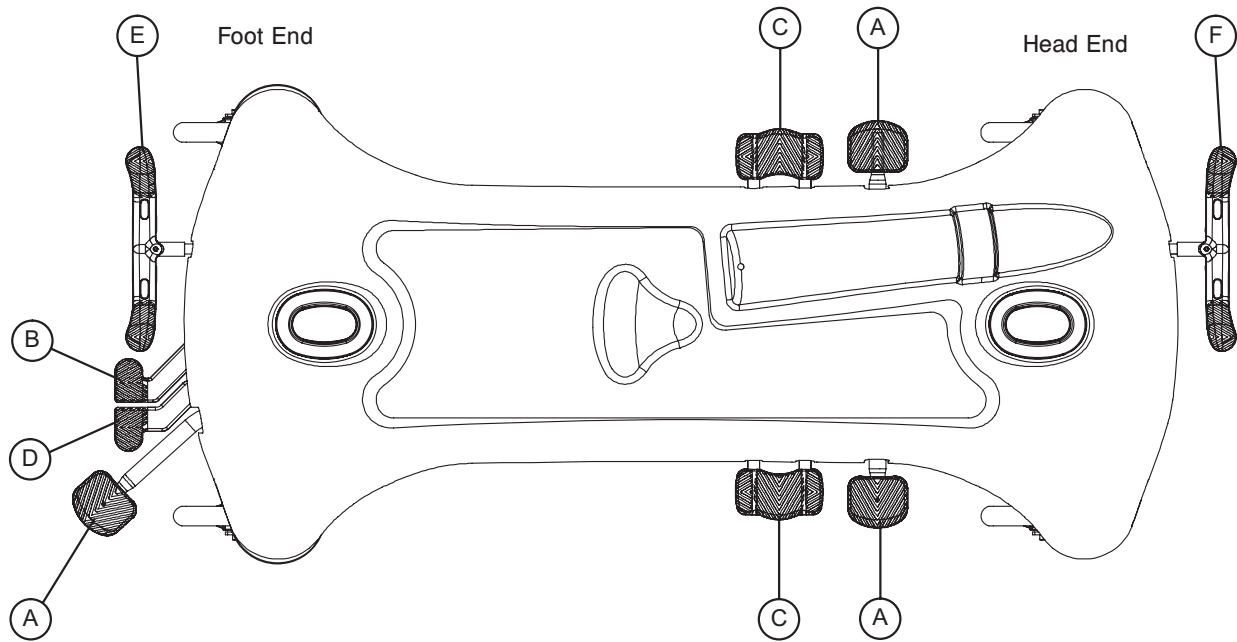

Pump pedal (A) at the foot end or sides of the stretcher to raise the litter



Depress pedal (B) or the side of pedal (C) closest to the head end of the stretcher to lower the head end of the stretcher.

Depress pedal (D) or the side of pedal (C) closest to the foot end of the stretcher to lower the foot end of the stretcher.

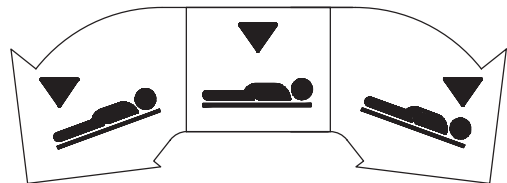

Depress in the center of pedal (C) or depress pedals (B) and (D) to lower both ends of the stretcher together.

Pedal (E) - Brake and Steer functions (foot end).

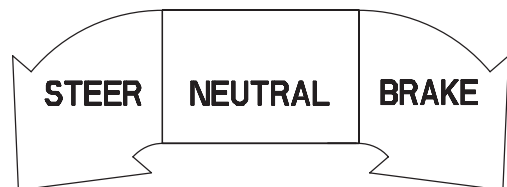

Pedal (F) - Brake and Steer functions (head end).

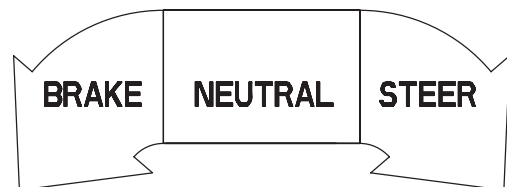

Operation Guide

RAISING AND LOWERING LITTER HEIGHT - SIDE CONTROL

CAUTION

To avoid damage, remove any equipment that may be in the way before raising or lowering the litter height.

To **raise** the litter height, pump pedal (A) repeatedly until the desired height is achieved (see illustration on Operating Base Controls - Side Control section).

To **lower** both ends of the litter together, depress the center of pedal (B). To lower only the head end of the litter, depress the side of pedal (B) closest to the head end. To lower only the foot end of the litter, depress the side of pedal (B) closest to the foot end (see illustration on Operating Base Controls - Side Control section).

RAISING AND LOWERING LITTER HEIGHT - 3-SIDED CONTROLS

To **raise** the litter height, pump pedal (A) repeatedly until the desired height is achieved (see illustration on Operating Base Controls - 3-Sided Controls section).

To **lower** both ends of the litter simultaneously, depress pedal (B) and (D) together using the same foot or depress in the center of pedal (C). To lower only the head end of the litter, depress pedal (B) or the side of pedal (C) closest to the head end of the stretcher. To lower only the foot end of the stretcher, depress pedal (D) or the side of pedal (C) closest to the foot end of the stretcher.

TRENDELENBURG / REVERSE TRENDELENBURG - SIDE CONTROL

Note

Litter height must be raised first in order to achieve a Trendelenburg or reverse Trendelenburg position.

CAUTION

To avoid damage, remove any equipment that may be in the way before lowering the stretcher.

For **Trendelenburg** positioning (head down), depress the side of pedal (B) closest to the head end of the stretcher (see illustration on Operating Base Controls - Side Control section).

For **Reverse Trendelenburg** positioning (foot down), depress the side of pedal (B) closest to the foot end.

Note

The higher the litter is before pedal (B) is activated, the greater the Trendelenburg or reverse Trendelenburg angle will be. (Maximum Trendelenburg angle is +18°. Maximum reverse Trendelenburg angle is -18°).

TRENDELENBURG / REVERSE TRENDELENBURG - 3-SIDED CONTROLS

CAUTION

To avoid damage, remove any equipment that may be in the way before lowering the stretcher.

For **Trendelenburg** positioning (head down), depress pedal (B) or the side of pedal (C) closest to the head end of the stretcher (see illustration on Operating Base Controls - Side Control section).

For **Reverse Trendelenburg** positioning (foot down), depress pedal (D) or the side of pedal (C) closest to the foot end of the stretcher.

[Return To Table of Contents](#)

Operation Guide

APPLYING THE BRAKE SYSTEM

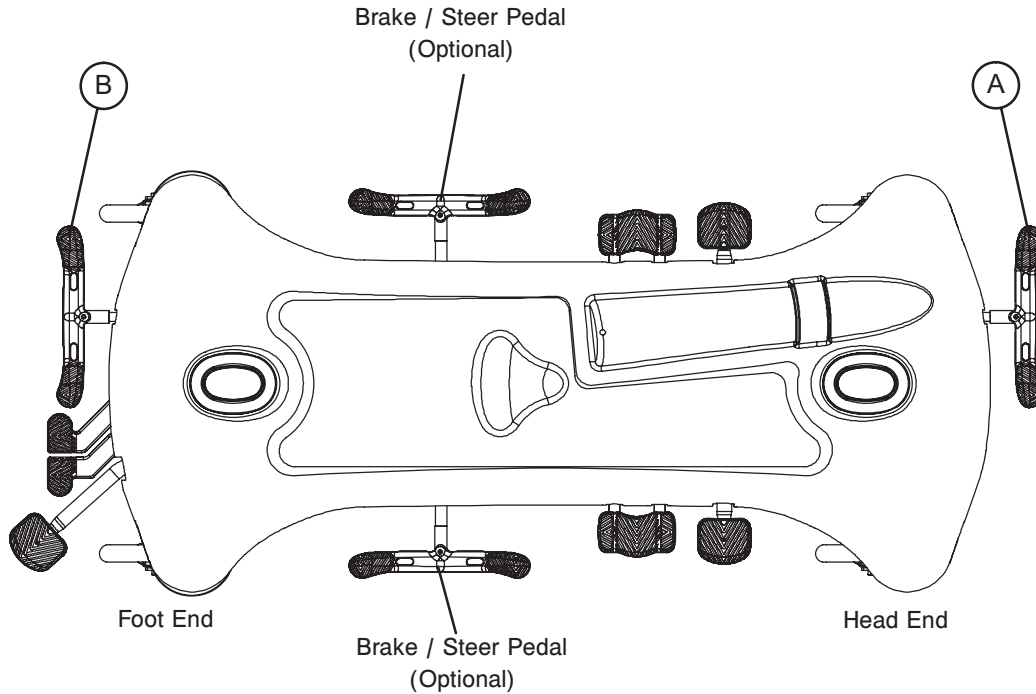

Note

For user convenience, a brake/steer control pedal is located on both ends of the stretcher.

WARNING

- Always apply the caster brakes when a patient is getting on or off the stretcher.
- Push on the stretcher to ensure the brakes are securely locked.
- Always engage the brakes unless the stretcher is being moved.
- Injury could result if the stretcher moves while a patient is getting on or off the stretcher.

To engage the brakes on the head end, push fully down on the left side of pedal (A).

To engage the brakes on the foot end, push fully down on the right side of pedal (B).

Note

Your stretcher may be equipped with optional side control brake and steer functions in addition to the standard head and foot end controls. The side control brakes operate the same as the head and foot end versions.

OPERATING THE FIFTH WHEEL

The purpose of the Fifth Wheel is to help guide the stretcher along a straight line during transport and to help pivot the stretcher around corners.

To engage the fifth wheel, push the proper side of the brake/steer pedal to the full down position.

Operation Guide

USING THE SIDERAILS

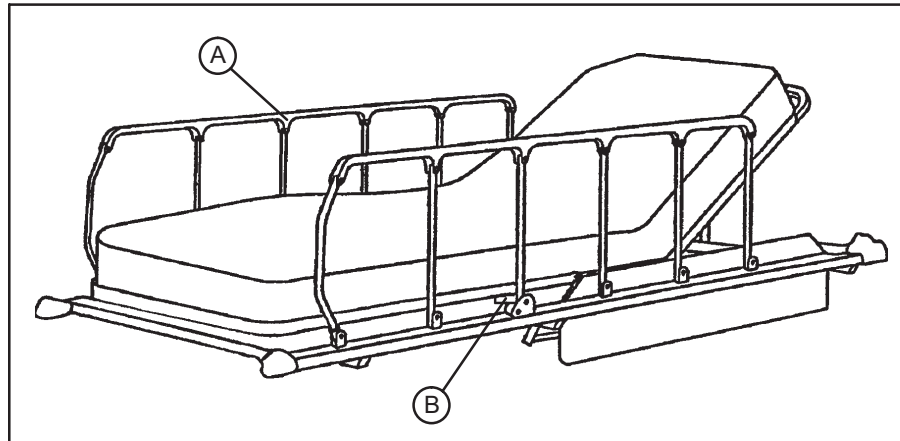

WARNING

Be sure the siderail latching mechanism (B) is working properly at all times. If it is not, refer to your stretcher maintenance manual for "Siderail Latch Adjustment".

To engage siderails: Pull up siderail (A) and raise to full up position so that latch (B) engages.

To disengage siderails: Pull up on latch (B) and guide siderail to the full down position.

WARNING

When lowering the siderail to the collapsed position, keep extremities of patients and staff away from the siderail spindles or injury could occur.

To avoid injury or damage to the equipment, do not allow the siderail to lower on its own.

USING THE PUSH HANDLES

CAUTION

The push handles were designed for use while transporting the stretcher. Avoid using other parts of the stretcher as push/pull devices because damage could occur.

To use the push handles: Pivot the handles up and push down until they are locked into position.

To store the push handles: Lift the handles up and pivot them down to store in the handle rests.

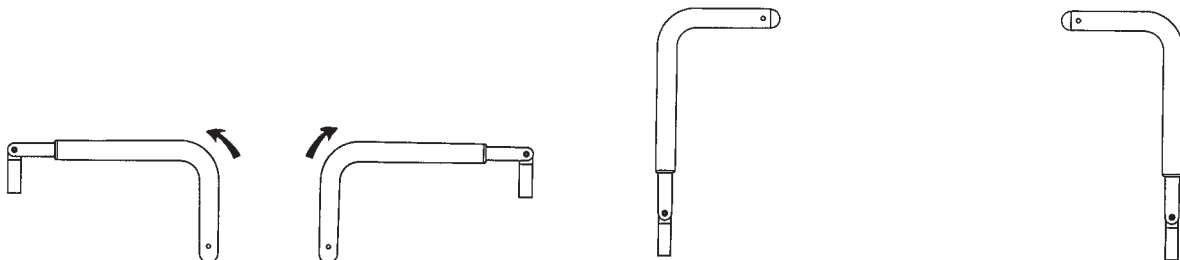

[Return To Table of Contents](#)

Operation Guide

OPERATING THE FOWLER

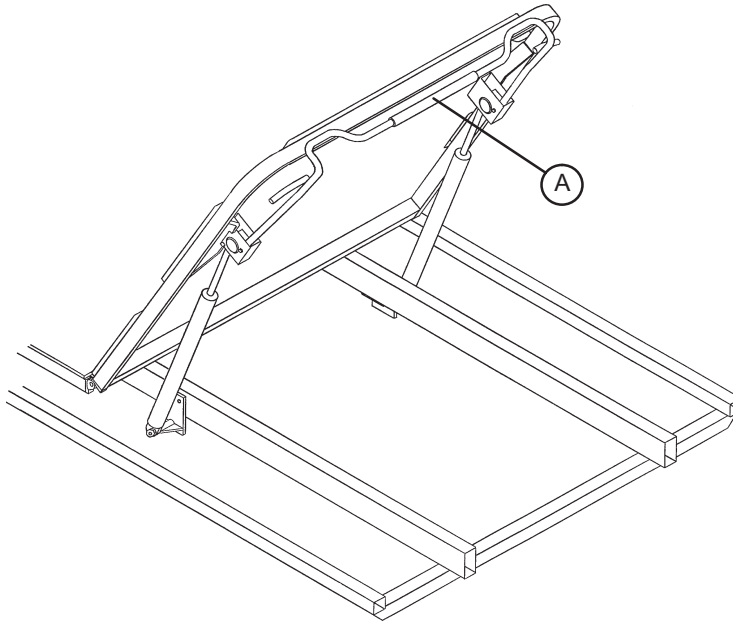

Squeeze handle (A) for pneumatic assistance in lifting the Fowler to the desired height. Remove hand(s) from handle when the desired height is achieved.

To lower the Fowler, squeeze handle (A) and push down until the Fowler has reached the desired height. Remove your hand(s) from the handle when the desired height is achieved.

WARNING

Keep hands/fingers clear of the area around the Fowler release handle and the Fowler frame when lowering the Fowler. Injury could result if care is not taken when lowering the Fowler.

CAUTION

If the pneumatic Fowler is difficult to operate, refer to the stretcher maintenance manual for a pneumatic Fowler adjustment procedure.

Operation Guide

OPERATING THE OPTIONAL 2-STAGE PERMANENTLY ATTACHED I.V. POLE

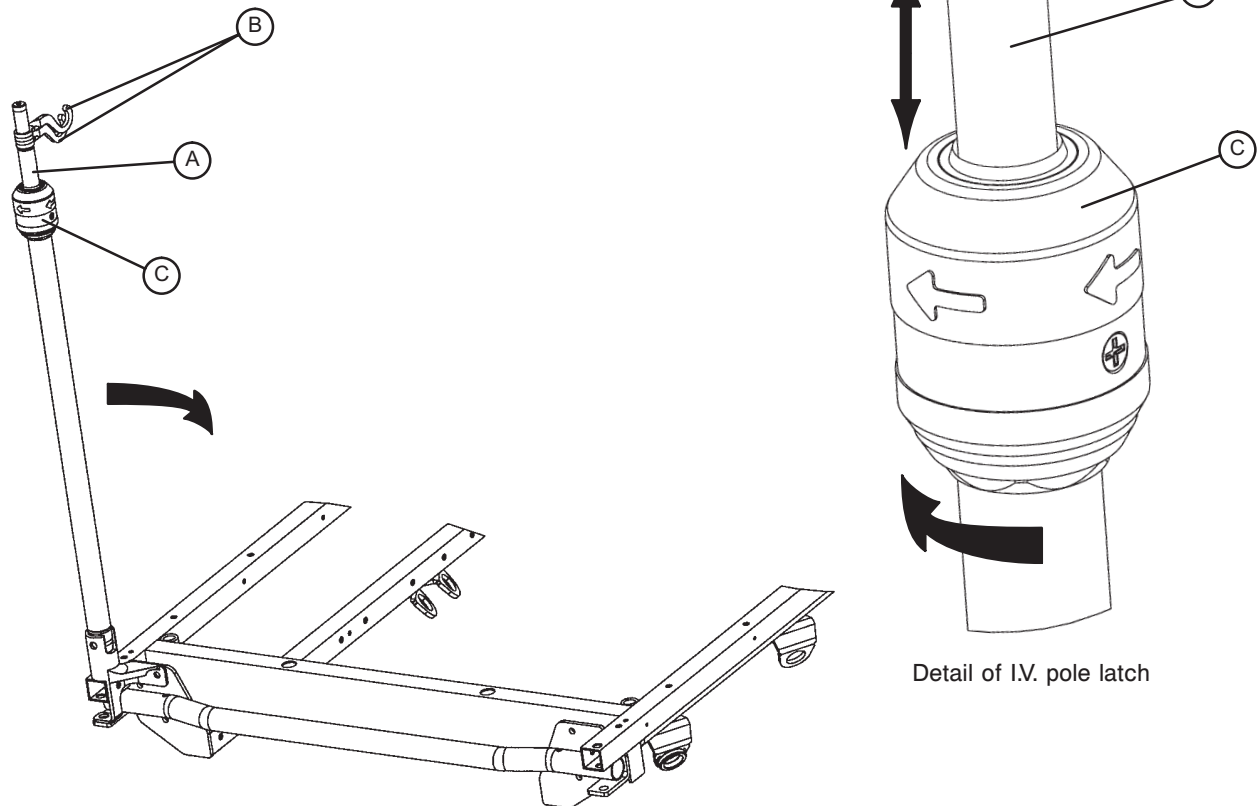

Note

The 2-stage permanently attached I.V. pole is an option and may have been installed at either the head, foot both ends of the stretcher.

To use the 2-stage permanently attached I.V. pole:

1. Lift and pivot the pole from the storage position and push down until it is locked into the receptacle.
2. To raise the height of the pole, pull up on the telescoping portion (A) until it locks into place at its fully raised position.
3. Rotate the I.V. hangers (B) to desired position and hang the I.V. bags.
4. To lower the I.V. pole, turn the latch (C) clockwise until section (A) lowers.

CAUTION

- To avoid damage, the weight of the I.V. bags should not exceed 40 pounds (18 kg).
- To avoid damage while transporting the stretcher, verify the I.V. pole is at a low enough height to allow it to safely pass through door openings and under light fixtures.

[Return To Table of Contents](#)

Operation Guide

OPERATING OPTIONAL 3 - STAGE PERMANENTLY ATTACHED I.V. POLE

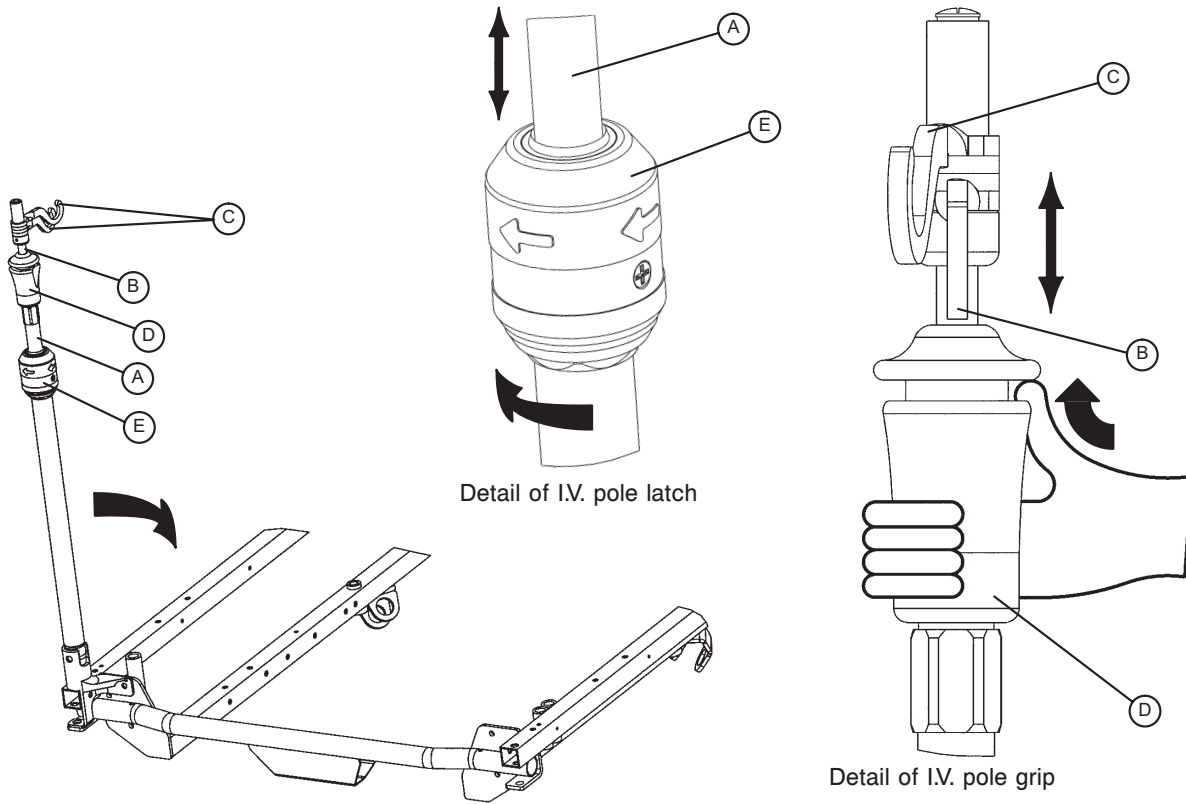

Note

The 3-stage permanently attached I.V. pole is an option and may have been installed at either the head, foot or both ends of the stretcher.

To use the 3-stage permanently attached I.V. pole:

1. Lift and pivot the pole from the storage position and push down until it is locked into the receptacle.
2. To raise the height of the pole, pull up on the telescoping portion (A) until it locks into place at its fully raised position.
3. For a higher I.V. pole, pull up on section (B). Release section (B) at any desired height and it will lock into place.
4. Rotate the I.V. hangers (C) to the desired position and hang the I.V. bags.
5. To lower the I.V. pole, push up on the red portion of grip (D) while holding onto section (B) until it lowers. Turn latch (E) clockwise until section (A) lowers.

CAUTION

- To avoid damage, the weight of the I.V. bags should not exceed 40 pounds (18 kg).
- To avoid damage while transporting the stretcher, verify the I.V. pole is at a low enough height to allow it to safely pass through door openings and under light fixtures.

Operation Guide

OPERATING THE OPTIONAL FOOT EXTENSION / DEFIBRILLATOR TRAY

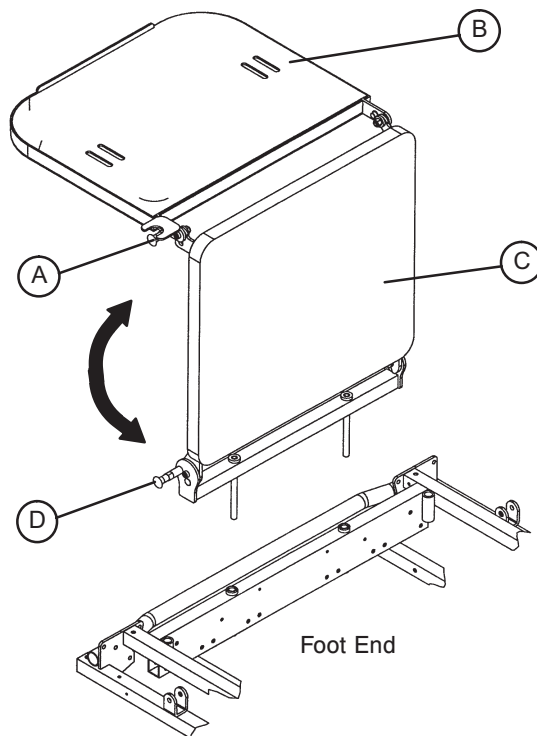

1. To use as a defibrillator tray, pull out the top knob (A) and pivot the tray (B) over the foot extension (C) until the tray extends flat over the foot end of the stretcher.
2. To use as a foot extension, pull out knob (A) and pivot the defibrillator tray back until it locks against the foot extension (C). While holding onto the assembly, pull out the bottom knob (D) and lower the foot extension down until it is flat.

WARNING

- If the stretcher is equipped with the optional foot end I.V. pole, the I.V. pole must be in the raised position when the foot extension/defibrillator tray is installed.
- If the I.V. pole is not raised, the foot extension will not function properly and injury could occur.

Preventative Maintenance

CHECKLIST

- _____ All fasteners secure.
- _____ Siderails move and latch properly.
- _____ Engage the brake pedal and push on the stretcher to ensure all casters lock securely.
- _____ All casters secure and swiveling properly.
- _____ Body restraints working properly.
- _____ I.V. pole intact and operating properly.
- _____ Oxygen bottle holder intact and operating properly.
- _____ Fowler operates and latches properly.
- _____ Trendelenburg/Reverse Trendelenburg operating properly.
- _____ No rips or cracks in mattress cover.
- _____ Ground chain intact.
- _____ No leaks at hydraulic connections.
- _____ Hydraulic jacks holding properly.
- _____ Hydraulic drop rate set properly.
- _____ Hydraulic oil level sufficient.
- _____ Lubricate where required.
- _____ Accessories and mounting hardware in good condition and working properly.

Stretcher Serial Number:		

Completed by: _____

Date: _____

Note

Preventative maintenance should be performed at a minimum of annually. A preventative maintenance program should be established for all Stryker Medical equipment. Preventative maintenance may need to be performed more frequently based on the usage level of the product.

Cleaning

Hand wash all surfaces of the stretcher with warm water and mild detergent. **Dry thoroughly.** Do not steam clean, pressure wash, hose off or ultrasonically clean the stretcher. Using these methods of cleaning is **not** recommended and may void this product's warranty.

Suggested cleaners for stretcher surfaces:

- Quaternary Cleaners (active ingredient - ammonium chloride).
- Phenolic Cleaners (active ingredient - o-phenylphenol).
- Chlorinated Bleach Solution (5.25% - less than 1 part bleach to 100 parts water).

Avoid oversaturation and ensure the product does not stay wet longer than the chemical manufacturer's guidelines for proper disinfecting.

 **CAUTION**

SOME CLEANING PRODUCTS ARE CORROSIVE IN NATURE AND MAY CAUSE DAMAGE TO THE PRODUCT IF USED IMPROPERLY. If the products suggested above are used to clean Stryker patient care equipment, measures must be taken to insure the stretcher is wiped with a damp cloth soaked in clean water and thoroughly dried following cleaning. Failure to properly rinse and dry the stretcher will leave a corrosive residue on the surface of the stretcher, possibly causing premature corrosion of critical components. Failure to follow the above directions when using these types of cleaners may void this product's warranty.

For mattress cleaning instructions, please see the tag on the mattress, or contact the mattress manufacturer.

Clean Velcro® **after each use.** Saturate Velcro® with disinfectant and allow disinfectant to evaporate. (Appropriate disinfectant for nylon Velcro® should be determined by the hospital).

Warranty

LIMITED WARRANTY

Stryker Medical Division, a division of Stryker Corporation, warrants to the original purchaser the Wide Transport Stretcher Model 738 to be free from defects in material and workmanship for a period of One (1) years after date of delivery. Stryker's obligation under this warranty is expressly limited to supplying replacement parts and labor for, or replacing, at its option, any product which is, in the sole discretion of Stryker, found to be defective. If requested by Stryker, products or parts for which a warranty claim is made shall be returned prepaid to the factory. Any improper use or any alteration or repair by others in such manner as in Stryker's judgment affects the product materially and adversely shall void this warranty. Any repair of Stryker products using parts not provided or authorized by Stryker shall void this warranty. No employee or representative of Stryker is authorized to change this warranty in any way.

Stryker Medical Stretcher products are designed for a 10 year expected service life under normal use, conditions, and with appropriate periodic maintenance as described in the maintenance manual for each device. Stryker warrants to the original purchaser that the welds on its Stretcher products will be free from structural defects for the expected 10 year life of the Stretcher product as long as the original purchaser owns the product.

This statement constitutes Stryker's entire warranty with respect to the aforesaid equipment. **Stryker makes no other warranty or representation, either expressed or implied, except as set forth herein. There is no warranty of merchantability and there are no warranties of fitness for any particular purpose. In no event shall Stryker be liable here under for incidental or consequential damages arising from or in any manner related to sales or use of any such equipment.**

TO OBTAIN PARTS AND SERVICE

Stryker products are supported by a nationwide network of dedicated Stryker Field Service Representatives. These representatives are factory trained, available locally, and carry a substantial spare parts inventory to minimize repair time. Simply call your local representative, or call Stryker Customer Service USA at 1-800-327-0770, Canada 1-888-233-6888.

SERVICE CONTRACT COVERAGE

Stryker has developed a comprehensive program of service contract options designed to keep your equipment operating at peak performance at the same time it eliminates unexpected costs. We recommend that these programs be activated before the expiration of the new product warranty to eliminate the potential of additional equipment upgrade charges.

A Service Contract helps to:

- Ensure equipment reliability
- Stabilize maintenance budgets
- Diminish downtime
- Establish documentation for JCAHO
- Increase product life
- Enhance trade-in value
- Address risk management and safety

Warranty

SERVICE CONTRACT PROGRAMS

Stryker offers the following service contract programs:

Service Agreement Options *	Gold	Silver	Parts	Labor	PM
Annually scheduled preventative maintenance	X				X
All parts	X	X	X		
All labor and travel	X	X		X	
Unlimited emergency service calls	X	X		X	
Priority one contact: two hour phone response	X	X	X	X	
Most repairs completed within 3 days	X	X		X	
JCAHO documentation	X	X		X	X
On-site record of PM & emergency service	X				X
Factory-trained Stryker service technician	X	X		X	X
Stryker authorized parts used	X	X	X	X	X
Service during regular business hours (8-5)	X	X	X	X	X

* Does not include maintenance due to abuse or for any disposable items. Stryker reserves the right to change options without notice.

Stryker Medical also offers personalized service contracts.
Pricing is determined by age, location, model and condition of product.

**For more information on our service contracts,
please call your local representative.**

RETURN AUTHORIZATION

Merchandise cannot be returned without approval from the Stryker Customer Service Department. An authorization number will be provided which must be printed on the returned merchandise. Stryker reserves the right to charge shipping and restocking fees on returned items. **Special, modified, or discontinued, items not subject to return.**

DAMAGED MERCHANDISE

ICC Regulations require that claims for damaged merchandise must be made with the carrier within fifteen (15) days of receipt of merchandise. **Do not accept damaged shipments unless such damage is noted on the delivery receipt at the time of receipt.** Upon prompt notification, Stryker will file a freight claim with the appropriate carrier for damages incurred. Claim will be limited in amount to the actual replacement cost. In the event that this information is not received by Stryker within the fifteen (15) day period following the delivery of the merchandise, or the damage was not noted on the delivery receipt at the time of receipt, the customer will be responsible for payment of the original invoice in full. Claims for any short shipment must be made within thirty (30) days of invoice.

INTERNATIONAL WARRANTY CLAUSE

This warranty reflects U.S. domestic policy. Warranty outside the U.S. may vary by country. Please contact your local Stryker Medical representative for additional information.

[Return To Table of Contents](#)

UNITED STATES
Stryker Medical
3800 E. Centre Ave.,
Portage, Michigan USA
49002

CANADA
Stryker Canada
45 Innovation Drive
Hamilton, Ontario Canada
L9H 7L8

EC	REP
----	-----

European Representative
Stryker France
ZAC Satolas Green Pusignan
Av. De Satolas Green
69881 MEYZIEU Cedex
France

stryker[®]