

Renaissance Series

1026 Full Length X-Ray Stretcher

OPERATIONS MANUAL

For Parts or Technical Assistance
1-800-327-0770

Table of Contents

INTRODUCTION	2
SPECIFICATIONS	2
WARNING / CAUTION / NOTE DEFINITION	2
CLEANING	2
SIDE CONTROL BASE ILLUSTRATION	3
END CONTROL BASE ILLUSTRATION	4
RAISING AND LOWERING LITTER HEIGHT	5
TRENDELENBERG/REVERSE TRENDELENBERG POSITIONING	5
OPERATING DIRECTIONAL STEERING CASTER/5TH WHEEL OPTIONS	5
APPLYING THE BRAKE SYSTEM	6
OPERATING THE FOWLER	6
OPERATING FULL-LENGTH X-RAY CASSETTE TRAY	6
OPERATING SIDERAILS	7
OPERATING OPTIONAL PERMANENTLY ATTACHED I.V. POLE	7
LIMITED WARRANTY	
Obtaining Parts and Service	8
Supplemental Warranty Coverage	8
Return Authorization	9
Freight Damage Claims	9

Introduction

INTRODUCTION

This manual is designed to assist you with the operation of the 1026 Full Length X-Ray Stretcher. Read it thoroughly before using the equipment or beginning any maintenance on it.

SPECIFICATIONS

Maximum Weight Capacity	500 pounds
Overall Bed Length/Width	82"/28.5"
Minimum/Maximum Bed Height	25.5"/34.75"
Bed Weight w/Accessories	250 pounds (average)
Fowler Angle	0 to 90 °
Trendelenberg/Reverse Trendelenberg	-15 ° to +18 °

WARNING / CAUTION / NOTE DEFINITION

The words WARNING, CAUTION and NOTE carry special meanings and should be carefully reviewed.

WARNING

The personal safety of the patient or user may be involved. Disregarding this information could result in injury to the patient or user.

CAUTION

These instructions point out special procedures or precautions that must be followed to avoid damaging the equipment.

NOTE

This provides special information to make maintenance easier or important instructions clearer.

CLEANING

1. Hand wash all surfaces of the bed with warm water and mild detergent. Dry thoroughly.
2. Clean Velcro **AFTER EACH USE**. Saturate Velcro with disinfectant and allow disinfectant to evaporate. (Appropriate disinfectant for nylon Velcro should be determined by the hospital.)

NOTE

Quaternary Germicidal Disinfectants, used as directed, and/or Chlorine Bleach products, typically 5.25% Sodium Hypochlorite in dilutions ranging between 1 part bleach to 100 parts water, and 2 parts bleach to 100 parts water are not considered mild detergents. These products are corrosive in nature and may cause damage to your stretcher if used improperly. If these types of products are used to clean Stryker patient handling equipment, measures must be taken to insure the stretchers are rinsed with clean water and thoroughly dried following cleaning. Failure to properly rinse and dry the stretchers will leave a corrosive residue on the surface of the stretcher, possibly causing premature corrosion of critical components. Failure to follow the above directions when using these types of cleaners may void this product's warranty.

Side Control Base Illustration

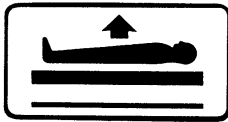
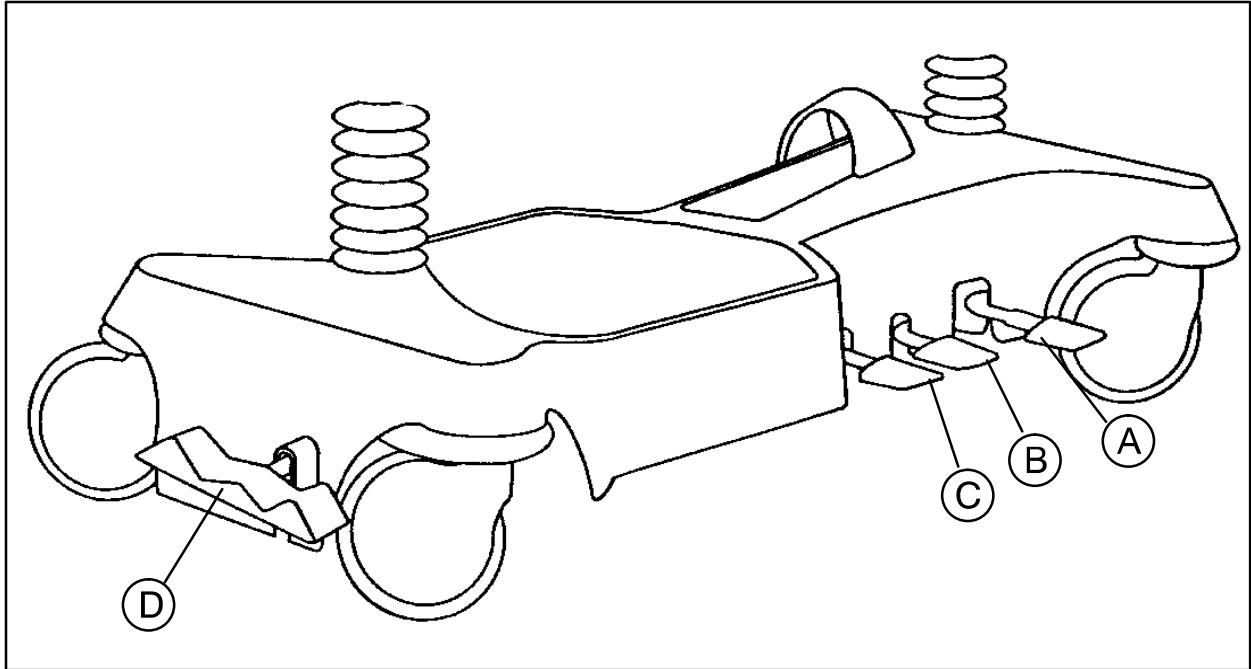

(A) Pump to raise litter



(B) Depress to lower head end



(C) Depress to lower foot end

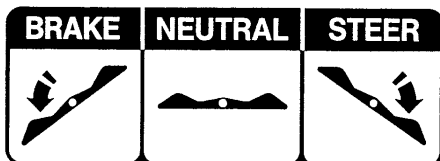

(D) Brake and Steer functions

End Control Base Illustration

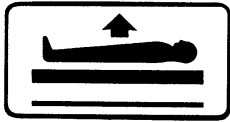
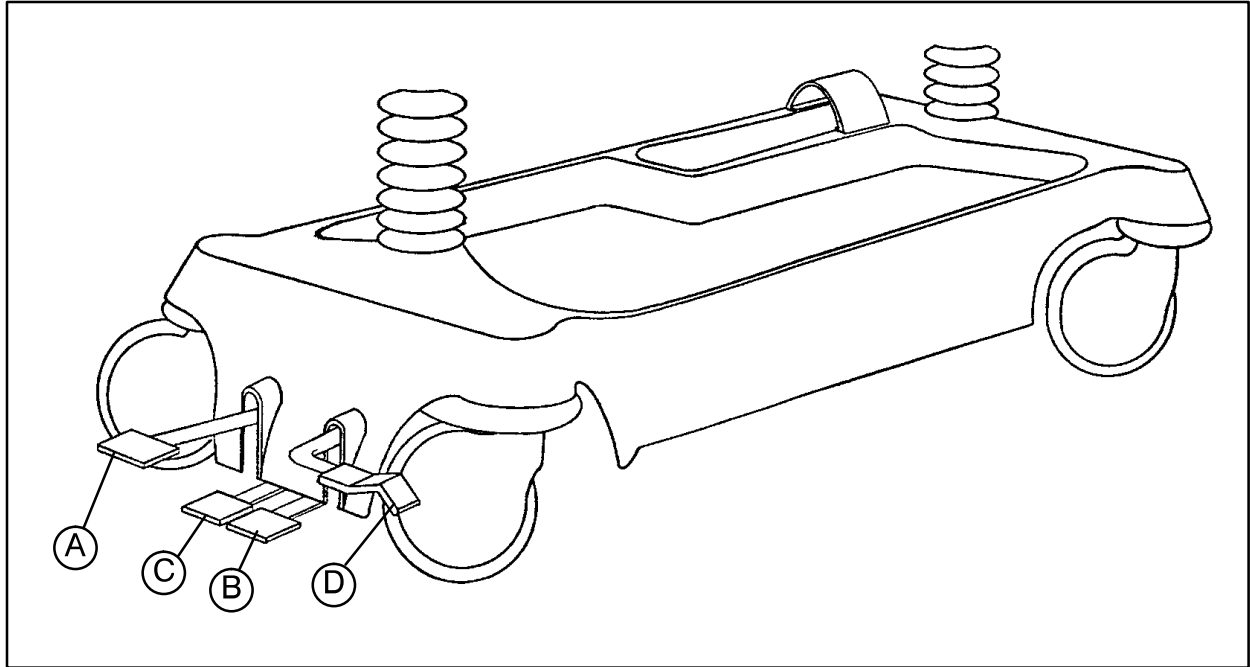

(A) Pump to raise litter



(B) Depress to lower head end



(C) Depress to lower foot end



(D) Brake and Steer Functions

RAISING AND LOWERING LITTER HEIGHT

NOTE

For user convenience, pump pedals and control pedals are located on both sides of the stretcher for "Dual Side Control" stretchers, or on both ends for "Dual End Control" stretchers.

CAUTION

Be sure to move any equipment that may be in the way before raising or lowering stretcher height.

To **raise** the litter height, pump the foot pump pedal (A) repeatedly until desired height is achieved. (See illustration, page 3 for side control stretchers or page 4 for end control stretchers).

To **lower** the litter height, depress pedal (B) to lower the head end and depress pedal (C) to lower the foot end of the stretcher. (See illustration, page 3 or page 4).

NOTE

When lowering both ends of the stretcher simultaneously, activate both pedals (B) and (C) using the same foot.

TRENDELENBERG/REVERSE TRENDELENBERG POSITIONING

NOTE

Litter height must be raised first in order to achieve a trend. or reverse trend. position.

CAUTION

Be sure to remove any equipment that may be in the way before lowering stretcher.

For **Trendelenberg** positioning (head down), depress pedal (B). (See illustration, page 3 or page 4).

For **Reverse Trendelenberg** positioning (foot down), depress pedal (C). (See illustration, page 3 or page 4).

NOTE

The higher the litter is before pedals (B) or (C) are activated, the greater the trend. or reverse trend. angle will be. (Maximum trend. angle is +12 degrees. Maximum reverse trend. angle is -18 degrees).

OPERATING DIRECTIONAL STEERING CASTER/5TH WHEEL OPTIONS

The purpose of the steer wheel and 5th wheel options are to help guide the stretcher when transporting a patient along a straight line and also for pivoting at corners.

NOTE

Stretchers cannot be equipped with both steering caster and fifth wheel options. The choice was made at the time the stretcher was purchased.

Important: For proper "tracking" of the steer caster or fifth wheel options, push the stretcher approximately 10 feet to allow the wheels to face the direction of travel before engaging the steer pedal. If this procedure is not followed, proper "tracking" will not occur, causing difficulty with steering the stretcher.

The steer wheel is located at the foot end of the stretcher on the patient's left. The 5th wheel is located underneath the center of the base assembly.

To engage the steer wheel/5th wheel on a "Dual Side Control" stretcher, push the right side of pedal (D) to the full down position. (See illustration page 3).

To engage the steer wheel/5th wheel on a "Dual End Control" stretcher, pull pedal (D) to the full up position. (See illustration page 4).

Stretcher Operation

APPLYING THE BRAKE SYSTEM

NOTE

For user convenience, the Brake/Steer pedal is located on both ends of the stretcher on both "Dual Side" and "Dual End" control stretchers.

CAUTION

If brakes do not hold properly, refer to your stretcher maintenance manual for "Brake Adjustment"

To engage the brakes on a "Dual Side Control" stretcher, push fully down on the left side of pedal (D). (See illustration page 3).

To engage the brakes on a "Dual End Control" stretcher, push fully down on pedal (D). (See illustration page 4).

OPERATING THE FOWLER

The stretcher will be equipped with one of two Fowler options: pneumatic or manual.

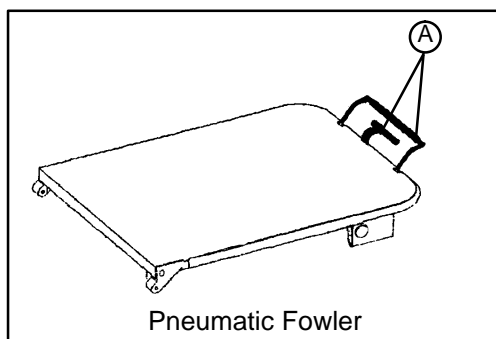

To position the pneumatic Fowler, grasp the handles (A) and squeeze. Guide the Fowler to the desired height and release the handles.

To position the manual Fowler, lift up on the Fowler with the red handle. The brace assembly will fall into position on the Fowler support brackets as the Fowler is raised or lowered to the desired height.

CAUTION

Before releasing the handle, be sure the brace assembly is securely locked in the Fowler support brackets.

OPERATING FULL-LENGTH X-RAY CASSETTE TRAY

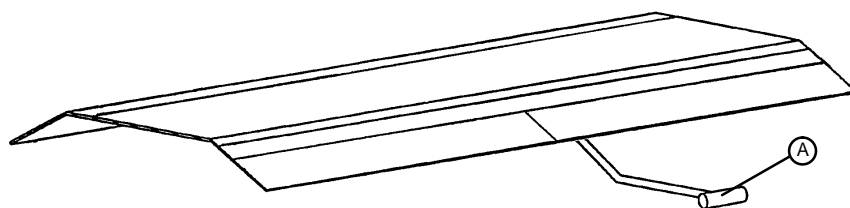

1. The x-ray film cassette can be loaded from the head, foot, or either side of the stretcher.
2. Lift up on the handle (A) on either side of the stretcher and slide the tray to the required point on the litter top.

Stretcher Operation

OPERATING SIDERAILS

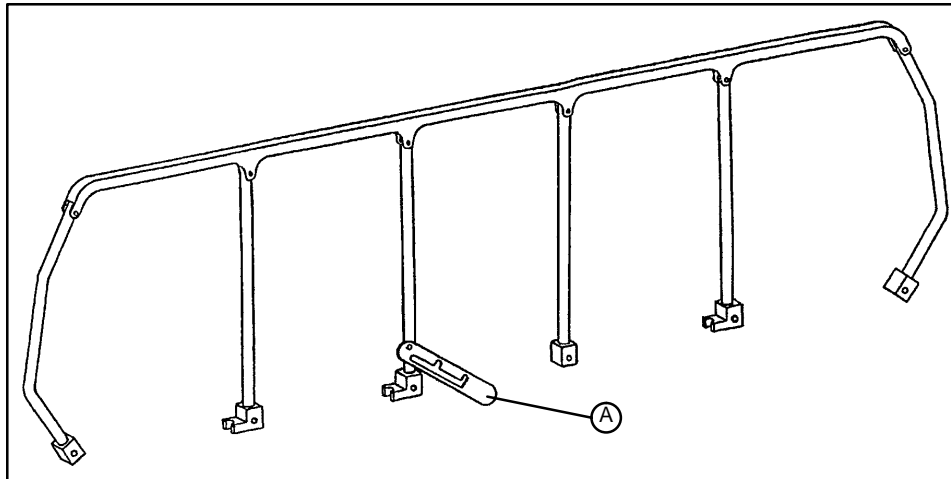

There is a bolt in the fold-down siderail latch (A) that holds the siderail in the upright position or in an intermediate position. Lift up on the siderail and be sure the bolt engages and the siderail is securely latched. To lower the siderail, push up on the latch (A) until the bolt disengages and guide the siderail down.

OPERATING OPTIONAL PERMANENTLY ATTACHED I.V. POLE

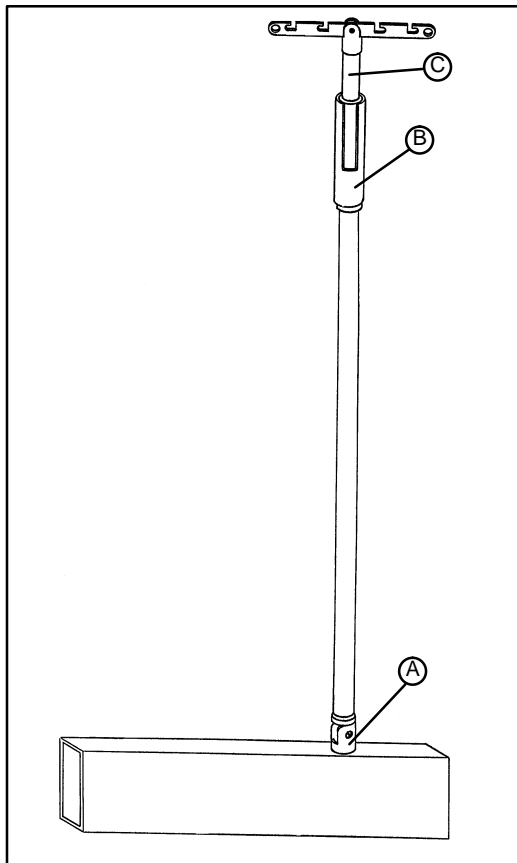

NOTE

An optional permanently attached I.V. Pole may have been installed at either the head, foot or both ends of the stretcher. The choice was made at the time the stretcher was purchased.

To Use the I.V. Pole:

1. Lift the I.V. pole from the I.V. rest and hinge downward into receptacle (A).
2. To increase the height of the pole, turn the lock actuator (B) counterclockwise and pull up on the telescoping portion (C). Raise the pole to the desired height.
3. Turn the lock actuator (B) clockwise to lock the telescoping portion in place.

CAUTION

The weight of the I.V. bags should not exceed 40 pounds.

Warranty

Limited Warranty:

Stryker Medical Division, a division of Stryker Corporation, warrants to the original purchaser that its products should be free from defects in material and workmanship for a period of one (1) year after date of delivery. Stryker's obligation under this warranty is expressly limited to supplying replacement parts and labor for, or replacing, at its option, any product which is, in the sole discretion of Stryker, found to be defective. Stryker warrants to the original purchaser that the frame and welds on its beds will be free from structural defects for as long as the original purchaser owns the bed. If requested by Stryker, products or parts for which a warranty claim is made shall be returned prepaid to Stryker's factory. Any improper use or any alteration or repair by others in such manner as in Stryker's judgement affects the product materially and adversely shall void this warranty. No employee or representative of Stryker is authorized to change this warranty in any way.

This statement constitutes Stryker's entire warranty with respect to the aforesaid equipment. STRYKER MAKES NO OTHER WARRANTY OR REPRESENTATION, EITHER EXPRESSED OR IMPLIED, EXCEPT AS SET FORTH HEREIN. THERE IS NO WARRANTY OF MERCHANTABILITY AND THERE ARE NO WARRANTIES OF FITNESS FOR ANY PARTICULAR PURPOSE. IN NO EVENT SHALL STRYKER BE LIABLE HEREUNDER FOR INCIDENTAL OR CONSEQUENTIAL DAMAGES ARISING FROM OR IN ANY MANNER RELATED TO SALES OR USE OF ANY SUCH EQUIPMENT.

To Obtain Parts and Service:

Stryker products are supported by a nationwide network of dedicated Stryker Field Service Representatives. These representatives are factory trained, available locally, and carry a substantial spare parts inventory to minimize repair time. Simply call your local representative, or call Stryker Customer Service at (800) 327-0770.

Supplemental Warranty Coverage:

Stryker has developed a comprehensive program of extended warranty options designed to keep your equipment operating at peak performance at the same time it eliminates unexpected costs. We recommend that these programs be activated *before* the expiration of the new product warranty to eliminate the potential of additional equipment upgrade charges. Stryker offers the following Supplemental Warranties:

Extended (Parts and Labor)

- All replacement parts (excluding mattresses and consumable items)
- Labor and travel for *all* scheduled and unscheduled calls
- Biannual Preventive Maintenance Inspections and repairs
- JCAHO paperwork for preventive maintenance
- Priority Emergency Service

Standard (Labor Only):

- Labor and travel for *all* scheduled and unscheduled calls
- Biannual Preventive Maintenance Inspections and repairs
- JCAHO paperwork for preventive maintenance
- Priority Emergency Service

Basic (Parts Only):

- All replacement parts (excluding mattresses and consumable items)
- Priority Emergency Service

Please call your local representative, or call (800) 327-0770 for further information

Return Authorization:

Merchandise cannot be returned without approval from the Stryker Customer Service Department. An authorization number will be provided which must be printed on the returned merchandise. Stryker reserves the right to charge shipping and restocking fees on returned items.

SPECIAL, MODIFIED, OR DISCONTINUED ITEMS NOT SUBJECT TO RETURN.

Damaged Merchandise:

ICC Regulations require that claims for damaged merchandise must be made with the carrier within fifteen (15) days of receipt of merchandise. **DO NOT ACCEPT DAMAGED SHIPMENTS UNLESS SUCH DAMAGE IS NOTED ON THE DELIVERY RECEIPT AT THE TIME OF RECEIPT.** Upon prompt notification, Stryker will file a freight claim with the appropriate carrier for damages incurred. Claim will be limited in amount to the actual replacement cost. In the event that this information is not received by Stryker within the fifteen (15) day period following the delivery of the merchandise, or the damage was not noted on the delivery receipt at the time of receipt, the customer will be responsible for payment of the original invoice in full.

Claims for any short shipment must be made within thirty (30) days of invoice.



6300 Sprinkle Road, Kalamazoo, MI 49001-9799

(800) 327-0770

DH 3/93 1026-1-283 REV__