

THC5 (11225) Assembly instructions

Items needed

- (1) THC5, stand assembly (p/n 11225)
- (1) Instruction sheet (p/n 0000-001-023)

Tools required

- 7/16" Wrench
- Torque wrench

Procedure

To assemble the THC5 pole

1. Insert the pin located on the end of the pole, into the guide pin hole on the base ([Figure 1 on page 1](#) and [Figure 2 on page 1](#)).



Figure 1: Pin



Figure 2: Base

2. Tip the stand over and insert the provided screw and washer into the bottom of the base ([Figure 3 on page 1](#)).



Figure 3: Bottom of the base



Figure 4: THC5 assembly

3. Using a 7/16" wrench and torque wrench (20.5 ± 3 ft-lb), tighten the screw and washer.
4. Turn the stand over and make sure the pole is secure to the stand ([Figure 4 on page 1](#)).

THC5 (11225) Assembly instructions

Procedure (Continued)

CAUTION

Always mount the warming unit securely before use to avoid the risk of injury or equipment damage.

To install Mistral-Air onto the THC5 stand

1. Lift the Mistral-Air unit from the top using the handle (Figure 5 on page 2).



Figure 5: Top handle

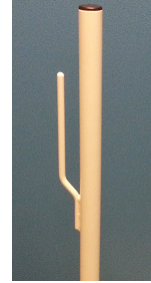

Figure 6: Stand protrusion

2. Orient the Mistral-Air control panel opposite of the protrusion on the stand (Figure 6 on page 2).
3. Slide the Mistral-Air unit onto the THC5 stand by placing the curved indentation on the back of the unit over the top of the stand with the power cord on the outside of the stand protrusion (Figure 7 on page 2).



Figure 7: Mistral-Air onto the THC5 stand



Figure 8: Secure

4. Stop sliding the Mistral-Air unit when the curvature touches the protrusion on the stand.
5. Turn the knob clockwise to lock the Mistral-Air unit onto the THC5 stand.
6. Make sure that the Mistral-Air unit is secure and does not tip (Figure 8 on page 2).

Note: See the Mistral-Air warming unit operations manual for safety and usage.

To remove Mistral-Air from the THC5 stand

1. Turn the knob counter clockwise to unlock the Mistral-Air unit from the THC5 stand while holding onto the Mistral-Air handle.
2. Lift the Mistral-Air unit upward to remove from the stand.

THC5 (11225) Assembly instructions

Caster replacement

Kit contents for caster without brakes (0000-001-545)

- (1) Caster, without brake (0000-001-544)
- (1) Fastener, washer (0000-001-548)
- (1) Fastener, nut (0000-001-549)
- (1) Instruction sheet (0000-001-023)

Kit contents for caster with brakes(0000-001-547)

- (1) Caster, with brake (0000-001-546)
- (1) Fastener, washer (0000-001-548)
- (1) Fastener, nut (0000-001-549)
- (1) Instruction sheet (0000-001-023)

Tools required

- 7/16" Wrench
- Torque wrench

To replace a caster, follow these procedures

1. Using a 7/16" wrench, unscrew the bolt and lock washer that secure the caster to the base.

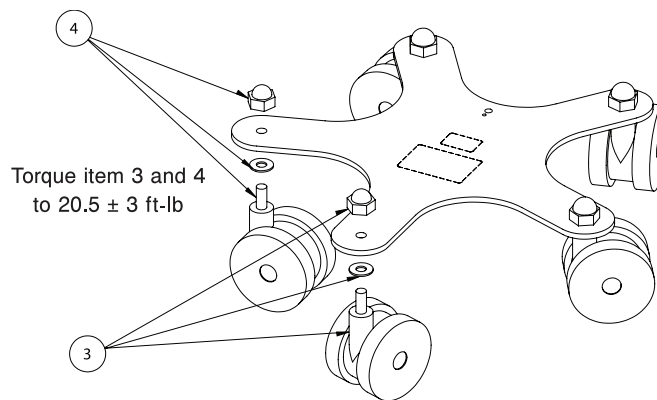

Figure 9: Caster replacement

2. Remove and discard the caster, washer, and nut.
3. Reverse to reinstall.

Notes

- Do not put a caster with a brake next to one another.
 - Use the torque wrench for reinstall.
4. Verify proper operation of the product before returning it to service.