

---

**IMPORTANT**  
Keep manual  
on file at all  
times.

**stryker**<sup>®</sup>  
Medical



**Model 6060/6070**

---

**▲RUGGED™ Ambulance Cot**

---

**OPERATIONS/MAINTENANCE MANUAL**

For Parts or Technical Assistance  
1-800-784-4336

---

# Table of Contents

---

Introduction	
Specifications	2
Warning / Caution / Note Definition	2
Warranty	
Obtaining Parts and Service	3
Supplemental Warranty Coverage	3
Return Authorization	4
Freight Damage Claims	4
Summary of Safety Precautions	5
Set-Up Procedures	6
Component Identification	7
Vehicle Safety Hook Installation	8
Cot Positions	9
Cot Operation	
Installing and Using Restraint Straps	10, 11
Transferring the Patient to the Cot	12
Rolling the Cot	12
Loading the Cot into a Vehicle	13
Unloading the Cot from a Vehicle	14
Changing Cot Height	15
Adjusting Leg Rest	16
Operating Fowler	17
Operating Siderails	17
Operating Break-Away Head Section	18
Operating I.V. Poles	19, 20
Maintenance	
Cleaning	21
Checklist	21
Preventative Maintenance Schedule	22
Pneumatic Fowler Adjustment	23
Maintenance Record	24
Training Record	25
Assembly Drawings and Parts Lists	
Cot Assembly (6070)	26, 27
Cot Assembly (6060)	28, 29
Base Assembly	30, 31
Wheel Assembly	32
Lock Bar Assembly – Height Adjustment Rack	33
Break-Away Head End Assembly	34, 35
Litter Assembly (6070)	36–39
Litter Assembly (6060)	40–42
Siderail Assembly	43
2-Stage I.V. Pole Mounting Assembly	44, 45
2-Stage I.V. Pole Assembly	46, 47
I.V. Pole Base Assembly	48
2nd Stage Assembly – 2-Stage I.V. Pole	49
3-Stage I.V. Pole Mounting Assembly	50, 51
3-Stage I.V. Pole Assembly	52, 53
2nd Stage Assembly – 3-Stage I.V. Pole	54
3rd Stage Assembly – 3-Stage I.V. Pole	55
Oxygen Bottle Holder Assembly	56–59
Base Storage Tray Assembly	60
Replacement Part Numbers	61

# Introduction

---

## INTRODUCTION

This manual is designed to assist you with the operation and maintenance of the 6060 and 6070 **▲RUGGED▲** Ambulance Cots. Read it thoroughly before using the equipment or beginning any maintenance on it.

## SPECIFICATIONS

Maximum Weight Capacity	500 pounds
Overall Length/Width	80"/24"
Patient Surface Length/Width	74"/19"
Shortened Length	62"
Height Range	11.75" – 36.5"
Fowler Angle	0° to 75°
Caster Diameter/Width	6"/2"

## WARNING / CAUTION / NOTE DEFINITION

The words WARNING, CAUTION and NOTE carry special meanings and should be carefully reviewed.

---

### WARNING

The personal safety of the patient or user may be involved. Disregarding this information could result in injury to the patient or user.

---

---

### CAUTION

These instructions point out special procedures or precautions that must be followed to avoid damaging the equipment.

---

### NOTE

This provides special information to make maintenance easier or important instructions clearer.

# Warranty

---

## **Limited Warranty:**

Stryker Medical Division, a division of Stryker Corporation, warrants to the original purchaser that its products should be free from defects in material and workmanship for a period of one (1) year after date of delivery. Stryker's obligation under this warranty is expressly limited to supplying replacement parts and labor for, or replacing, at its option, any product which is, in the sole discretion of Stryker, found to be defective. Stryker warrants to the original purchaser that the frame and welds on its beds will be free from structural defects for as long as the original purchaser owns the bed. If requested by Stryker, products or parts for which a warranty claim is made shall be returned prepaid to Stryker's factory. Any improper use or any alteration or repair by others in such manner as in Stryker's judgement affects the product materially and adversely shall void this warranty. No employee or representative of Stryker is authorized to change this warranty in any way.

This statement constitutes Stryker's entire warranty with respect to the aforesaid equipment. STRYKER MAKES NO OTHER WARRANTY OR REPRESENTATION, EITHER EXPRESSED OR IMPLIED, EXCEPT AS SET FORTH HEREIN. THERE IS NO WARRANTY OF MERCHANTABILITY AND THERE ARE NO WARRANTIES OF FITNESS FOR ANY PARTICULAR PURPOSE. IN NO EVENT SHALL STRYKER BE LIABLE HEREUNDER FOR INCIDENTAL OR CONSEQUENTIAL DAMAGES ARISING FROM OR IN ANY MANNER RELATED TO SALES OR USE OF ANY SUCH EQUIPMENT.

## **To Obtain Parts and Service:**

Stryker products are supported by a nationwide network of dedicated Stryker Field Service Representatives. These representatives are factory trained, available locally, and carry a substantial spare parts inventory to minimize repair time. Simply call your local representative, or call Stryker Customer Service at (800) 327-0770.

## **Supplemental Warranty Coverage:**

Stryker has developed a comprehensive program of extended warranty options designed to keep your equipment operating at peak performance at the same time it eliminates unexpected costs. We recommend that these programs be activated *before* the expiration of the new product warranty to eliminate the potential of additional equipment upgrade charges. Stryker offers the following Supplemental Warranties:

### **Extended (Parts and Labor)**

- All replacement parts (excluding mattresses and consumable items)
- Labor and travel for *all* scheduled and unscheduled calls
- Annual Preventive Maintenance Inspections and repairs
- JCAHO paperwork for preventive maintenance
- Priority Emergency Service

### **Standard (Labor Only):**

- Labor and travel for *all* scheduled and unscheduled calls
- Annual Preventive Maintenance Inspections and repairs
- JCAHO paperwork for preventive maintenance
- Priority Emergency Service

### **Basic (Parts Only):**

- All replacement parts (excluding mattresses and consumable items)
- Priority Emergency Service

**Please call your local representative, or call (800) 327-0770 for further information**

# Warranty

---

## **Return Authorization:**

Merchandise cannot be returned without approval from the Stryker Customer Service Department. An authorization number will be provided which must be printed on the returned merchandise. Stryker reserves the right to charge shipping and restocking fees on returned items.

SPECIAL, MODIFIED, OR DISCONTINUED ITEMS NOT SUBJECT TO RETURN.

## **Damaged Merchandise:**

ICC Regulations require that claims for damaged merchandise must be made with the carrier within fifteen (15) days of receipt of merchandise. **DO NOT ACCEPT DAMAGED SHIPMENTS UNLESS SUCH DAMAGE IS NOTED ON THE DELIVERY RECEIPT AT THE TIME OF RECEIPT.** Upon prompt notification, Stryker will file a freight claim with the appropriate carrier for damages incurred. Claim will be limited in amount to the actual replacement cost. In the event that this information is not received by Stryker within the fifteen (15) day period following the delivery of the merchandise, or the damage was not noted on the delivery receipt at the time of receipt, the customer will be responsible for payment of the original invoice in full.

Claims for any short shipment must be made within thirty (30) days of invoice.

## **International Warranty Clause:**

This warranty reflects U.S. domestic policy. Warranty outside the U.S. may vary by country. Please contact your local Stryker Medical representative for additional information.

# Summary of Safety Precautions

---

The following is a list of safety precautions that must be observed when operating or servicing this unit. The precautions are repeated throughout the manual, where applicable. Carefully read this list before using or servicing the unit.

---

## WARNING

- Improper usage of the **▲RUGGED™** Cot can cause injury to the patient or operator. Operate the cot only as described in this manual.
- Always use all restraint straps to secure the patient on the cot. An unrestrained patient may fall from the cot and be injured.
- Never leave a patient unattended on the cot or injury could result. Hold the cot securely while a patient is on the cot.
- Be sure the undercarriage has engaged and locked before removing the loading wheels from the patient compartment floor of the vehicle. An unlocked undercarriage will not support the cot and injury to the patient and/or operator could result.
- Do not allow untrained helpers to assist in the operation of the cot. Untrained technicians/helpers can cause injury to the patient or themselves.
- Grasping the **▲RUGGED™** Cot improperly can cause injury. Grasp only the litter frame or the lifting bar to lift the cot. Keep hands/fingers away from moving parts.
- Do not modify the **▲RUGGED™** Cot. Modifying the cot can cause unpredictable operation resulting in injury to the patient or operator. Modifying the cot will also void its warranty (see page 3).
- Have the vehicle safety hook installed by a certified mechanic. Improper safety hook installation can cause injury to the patient or operator or damage to the unit.
- Failure to use the vehicle safety hook can cause injury to the patient or operator. Install and use the safety hook as described in this manual.
- Improper maintenance can cause injury or damage to the unit. Maintain the cot as described in this manual. Use only Stryker approved parts and maintenance procedures. Using unapproved parts and procedures could cause unpredictable operation and/or injury.

---

## CAUTION

- Damage to the cot can occur if the cot is lowered in the shortened position. Use only positions 5–8 (see page 9) when the cot is shortened.
- Lifting the cot by the safety bar can cause damage to the cot. Lift the cot only by the main frame or by the lifting bar.

# Set-Up Procedures

---

Unpack the cartons and check all items for proper operation. It is important that the **▲RUGGED™** Cot is working properly before it is put into service. Have a qualified service person use the following list and the operation instructions to check the cot before it is put into service.

- All fasteners secure (reference all assembly prints)
- All welds intact, not cracked or broken
- No bent or broken tubing or sheet metal
- No debris in wheels
- All wheels secure and roll and swivel properly
- Siderails move and latch properly (see page 17)
- Fowler operating properly (see page 17)
- I.V. pole intact and operating properly (page 19)
- Height positioning latch functioning properly
- Cot secure in each height position (see page 9)
- Undercarriage folds properly (see page 15)
- Break-away head section operating properly (see page 18)
- Safety bar operating properly
- Foot rest operating properly (Model 6070)
- No rips or cracks in mattress cover
- Body restraints intact and working properly (see page 10 & 11)
- Does the vehicle safety hook engage the safety bar so that the cot loads and unloads easily from the vehicle? (See page 8)
- Is there an approved crash-stable fastener (Stryker part number 6370 or 6371 – not included) installed in the vehicle?

The patient compartment of the vehicle in which the **▲RUGGED™** Cot will be used must have:

- A smooth rear edge for cot loading.
- A level floor large enough for the folded cot.
- Stryker 6370 or 6371 crash stable cot fastener (not included).
- 33" (84 cm.) maximum loading height.
- Space to install the safety hook.

When necessary, modify the vehicle to fit the cot. Do not modify the cot.

---

## **WARNING**

Do not modify the **▲RUGGED™** Cot. Modifying the cot can cause unpredictable operation resulting in injury to the patient or operator. Modifying the cot will also void its warranty (see page 3).

---

# Component Identification

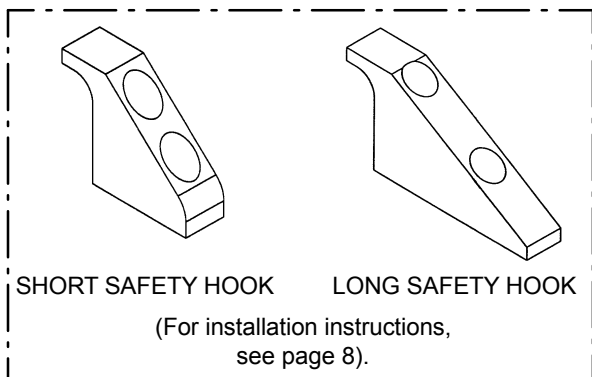
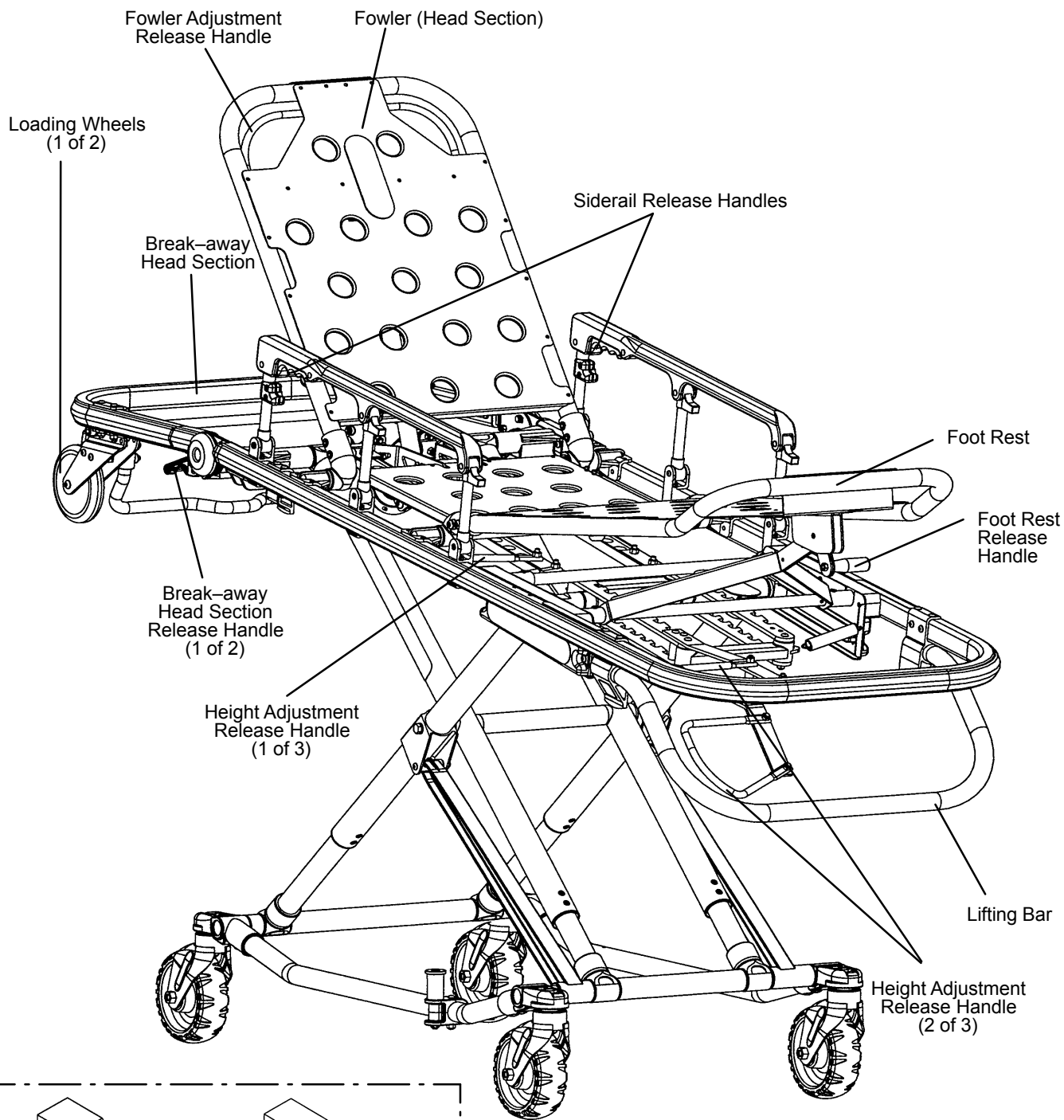



# Vehicle Safety Hook Installation

The vehicle safety hook is a device shipped with the cot. The safety hook activates the safety bar and prevents the cot from being removed from the vehicle accidentally.

Installation of the safety hook should be done by a certified mechanic familiar with ambulance construction. Consult the vehicle manufacturer before installing the safety hook and be sure the installation of the safety hook does not interfere with or damage the brake lines, oxygen lines, fuel lines or fuel tank or the electrical wiring of the vehicle.

## Required Hardware for Installation of the Safety Hook (Not Supplied)

- (2) Grade 5, 1/4"–20 Socket Head Cap Screws\*
- (2) Flat Washers
- (2) Lock Washers
- (2) 1/4"–20 Nuts

\* The length of the socket head cap screws depends on the thickness of the vehicle floor. Use screws long enough to go completely through the patient compartment floor, washer and nut by at least two full threads.

Place the cot in the cot fastener. Remove the cot from the fastener and unload it from the vehicle. While the cot is being removed from the vehicle, take note of the position of the unloading wheels and the safety bar.

NOTE 1. Center the safety hook on the cot safety bar with the hook facing the front of the vehicle. Be sure the safety hook will always engage the safety bar when the cot is unloaded from the vehicle.

NOTE 2. The safety hook should be installed as close to the rear of the vehicle as possible while allowing the vehicle doors to close (see Figure 1). Be sure the bumper and the bumper step do not interfere with the folding and unfolding of the cot's undercarriage.

Mark the desired position of the safety hook on the patient compartment floor. Drill the holes for the socket head cap screws. Attach the safety hook to the patient compartment floor.

## WARNING

Improper safety hook installation can cause injury to the patient and/or operator or damage to the cot. Have a certified mechanic install the safety hook.

Failure to install the safety hook can cause injury to the patient or operator. Install and use the safety hook as described in this manual.

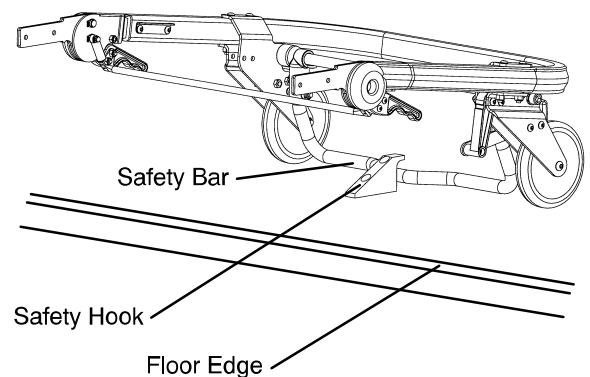
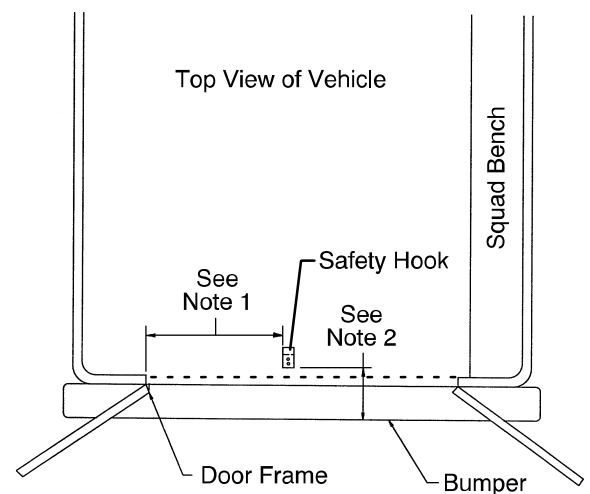

# Cot Positions

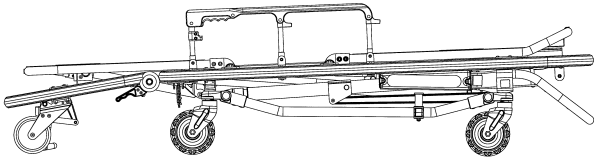

Position 1 – Use for patient transfer.

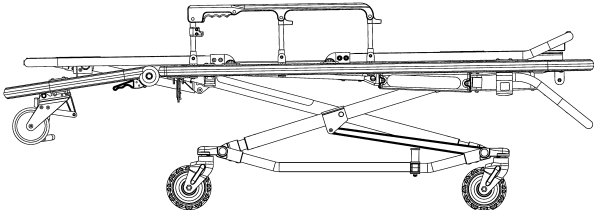

Position 2 – Use for patient transfer/cot rolling.

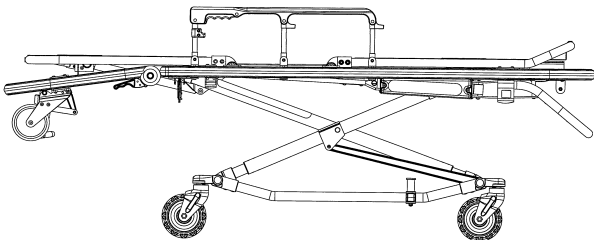

Position 3 – Use for patient transfer/cot rolling.

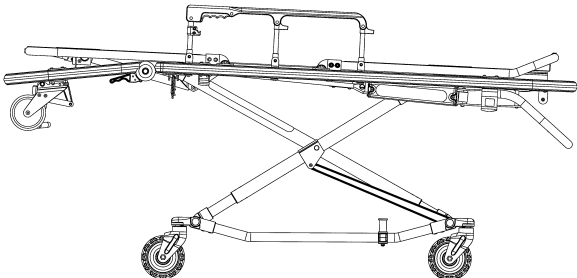

Position 4 – use for patient transfer/cot rolling.

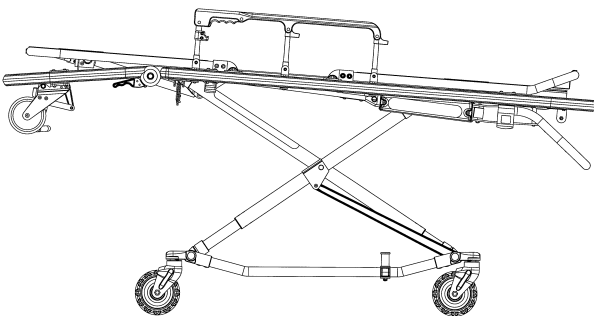

Position 5 – use for patient transfer/cot rolling.

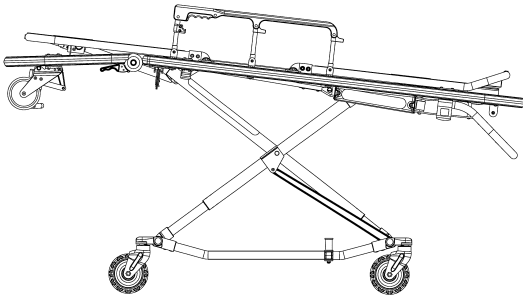

Position 6 – Use for patient transfer/cot rolling.

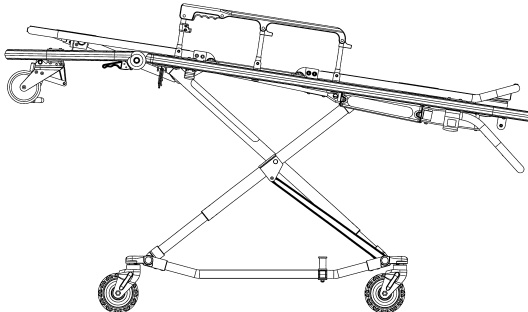

Position 7 – Use for patient transfer/cot rolling/  
vehicle loading.

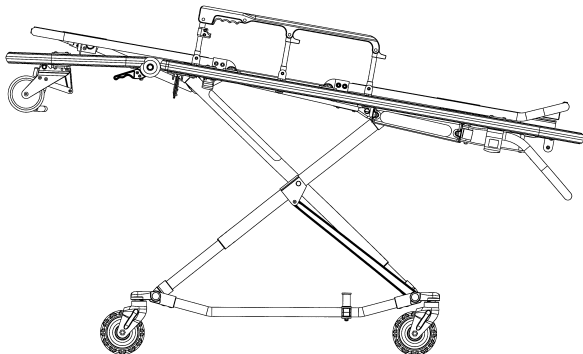

Position 8 – Use for patient transfer/cot rolling/  
vehicle loading.



Use for cot rolling in position 5–8 when space is limited.

# Cot Operation

## Using Restraint Straps



View 1

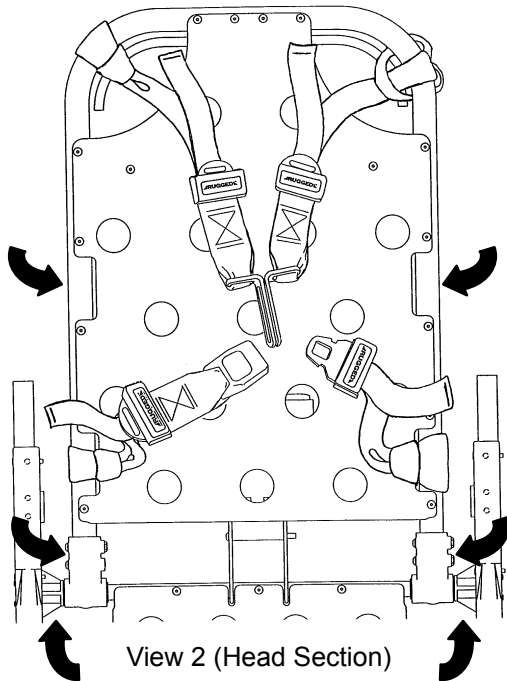

View 2 (Head Section)

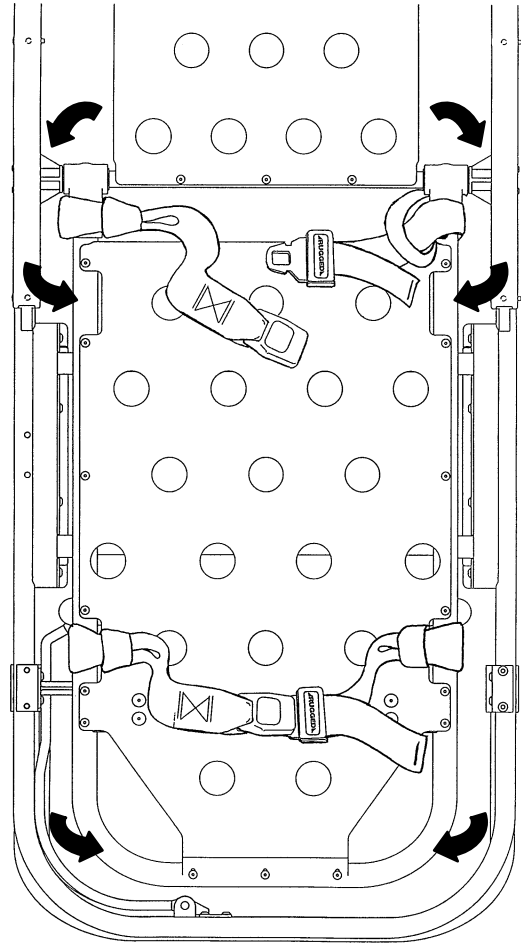

View 3 (Foot Section)

### **WARNING**

Always use all restraint straps to secure the patient on the cot. An unrestrained patient may fall from the cot and be injured.

Always secure the patient on the cot with all the restraint straps. Buckle the restraints across the patient's chest/shoulders, waist and legs (View 1). Keep the restraint straps buckled when the cot is not being used with a patient to avoid damage to the buckles and straps.

When attaching the restraint straps to the cot, keep in mind the attachment points should provide strong anchorage and proper restraint position while not interfering with equipment and accessories. Wrap the strap around the cot frame and back through the loop on the end of the strap as shown in views 2 and 3. The arrows indicate alternate attachment areas.

# Cot Operation

## Using Restraint Straps (Continued)

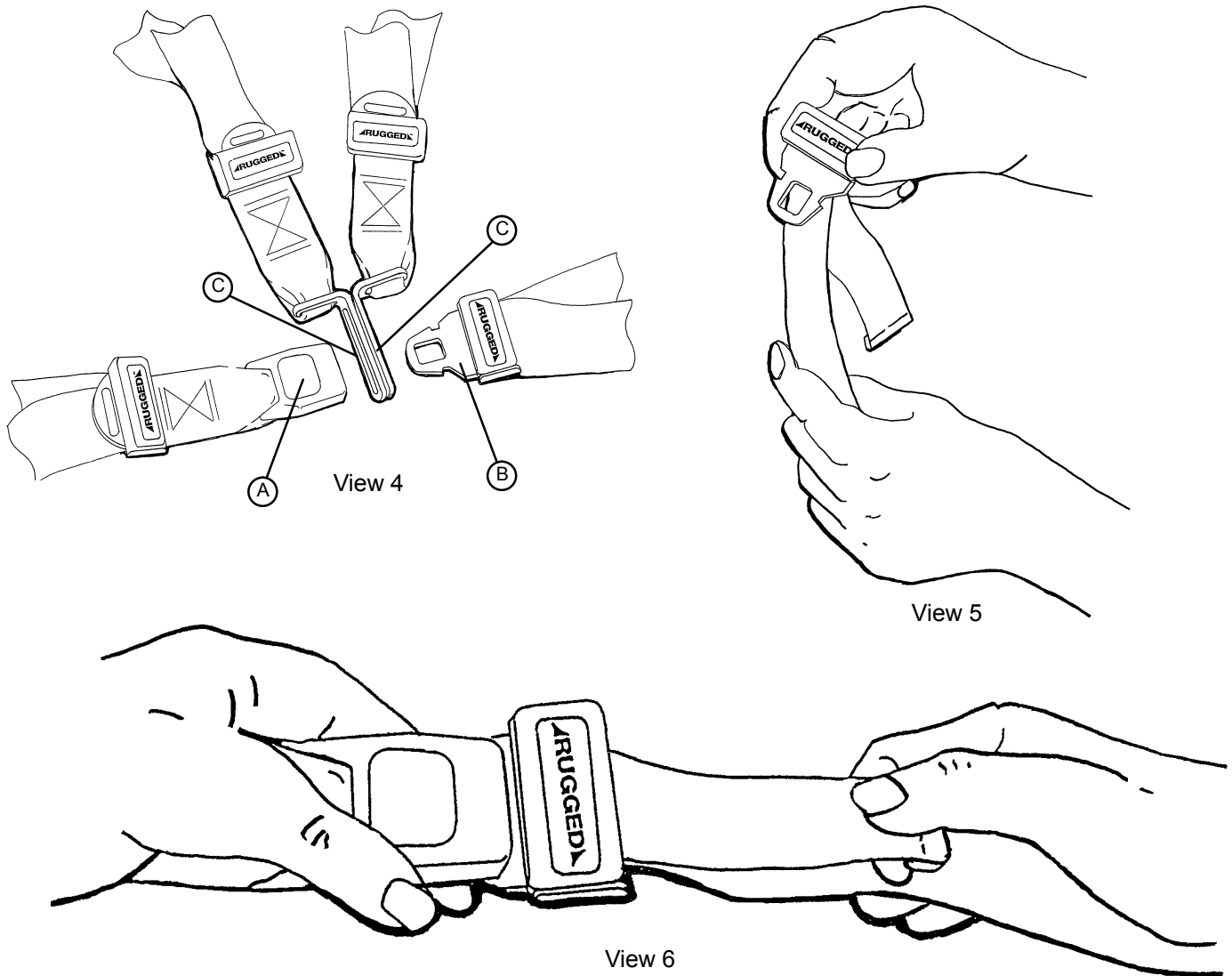

When the cot is put into service, the restraints are opened and placed to either side of the cot until the patient is positioned on the cot mattress. The restraint is lengthened, buckled around the patient and shortened until the required tightness is achieved.

To open the restraint, press the red button (A) on the front of the buckle "receiver". This releases the buckle "tang" (B) which can then be pulled out of the receiver (View 4).

To close the restraint, push the tang into the receiver until a "click" is heard. When fastening the chest restraint be sure the tang passes through both links (C) on the shoulder strap (View 4).

To lengthen the restraint, grasp the buckle tang, turn it at an angle to the webbing, then pull out (View 5). A hemmed tab at the end of the webbing prevents the tang from coming off the strap.

To shorten the restraint, grasp the hemmed tab and pull the webbing back through the tang until the required tightness is achieved (View 6).

Whenever a restraint is buckled on a patient, the attendant should check to be sure the tang is fully engaged and that the extra webbing is not tangled in the cot or hanging loose.

Inspection of the restraints should be done at least once a month (more frequently if used heavily). Inspection should include checking for a bent or broken receiver or tang, torn or frayed webbing, etc. Any restraint showing wear or not operating properly must be replaced immediately.

# Cot Operation

---

## Operating Guidelines

- Use the **▲RUGGED▲** Cot only as described in this manual.
- Read all labels and instructions on the cot before using the cot.
- Use a minimum of two EMT's to operate the cot.
- Do not adjust, roll or load the cot without advising the patient. Stay with the patient and control the cot at all times.
- Always use the restraint straps and keep the siderails up when a patient is on the cot.
- Use properly trained helpers when necessary to control the cot and patient.

## Transferring the Patient to the **▲RUGGED▲** Cot

Roll the cot to the patient. Place the cot beside the patient and raise/lower the cot to the patient's level. Lower the siderails and open the restraint straps. Transfer the patient to the cot using accepted EMS procedures. Use all the restraints to secure the patient to the cot (see page 10 for restraint strap usage instructions). Raise the siderails and adjust the Fowler and leg rest as necessary.

---

### **WARNING**

Always use all restraint straps to secure the patient on the cot. An unrestrained patient may fall from the cot and be injured.

---

## Rolling the **▲RUGGED▲** Cot

Make sure all the restraint straps are securely buckled around the patient (see page 10 & 11 for restraint strap usage instructions). Place the cot in positions 2–8 for rolling (see page 9 for cot positions). When rolling the cot, position an EMT at the foot end and one at the head end at all times.

# Cot Operation

## Loading the **ARUGGED™** Cot into a Vehicle

When loading the cot into a vehicle, an EMT should remember the following important issues:

- There must be a safety hook properly installed in the vehicle so that the bumper does not interfere with the front legs of the base frame. (See page 8 for safety hook installation instructions.)
- The EMT(s) must be able to lift the combined weight of the patient, cot and any other items on the cot.
- The higher the EMT must lift the cot, the more difficult it becomes to hold the weight. The EMT may need help loading the cot into a vehicle if he/she is too short or if the patient is too heavy for the EMT to lift safely.

The EMT must be able to lift the cot high enough for the cot's legs to unfold completely and lock when the cot is unloaded. A shorter EMT will have to raise his/her arms higher to enable the undercarriage to unfold.

Place the cot in a loading position (position 7 or 8 – see page 9). Roll the cot to the open door of the patient compartment. Fold vehicle bumper to raised position (if available).

Push the cot forward until the loading wheels are on the patient compartment floor and the safety bar passes the safety hook.

### **WARNING**

Failure to use the safety hook can cause injury to the patient or operator. Install and use the safety hook as described in this manual.

EMT 1 – Grasp the cot frame at the foot end. Lift the foot end of the cot until the cot base frame is **off the ground**. Squeeze and hold the release handle (location A or B).

EMT 2 – Grasp the base frame where indicated (location C). Raise and hold the undercarriage until it stops in its uppermost position.

Both EMT's – Push the cot into the patient compartment, engaging the cot fastener (not included).

### **NOTE**

Loose items or debris on the patient compartment floor can interfere with the operation of the safety hook and cot fastener. Keep the patient compartment floor clear.

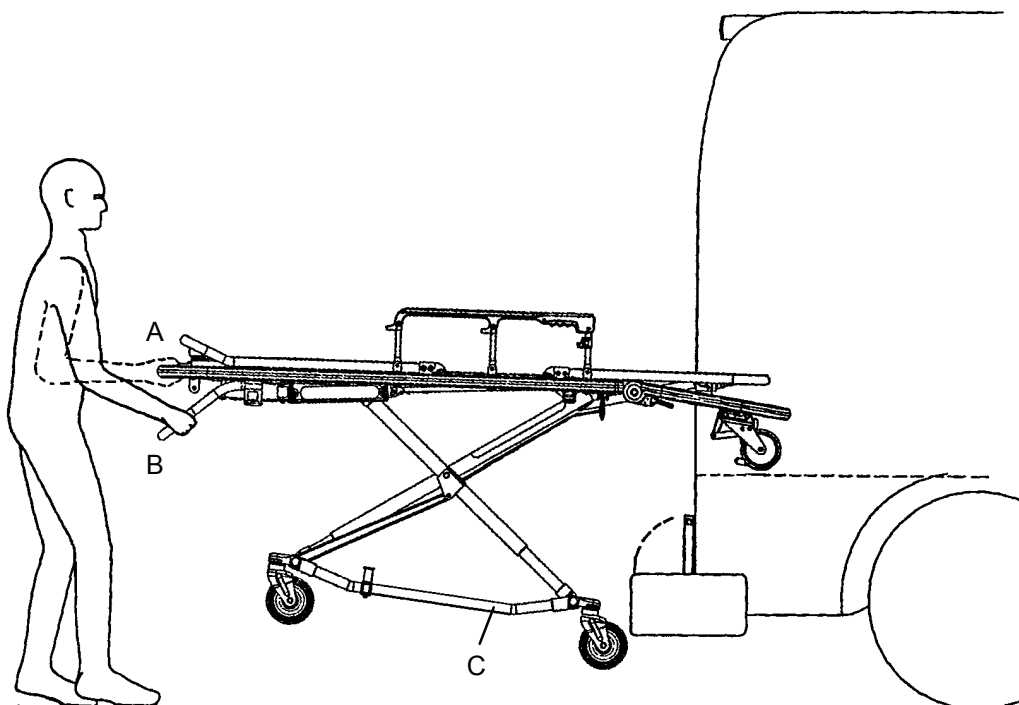

# Cot Operation

---

## Unloading the Cot from a Vehicle

Disengage the cot from the cot fastener.

EMT 1 – Grasp the cot frame. Pull the cot from the patient compartment until the safety bar engages the safety hook.

---

### **WARNING**

Failure to use the safety hook can cause injury to the patient or operator. Install and use the safety hook as described in this manual.

---

EMT 2 – Grasp the base frame where indicated, lift slightly, and lower the base frame to its fully extended position while EMT 1 squeezes and holds the release handle.

EMT 1 – Let go of the release handle and be sure the undercarriage locks into place.

EMT 2 – Disengage the safety bar from the safety hook by pushing the safety release lever forward.

Remove the cot from the vehicle. Place the cot in a rolling position (positions 2–8 – see page 9).

---

### **WARNING**

Be sure the undercarriage has engaged before removing the loading wheels from the patient compartment floor of the vehicle. An unlocked undercarriage will not support the cot and injury to the patient or operator could result.

---

# Cot Operation

## Changing Cot Height

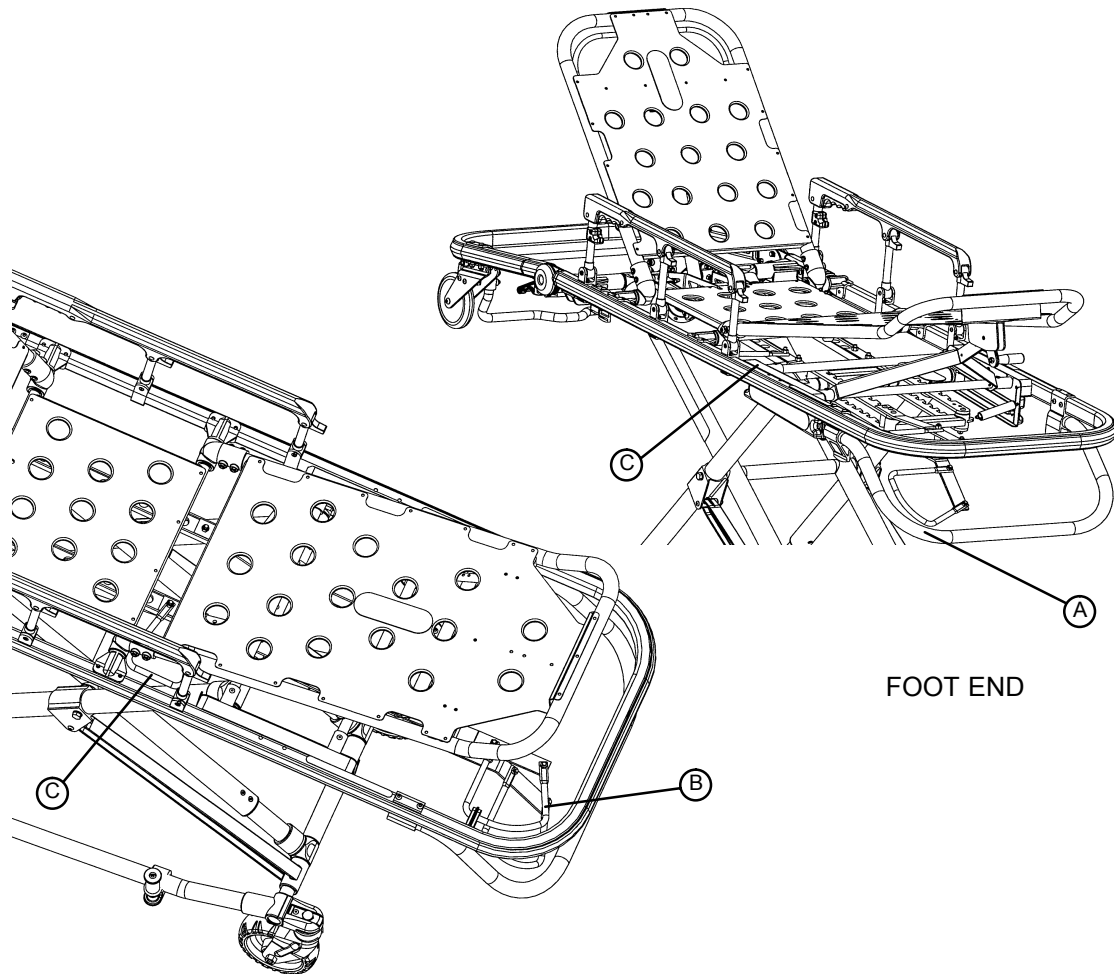

### NOTE

Changing the cot height requires a minimum of two EMT's, positioned at both ends or on each side of the cot. Each EMT must grasp the cot frame securely.

**To lower the cot from the ends**, the EMT at the foot end of the cot positions his/her hands so the release handle (A or B) can be squeezed while a secure grip is maintained on the cot frame or lifting bar. Both EMT's must lift the cot until the weight is off the latching mechanism (approximately 1/4"). The EMT at the foot end squeezes and holds the release handle and both EMT's then raise or lower the cot together. The handle is released when the desired position is reached. Both EMT's should maintain a secure grip on the litter frame until the latching mechanism is securely locked into position.

**To lower the cot from the sides**, the EMT on the patient's right positions his/her hands so he/she can reach the release handle at the midpoint of the litter (C). Both EMT's must lift the cot until the weight is off the latching mechanism (approximately 1/4"). The EMT at the patient's right squeezes and holds the release handle. Both EMT's then raise or lower the cot together. The handle is released when the desired position is reached. Both EMT's should maintain a secure grip on the litter frame until the latching mechanism is securely locked into position.

### WARNING

Grasping the **ARUGGED™** Cot improperly can cause injury. Grasp only the litter frame or the lifting bar to lift the cot. Keep hands/fingers away from moving parts.



# Cot Operation

---

## Adjusting Leg Rest (Model 6070)

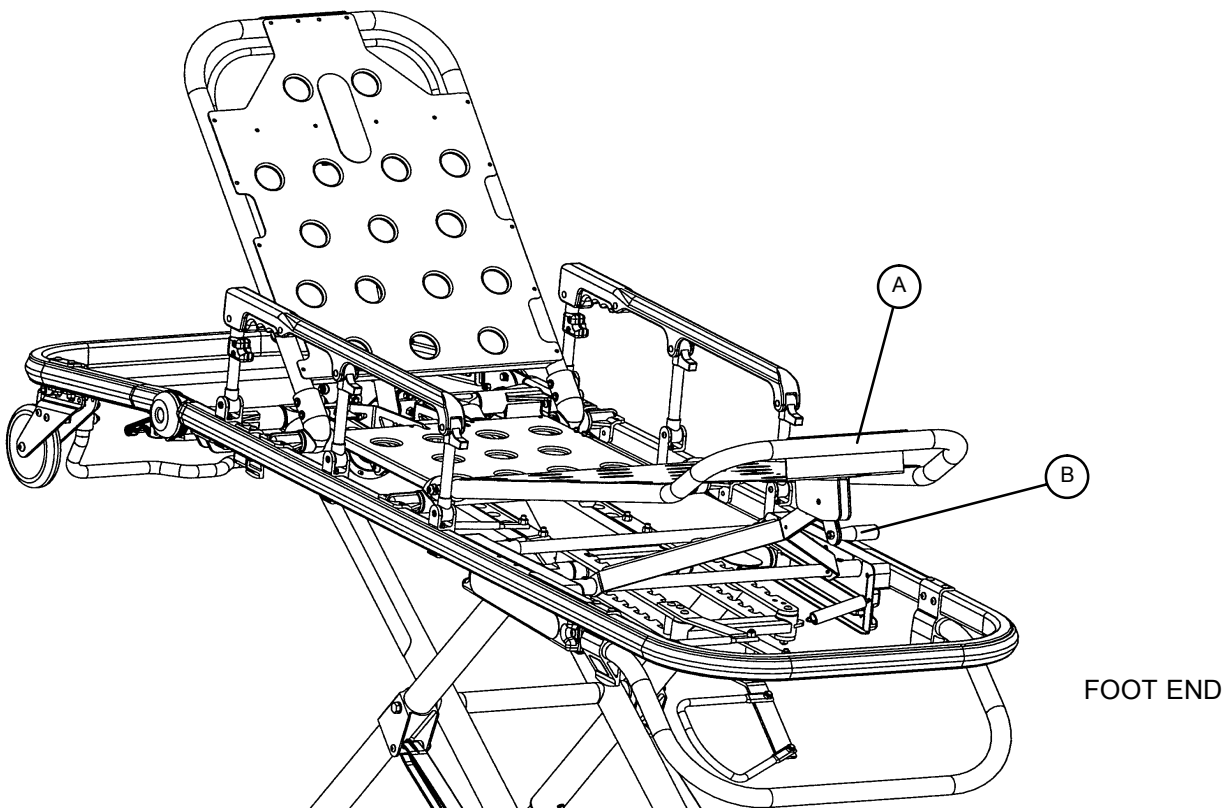

The leg rest is adjustable to allow for elevation of the patient's legs.

**To raise the leg rest**, lift the leg rest frame (A) as high as possible. The support bracket will engage automatically. Release the frame after the support bracket has engaged.

**To lower the leg rest**, lift the leg rest frame (A) and, while holding the frame, lift up on the release handle (B) until the bracket disengages. Lower the leg rest until flat.

# Cot Operation

---

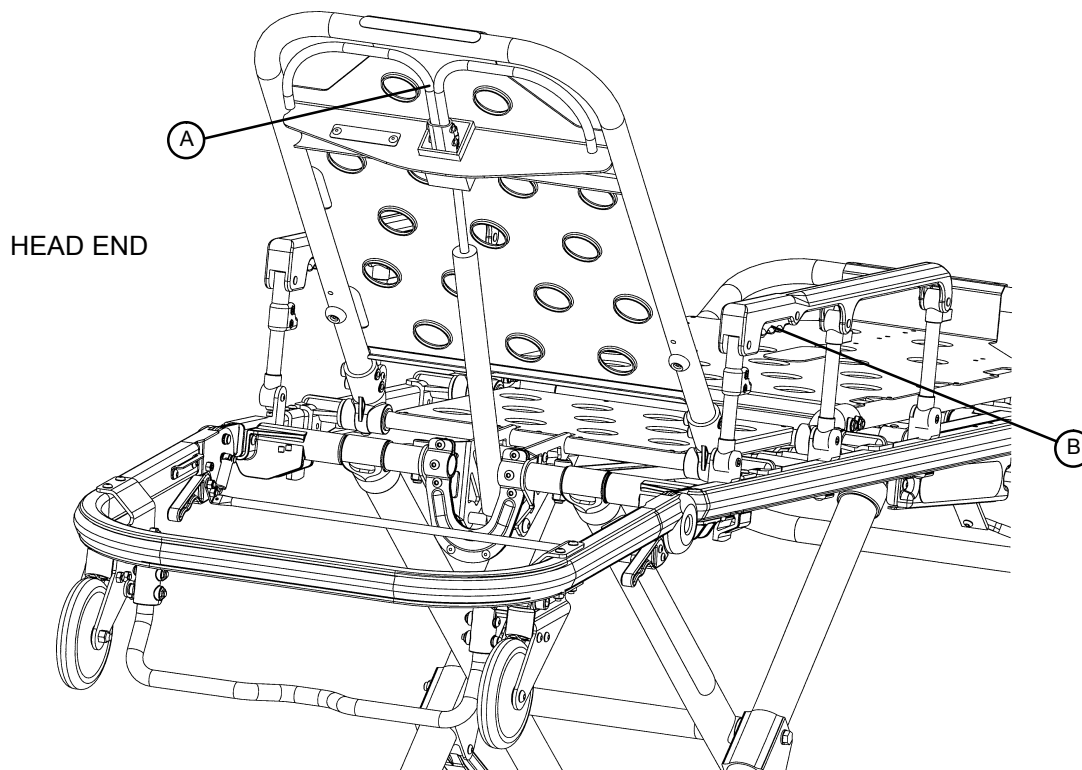

## Operating Fowler

**To raise**, squeeze handle (A) for pneumatic assist in lifting the Fowler to the desired height. Remove hand(s) from handle when desired height is achieved.

**To lower**, squeeze handle (A) and push down on the Fowler frame until the Fowler has reached the desired height. Remove hand(s) from handle when desired height is achieved.

## Operating Siderails

**To raise**, lift up until the latch clicks and the siderail locks into place. When a patient is on the cot, always keep the siderails in the raised position unless the patient is being transferred.

**To lower**, squeeze handle (B) to release the siderail latch. Guide the siderail down toward the foot end until flat.

# Cot Operation

---

## Operating Break-away Head Section

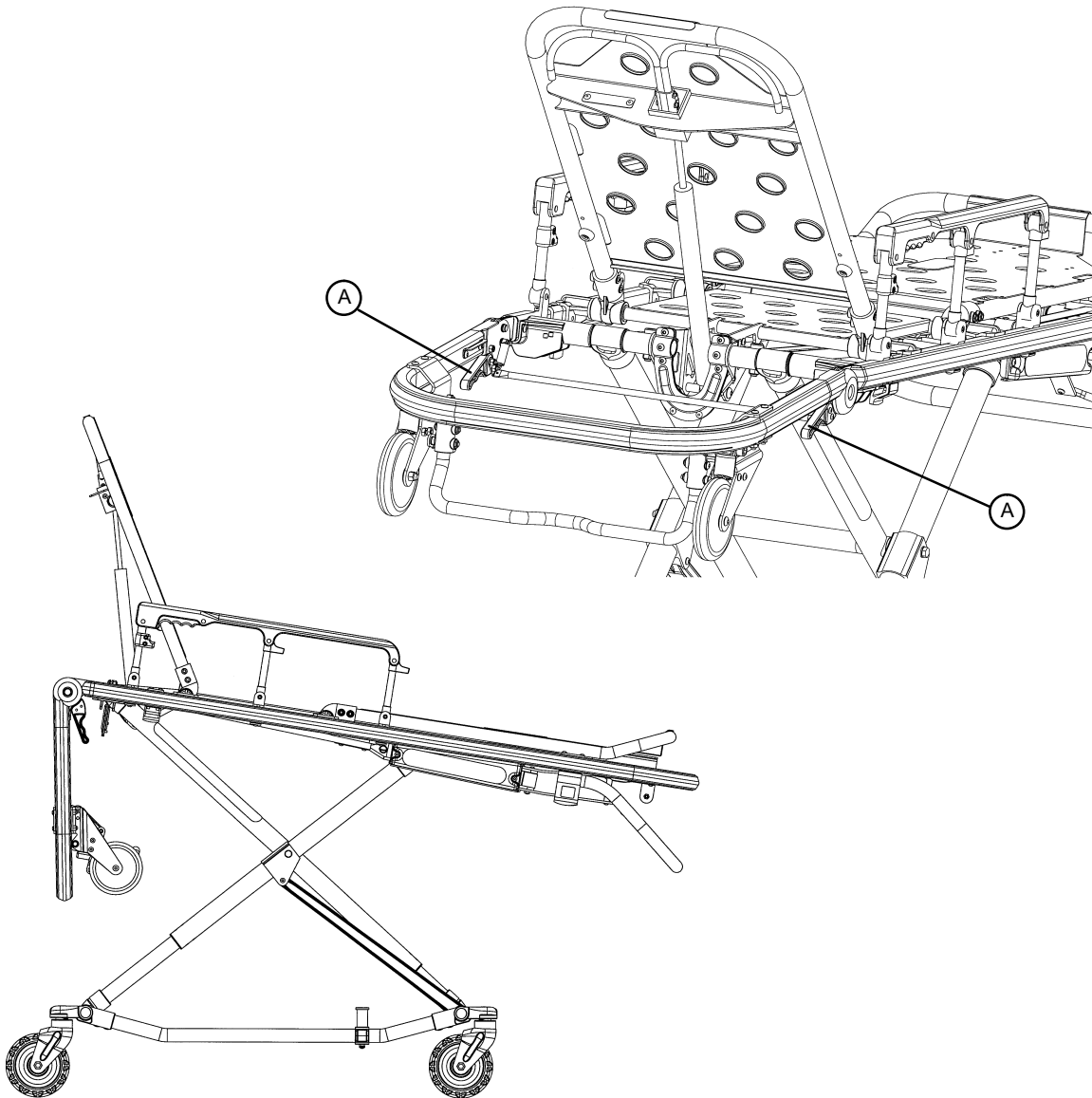

The head end of the cot litter folds down to shorten the length of the cot and allow for maneuvering when space is limited in elevators, halls, etc.

The break-away head section should only be used when the cot is in positions 5–8 (see page 9).

**To lower the break-away head section**, raise the Fowler to its uppermost position (see page 17 for Fowler operation instructions). Squeeze either red release handle (A) at the head end of the cot with one hand while supporting the head section with the other hand. Lower the head section.

**To raise the break-away head section**, lift the break-away head section until the release handles click and the head section locks into place.

---

### CAUTION

Damage to the cot can occur if the cot is lowered in the shortened position. Use only positions 5–8 (see page 9) when the cot is shortened.

# Cot Operation

---

## Operating 2-Stage I.V. Pole

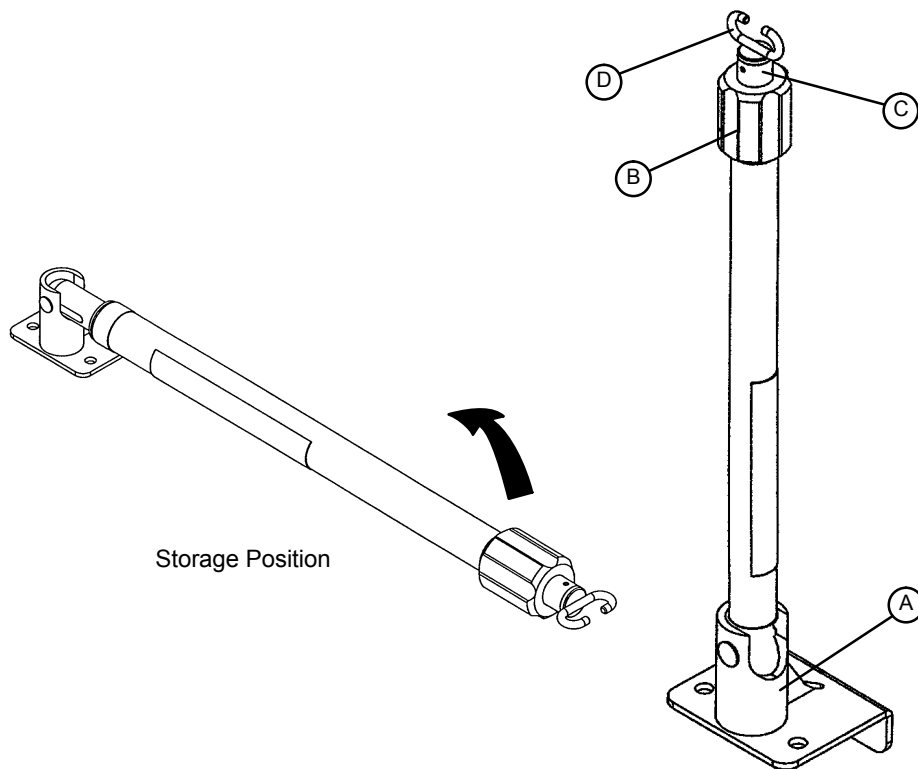

1. Lift and pivot the pole from the storage position and push down until it is locked into receptacle (A).
2. To raise the height of the pole, turn the lock actuator (B) counterclockwise and pull up on the telescoping portion (C) of the pole to raise it to the desired height.
3. Turn the lock actuator (B) clockwise to lock the telescoping portion in place.
4. Hang I.V. bags on the I.V. hook (D).

---

### CAUTION

The weight of the I.V. bags should not exceed 40 pounds.

---

# Cot Operation

## Operating 3-Stage I.V. Pole

1. Lift and pivot the pole from the storage position and push down until it is locked into receptacle (A).
2. To raise the height of the pole, turn the lock actuator (B) counterclockwise and pull up on the bottom telescoping portion (C) of the pole to raise it to the desired height.
3. Turn the lock actuator (B) clockwise to lock the bottom telescoping portion in place.
4. For a higher I.V. pole, pull up on section (D) until the spring clip (E) engages.
5. Hang I.V. bags on the I.V. hook (F).

### CAUTION

The weight of the I.V. bags should not exceed 40 pounds.

6. To lower the I.V. pole, push in on the spring clip (E) and slide section (D) down into section (C). Turn the lock actuator (B) counterclockwise and slide section (C) into the bottom tube.
7. Lift up and pivot the pole down into the storage position.

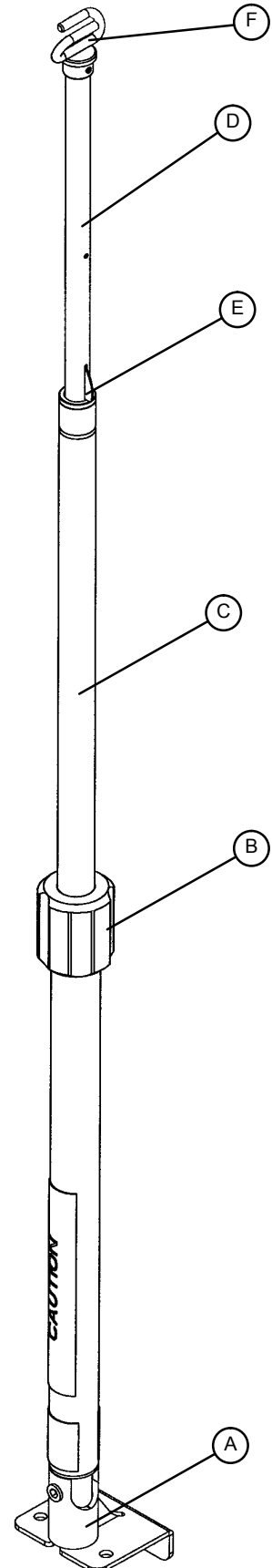
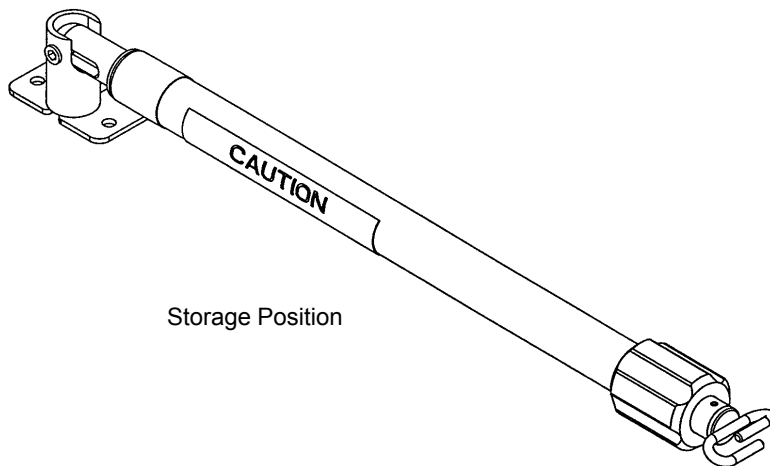

# Preventative Maintenance

---

## CLEANING

1. Hand wash all surfaces of the bed with warm water and mild detergent. Dry thoroughly.
2. Clean Velcro **AFTER EACH USE**. Saturate Velcro with disinfectant and allow disinfectant to evaporate. (Appropriate disinfectant for nylon Velcro should be determined by the hospital.)

## NOTE

Quaternary Germicidal Disinfectants, used as directed, and/or Chlorine Bleach products, typically 5.25% Sodium Hypochlorite in dilutions ranging between 1 part bleach to 100 parts water, and 2 parts bleach to 100 parts water are not considered mild detergents. These products are corrosive in nature and may cause damage to your stretcher if used improperly. If these types of products are used to clean Stryker patient handling equipment, measures must be taken to insure the stretchers are rinsed with clean water and thoroughly dried following cleaning. Failure to properly rinse and dry the stretchers will leave a corrosive residue on the surface of the stretcher, possibly causing premature corrosion of critical components. Failure to follow the above directions when using these types of cleaners may void this product's warranty.

## CHECKLIST

- \_\_\_\_\_ All fasteners secure (reference all assembly prints)
- \_\_\_\_\_ All welds intact, not cracked or broken
- \_\_\_\_\_ No bent or broken tubing or sheet metal
- \_\_\_\_\_ No debris in wheels
- \_\_\_\_\_ All wheels secure and roll and swivel properly
- \_\_\_\_\_ Siderails move and latch properly (see page 17)
- \_\_\_\_\_ Fowler operating properly (see page 17)
- \_\_\_\_\_ Optional I.V. pole intact and operating properly (see page 19 & 20)
- \_\_\_\_\_ Height positioning latch functioning properly
- \_\_\_\_\_ Cot secure in each height position
- \_\_\_\_\_ Undercarriage folds properly
- \_\_\_\_\_ Break-Away head section operating properly
- \_\_\_\_\_ Safety bar operating properly
- \_\_\_\_\_ Foot rest operating properly (Model 6070)
- \_\_\_\_\_ No rips or cracks in mattress cover
- \_\_\_\_\_ Body restraints intact and working properly (see page 10 & 11)

Serial No. \_\_\_\_\_

Completed By: \_\_\_\_\_

Date: \_\_\_\_\_

See page 22 for checklist schedule.

# Preventative Maintenance

---

Operation	Schedule	Procedure
Cleaning & Disinfecting	Each use.	See page 21.
Inspection	For 1–25 calls per month, inspect cot every 6 months.  For 26–200 calls per month, inspect cot every 3 months.  For 201+ calls per month, inspect cot monthly.	See page 21 for checklist.

**NOTE**

Keep up-to-date maintenance records using the form on page 24.

**Parts, Service or Technical Assistance:**

Contact Stryker Customer Service at 1–800–784–4336 or

Stryker Medical  
3800 E. Centre Ave.  
Portage, MI 49002  
ATTN: Customer Service

# Preventative Maintenance

## PNEUMATIC FOWLER ADJUSTMENT

### Required Tools:

1/2" Wrench

5/32" Allen Wrench

Loctite

3/32" Allen Wrench

7/32" Allen Wrench

9/16" Wrench

### Adjustment Procedure:

1. For easier access, move Fowler to 75 degrees.

### NOTE

Before continuing with the Fowler adjustment procedure, be sure the pneumatic cylinder (item A) is completely threaded into the yoke (item B) so no threads are showing on the shaft of the cylinder. If threads are showing, use a 3/32" Allen wrench to remove the set screw (item C) in the center of the yoke and a 7/32" Allen wrench and 9/16" wrench to remove the nut and bolt (items D & E) holding the bottom of the pneumatic cylinder. Thread cylinder shaft (item A) completely into yoke (item B). Replace the nut and bolt (items D & E) and replace the set screw (item C) using Loctite.

2. Using a 1/2" wrench, loosen the hex nut (item F) on the Fowler pivot (item J) while holding the set screw (item H) fixed in the pivot.

3. Using a 5/32" Allen wrench, turn the set screw (item H) until there is no play between the Fowler release handle (item K) and the pneumatic cylinder release button.

4. Be sure the Fowler will travel from flat to at least 75 degrees. If it doesn't, turn the set screw (item H) clockwise 1/2 turn. Repeat until at least 75 degrees of travel is achieved.

5. Lower the Fowler to a 5–10 degree angle and release the handle. Apply approximately 50 pounds downward force to the end of the Fowler. If the Fowler drifts down, turn the set screw (item H) counterclockwise. Repeat until the Fowler does not drift downward.

6. Using the 1/2" wrench, tighten the hex nut (item F) while holding the set screw (item H) fixed in the pivot.

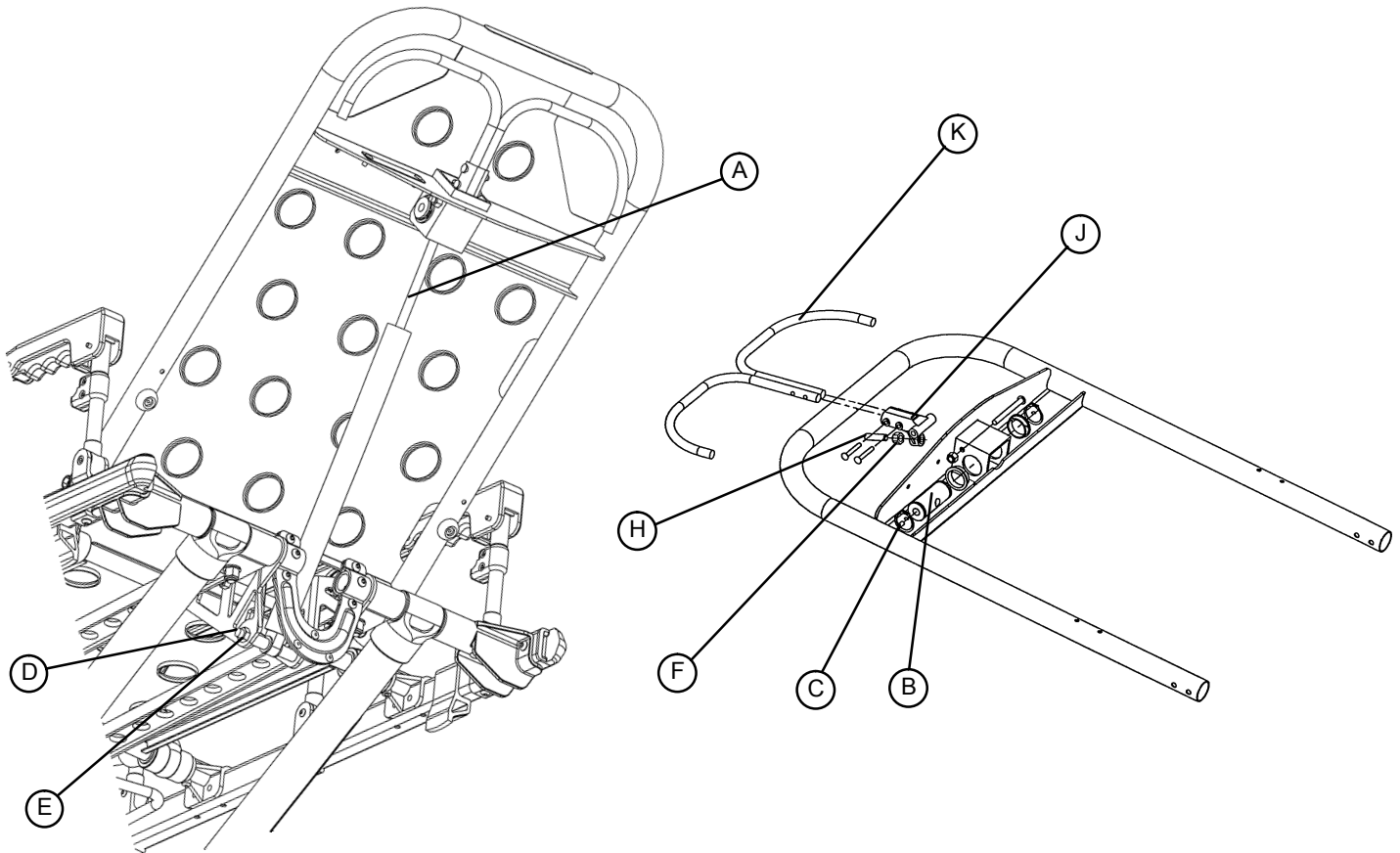









# Cot Assembly (6070)

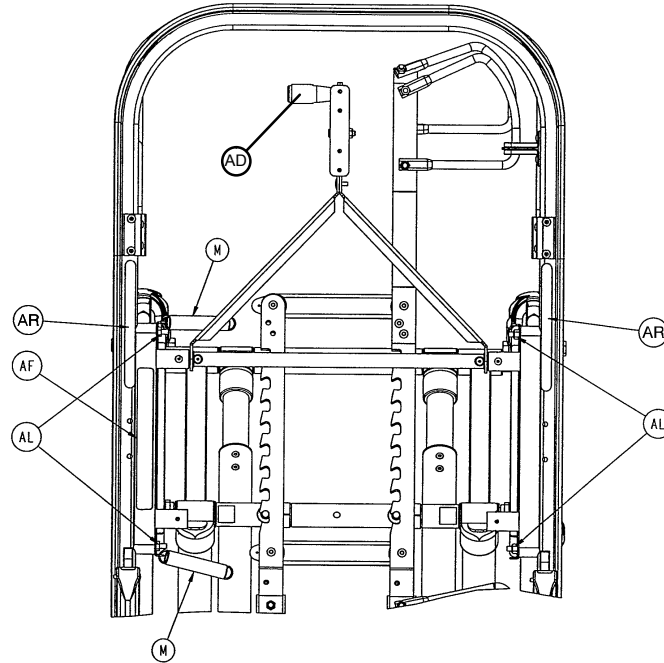

Partial View Showing Placement  
of Labels and Assembly of  
Extension Springs  
(Some Parts Removed for Clarity)

Item	Part No.	Part Name	Qty.	Item	Part No.	Part Name	Qty.
B	4-198	H. Soc. But. Hd. Screw	4	Z	6060-90-2	Serial Number Tag	1
C	4-204	H. Soc. But. Hd. Screw	2	AA	6060-90-3	Large "Rugged" Label	2
D	4-232	H. Soc. But. Hd. Screw	10	AB	6060-90-4	Small "Rugged" Label	2
E	4-240	H. Soc. But. Hd. Screw	1	AC	6060-90-5	"Emerg. Transport" Label	2
F	11-355	Flat Washer	2	AD	6070-90-107	Lift to Release Label	1
G	14-21	Nylon Washer	2	AE	6070-90-36	Specification Label	1
H	16-28	Fiberlock Hex Nut	12	AF	6080-90-9	Warning Label	1
J	16-89	Centerlock Nut	1	AG	6060-90-114	"Hands Clear" Label	4
K	25-79	Dome Hd. Rivet	3	AH	(page 36-39)	Litter Assembly	1
L	37-204	Hole Plug	2	AJ	6070-90-101	"LX" Label	2
M	38-348	Extension Spring	2	AK	6060-37-26	Spacer Plate	2
N	1010-31-77	Gas Cylinder	1	AL	16-78	Centerlock Hex Nut	4
P	(page 30 & 31)	Base Assembly	1	AM	4-197	Hex Soc. B. Hd. Cap Screw	2
R	6060-30-43	Bumper	1	AN	6080-33-36	Retainer Plate Cover, Lt.	1
S	6060-31-39	Lit./Base Intrfce. End Plate	2	AP	6080-33-37	Retainer Plate Cover, Rt.	1
T	6060-31-46	Lit./Base Intrfce. Piv. Spcr.	2	AR	6080-90-106	"500 Lb. Max." Label	2
U	6060-32-46	Adhesive Loop Pile	2	AS	6080-90-108	"Lift Here" Label	2
X	(page 34, 35)	Break-Away Hd. Ass'y	1	AT	25-133	Dome Head Rivet	2
Y	6060-37-35	End Cap	2	AU	6060-31-25	End Plate Supt. Bracket	1

# Cot Assembly (6060)

Assembly part number 6060-50-11

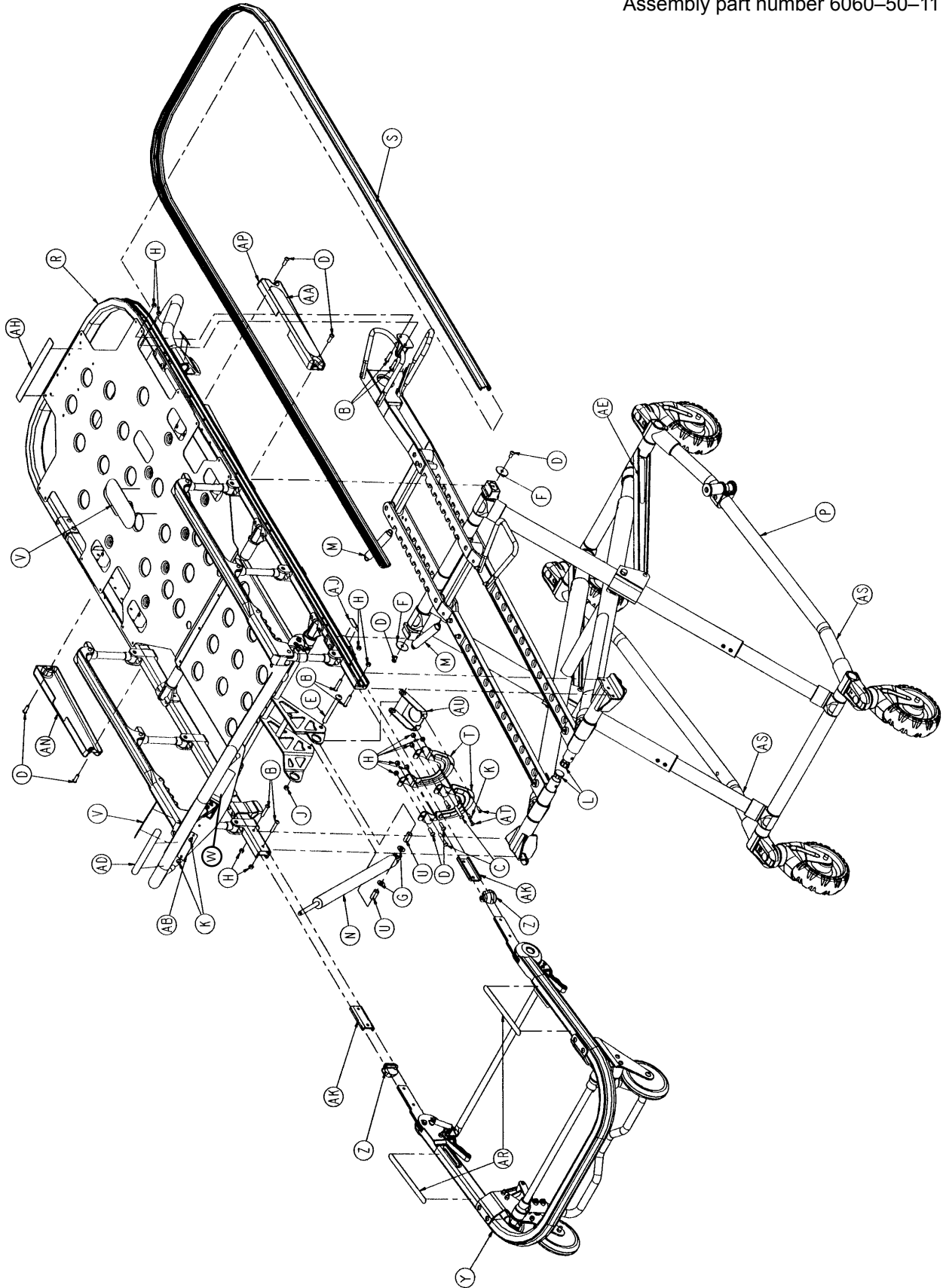

# Cot Assembly (6060)

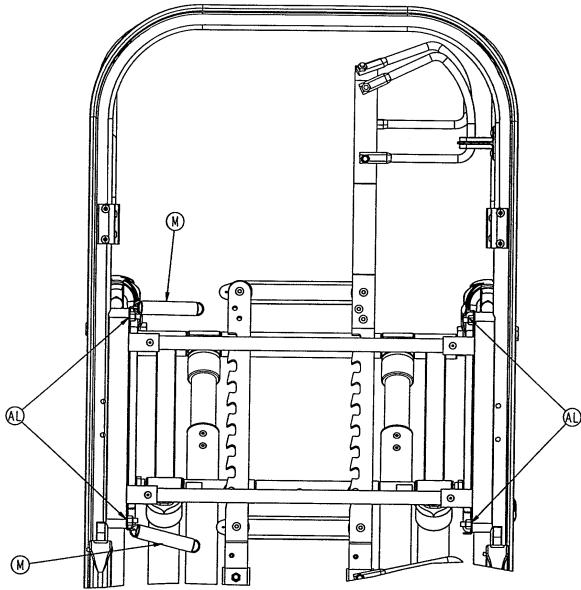

Partial View Showing Assembly of Extension Springs  
(Some Components Removed For Clarity)

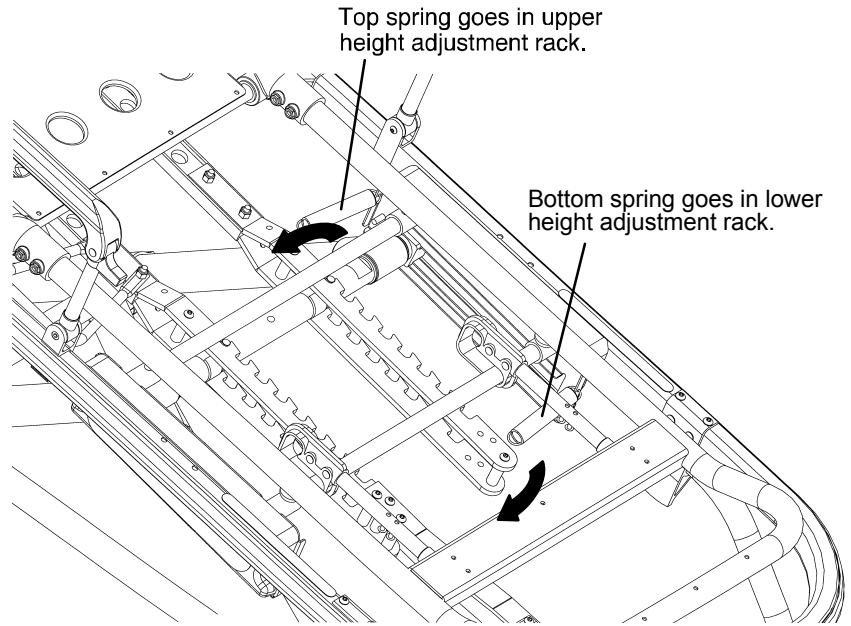

View Showing Assembly of Extension Springs

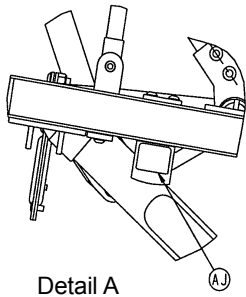

Detail A

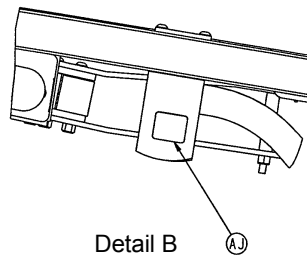

Detail B

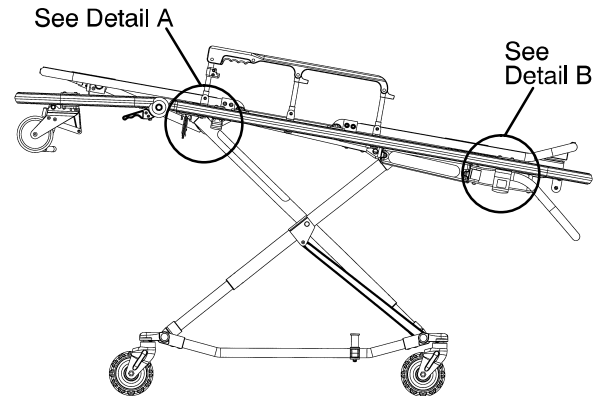

Item	Part No.	Part Name	Qty.	Item	Part No.	Part Name	Qty.
B	4-198	H. Soc. But. Hd. Screw	4	Y	(page 34, 35)	Break-Away Hd. Ass'y	1
C	4-204	H. Soc. But. Hd. Screw	2	Z	6060-37-35	End Cap	2
D	4-232	H. Soc. But. Hd. Screw	10	AA	6060-90-101	"DX" Label	2
E	4-240	H. Soc. But. Hd. Screw	1	AB	6060-90-2	Serial Number Tag	1
F	11-355	Flat Washer	2	AC	6060-90-3	Large "Rugged" Label	2
G	14-21	Nylon Washer	2	AD	6060-90-4	Small "Rugged" Label	1
H	16-28	Fiberlock Hex Nut	12	AE	6060-90-5	"Emerg. Transport" Label	2
J	16-89	Centerlock Nut	1	AH	6080-90-9	Warning Label	1
K	25-79	Dome Hd. Rivet	3	AJ	6060-90-114	"Hands Clear" Label	4
L	37-204	Hole Plug	2	AK	6060-37-26	Spacer Plate	2
M	38-348	Extension Spring	2	AL	16-78	Centerlock Hex Nut	4
N	1010-31-77	Gas Cylinder	1	AM	4-197	Hex Soc. B. Hd. Cap Screw	2
P	(page 30 & 31)	Base Assembly	1	AN	6080-33-36	Retainer Plate Cover, Lt.	1
R	(page 40-42)	Litter Assembly	1	AP	6080-33-37	Retainer Plate Cover, Rt.	1
S	6060-30-43	Bumper	1	AR	6080-90-106	"500 Lb. Max." Label	2
T	6060-31-39	Lit./Base Intrfce. End Plate	2	AS	6080-90-108	"Lift Here" Label	2
U	6060-31-46	Lit./Base Intrfce. Piv. Sprc.	2	AT	25-133	Dome Head Rivet	2
V	6060-32-46	Adhesive Loop Pile	2	AU	6060-31-25	End Plate Supt. Bracket	1
W	6060-90-35	Specification Label	1				

# Base Assembly

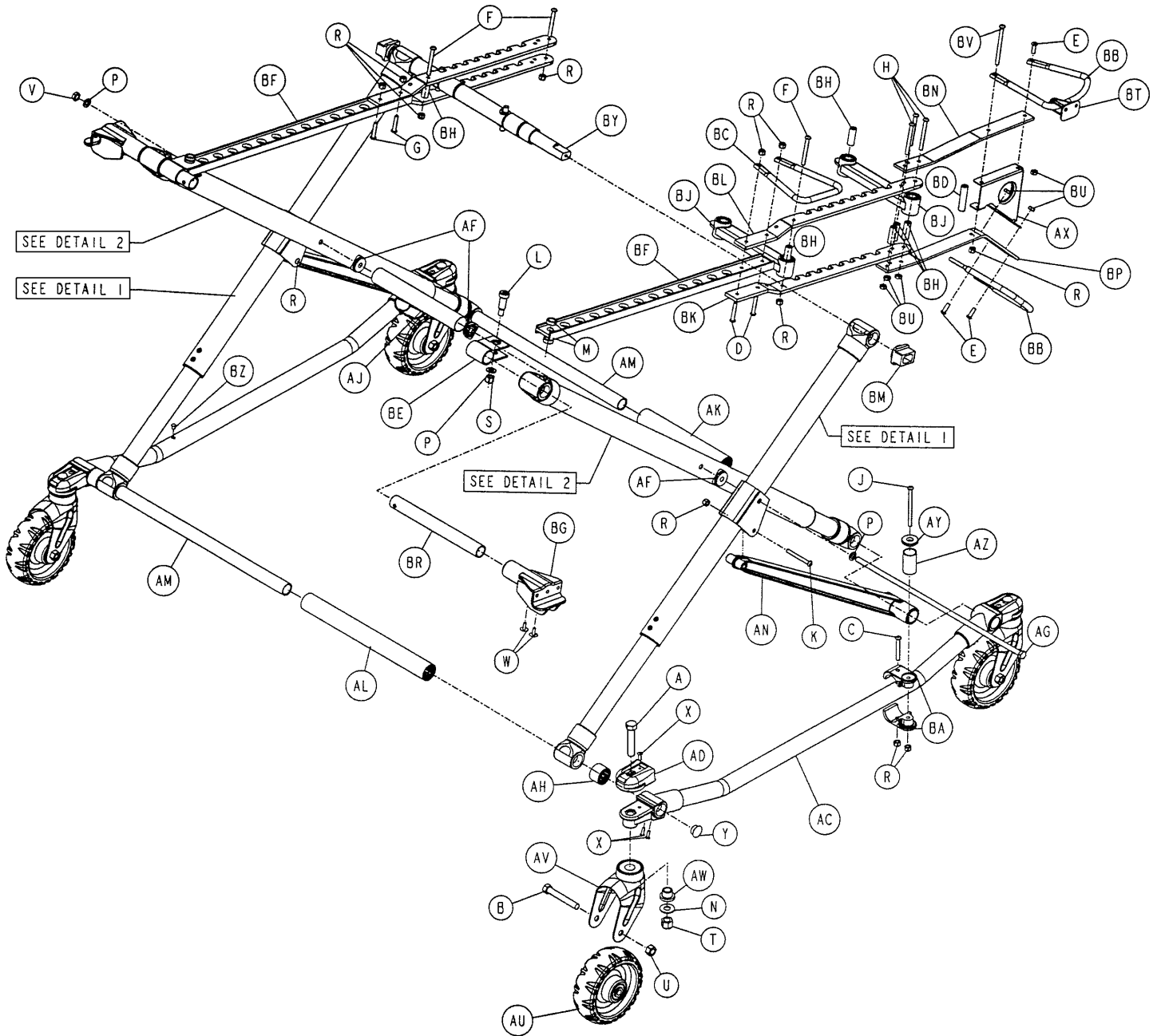

Item	Part No.	Part Name	Qty.	Item	Part No.	Part Name	Qty.
A	3-204	Hex Hd. Cap Screw	4	J	4-235	H. Soc. But. Hd. Cap Scr.	1
B	3-205	Hex Hd. Cap Screw	4	K	8-28	Soc. Hd. Shoulder Bolt	2
C	4-97	H. Soc. But. Hd. Cap Scr.	1	L	8-45	Hex Soc. Shldr. Screw	2
D	4-135	H. Soc. But. Hd. Cap Scr.	2	M	11-350	Nylon Washer	4
E	4-161	H. Soc. But. Hd. Cap Scr.	3	N	11-364	Flat Washer	4
F	4-163	H. Soc. But. Hd. Cap Scr.	3	P	11-4	Flat Washer	4
G	4-198	H. Soc. But. Hd. Cap Scr.	2	R	16-28	Fiberlock Hex Nut	12
H	4-234	H. Soc. But. Hd. Cap Scr.	3	S	16-35	Nylock Hex Nut	2

# Base Assembly

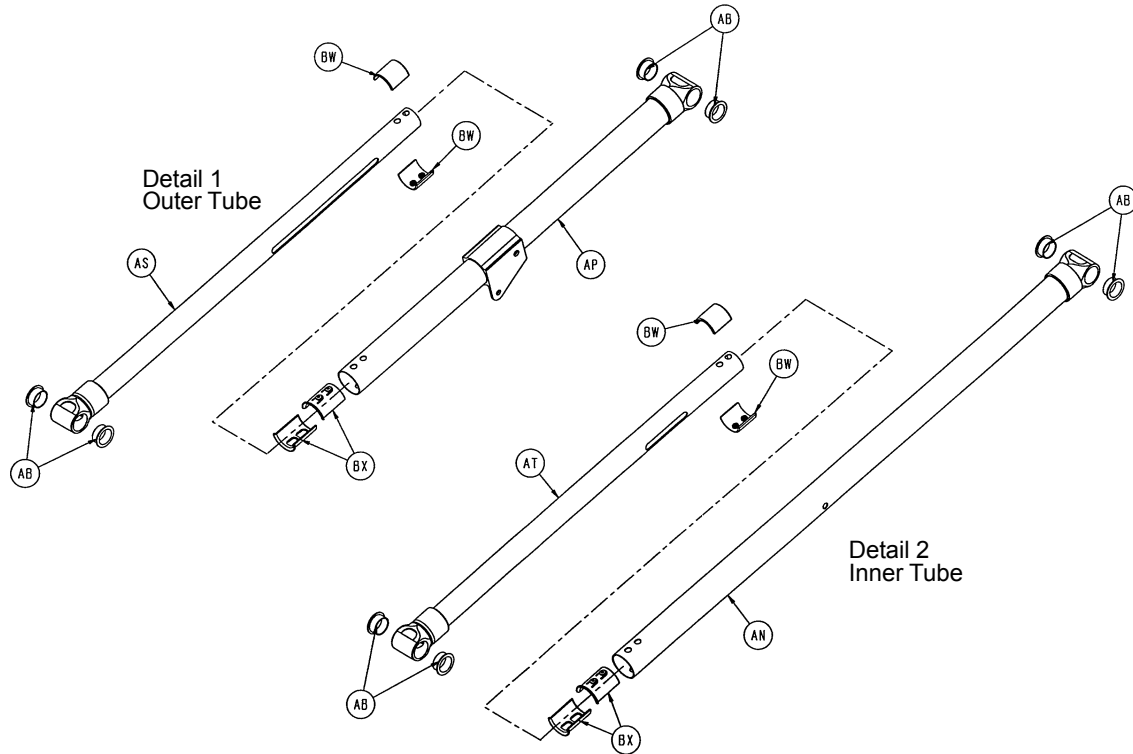

Item	Part No.	Part Name	Qty.	Item	Part No.	Part Name	Qty.
T	16-57	Fiberlock Hex Nut	4	AX	6060-208-3	Handle Brace	1
U	16-60	Centerlock Nut	4	AY	6060-4-43	Retaining Post Cap	1
V	16-89	Centerlock Nut	1	AZ	6060-4-44	Retaining Post Tube	1
W	25-128	Flange Rivet	4	BA	6060-4-45	Retaining Post C-Clamp	2
X	25-133	Dome Hd. Rivet	12	BB	6060-5-25	Latch Handle	2
Y	37-204	Hole Plug	4	BC	6060-5-26	Side Release Handle	1
AB	81-244	Flange Bearing	16	BD	6060-208-2	Handle Spacer	1
AC	6060-1-15	Outer Base Tube Ass'y	2	BE	6060-5-29	Ht. Adj. Rack Mtg. Pivot	2
AD	6060-1-21	Caster Mount Cover	4	BF	6060-5-32	Height Adjustment Bar	2
AF	6060-1-27	Connecting Rod Bearing	4	BG	6060-5-34	Lit./Base Adapter Mtg. Brkt.	2
AG	6060-1-28	Connecting Rod	1	BH	6060-5-37	Spacer Link Spacer	6
AH	6060-1-29	Outer Base Spacer, Head	2	BJ	6060-5-38	Spacer Link	2
AJ	6060-1-30	Center Base Spacer	1	BK	6060-5-42	Lower Height Adj. Rack	2
AK	6060-1-31	Inner Base Spacer, Foot	1	BL	6060-5-43	Upper Height Adj. Rack	2
AL	6060-1-32	Inner Base Spacer, Head	1	BM	6060-5-44	Lock Bar Slide Bearing	2
AM	6060-1-43	Base Tube, Head/Foot	2	BN	6060-5-47	Top Mounting Bracket	1
AN	6060-1-46	Support Link	2	BP	6060-5-48	Bottom Mounting Bracket	1
AP	6060-1-53	Outer Lift Tube Wldmt.	2	BR	6060-5-51	Lit./Base Adapter Piv. Tube	2
AR	6060-1-55	Inner Lift Tube Wldmt.	2	BT	6060-33-41	Retainer Bracket	1
AS	6060-1-57	Outer Lift Tube Wldmt.	2	BU	16-78	Centerlock Nut	6
AT	6060-1-59	Inner Lift Tube Wldmt.	2	BV	4-218	H. Soc. But. Hd. Cap Scr.	1
AU	(page 32)	Wheel Assembly	4	BW	6060-1-70	Upper Frame Tube Brg.	8
AV	6060-2-12	Caster Horn Assembly	4	BX	6060-1-71	Lower Frame Tube Brg.	8
AW	6060-2-40	Caster Swivel Bushing	4	BY	(page 33)	Lock Bar Assembly	1
				BZ	721-31-65	Hole Plug	1



# Wheel Assembly

Assembly part number  
6060-2-10

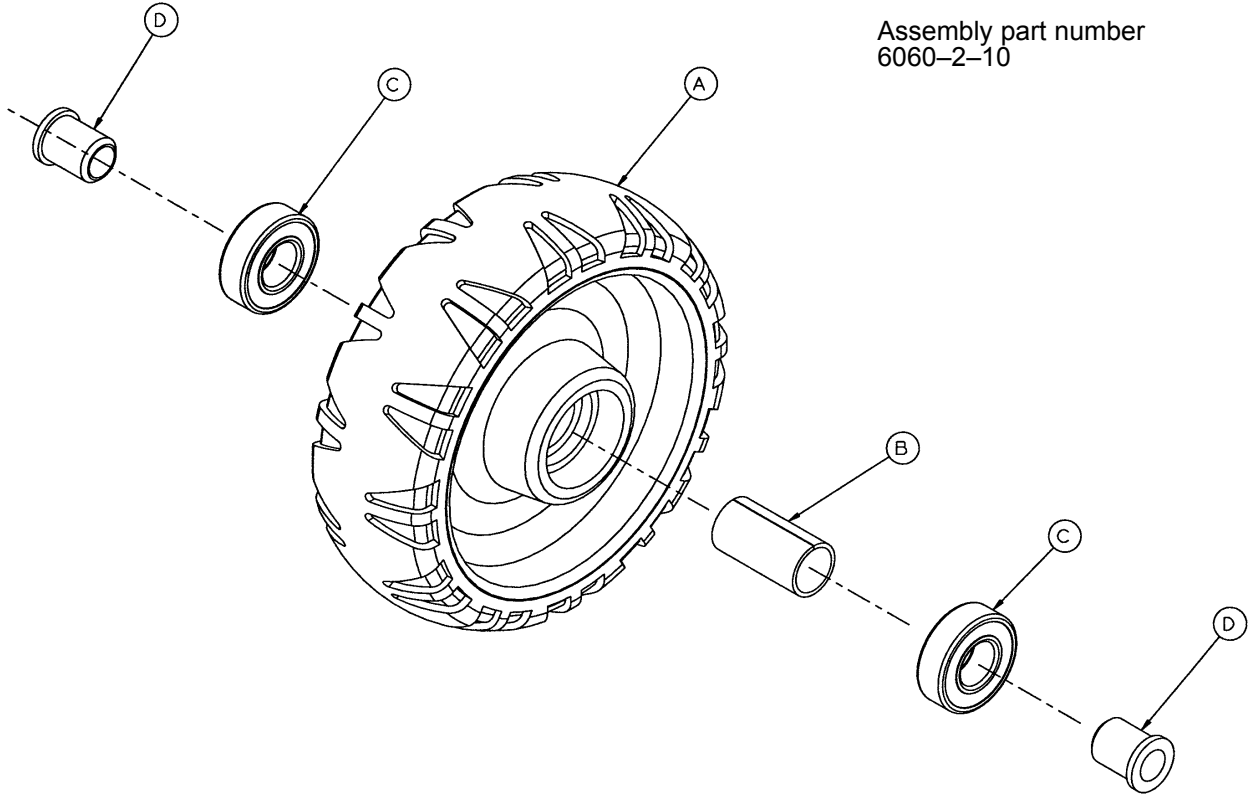

Item	Part No.	Part Name	Qty.
A	6060-2-45	Molded Wheel	1
B	6060-2-46	Bearing Spacer	1
C	81-226	Bearing	2
D	715-1-255	Wheel Bushing	2

# 6080-5-56 Lock Bar Assembly

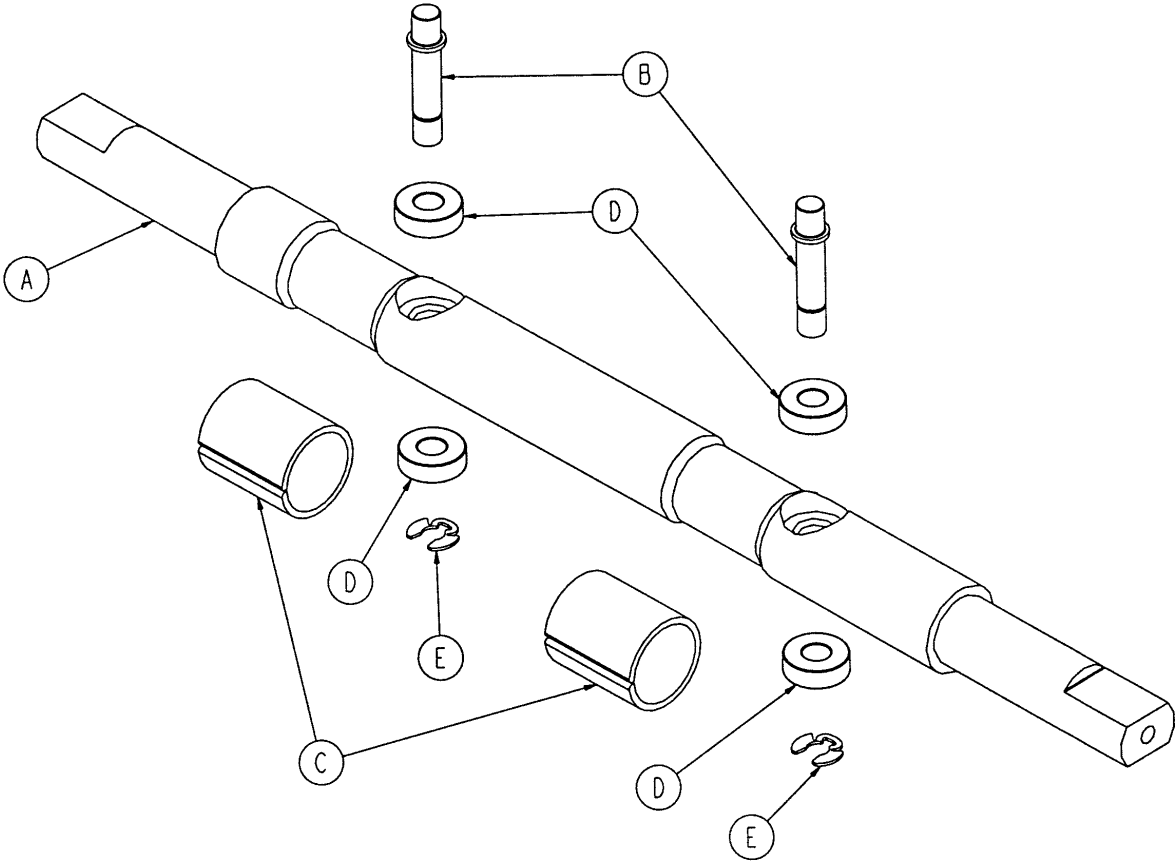

Item	Part No.	Part Name	Qty.
A	6080-5-55	Lock Bar	1
B	6060-5-96	Latch Pin	2
C	6080-5-36	Wear Ring	2
D	81-248	Bearing	4
E	28-181	Retaining Ring	2



# Break-Away Head End Assembly

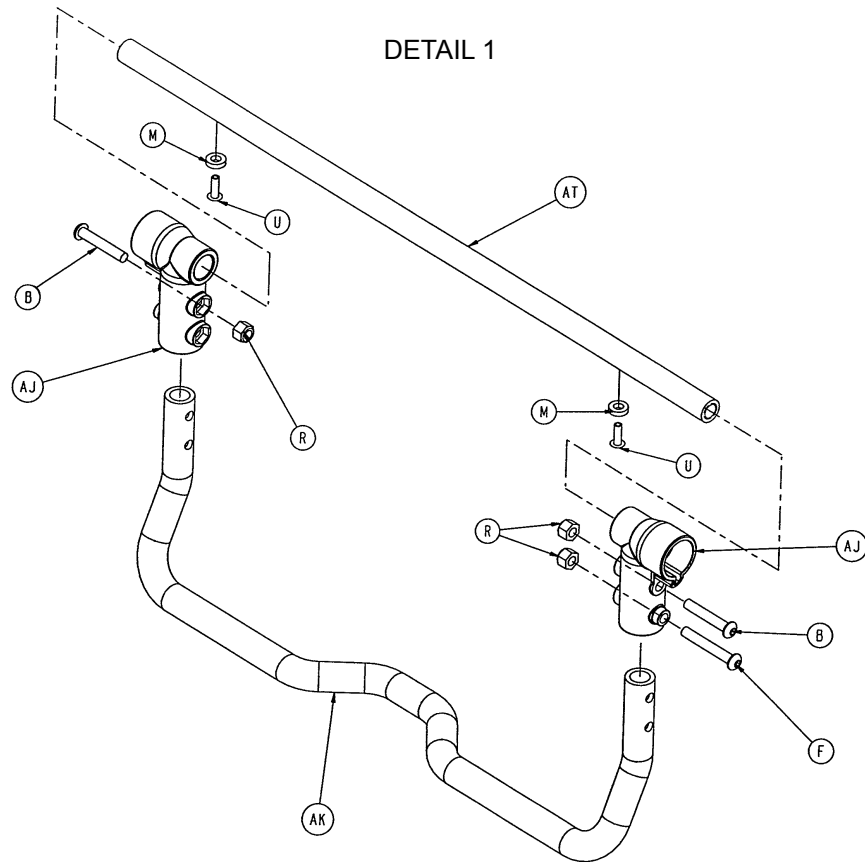

Item	Part No.	Part Name	Qty.	Item	Part No.	Part Name	Qty.
A	4-104	Hex Soc. But. Hd. Cap Scr.	2	AG	6060-36-45	Outer Rail	1
B	4-135	Hex Soc. But. Hd. Cap Scr.	5	AH	6060-36-46	Bent Crossbar	1
C	4-136	Pan Hd. Mach. Screw	1	AJ	6060-37-21	Safety Hook Pivot	2
D	4-163	Hex Soc. But. Hd. Cap Scr.	4	AK	6060-37-22	Safety Hook Tube	1
E	4-197	Hex Soc. But. Hd. Cap Scr.	6	AL	6060-37-26	Pivot Spacer Plate	2
F	4-204	Hex Soc. But. Hd. Cap Scr.	4	AM	6060-37-27	Outer Caster Horn, Left	1
G	4-222	Hex Soc. But. Hd. Cap Scr.	6	AN	6060-37-28	Outer Caster Horn, Right	1
J	4-284	Soc. Hd. Cap Screw	2	AP	6060-37-29	Inner Caster Horn, Left	1
K	11-65	Flat Washer	1	AR	6060-37-30	Inner Caster Horn, Right	1
L	6060-37-44	Wear Gasket	4	AS	6060-37-33	Horn Stop Block	2
M	14-67	Nylon Flat Washer	2	AT	6060-37-34	Safety Hook Pivot Tube	1
P	16-3	Fiberlock Hex Nut	6	AU	6060-37-36	Trigger Lock Spacer	2
R	16-28	Fiberlock Hex Nut	15	AV	6060-37-37	Pivot Cover, Right	1
S	16-36	Nylock Hex Nut	2	AW	6060-37-38	Pivot Cover, Left	1
T	16-78	Centerlock Hex Nut	4	AX	6060-37-39	Trigger Lock	2
U	25-79	Dome Hd. Rivet	2	AY	6060-37-40	Center Pivot	4
V	28-138	Retaining Ring	4	AZ	6060-37-42	Pivot, Right	2
W	28-141	Retaining Ring	2	BA	6060-37-43	Pivot, Left	2
Z	721-26-66	Pivot Screw	1	BB	6060-37-47	Safety Hook Rel. Handle	1
AA	6060-36-20	Wheel Assembly	2	BC	6060-37-48	Safety Hook Rel. Arm	1
AB	6060-36-24	Pivot Stop Pin	2	BD	6060-37-49	Saf. Hk. Rel. Hand. Spacer	2
AC	6060-36-25	Pivot Pin	2	BF	38-408	Torsion Spring, Left	1
AD	6060-36-34	Strap Holder Bracket	2	BG	38-409	Torsion Spring, Right	1
AE	6060-36-37	Lock Release Handle	2	BH	38-410	Extension Spring	2
AF	6060-36-44	Bumper	1				

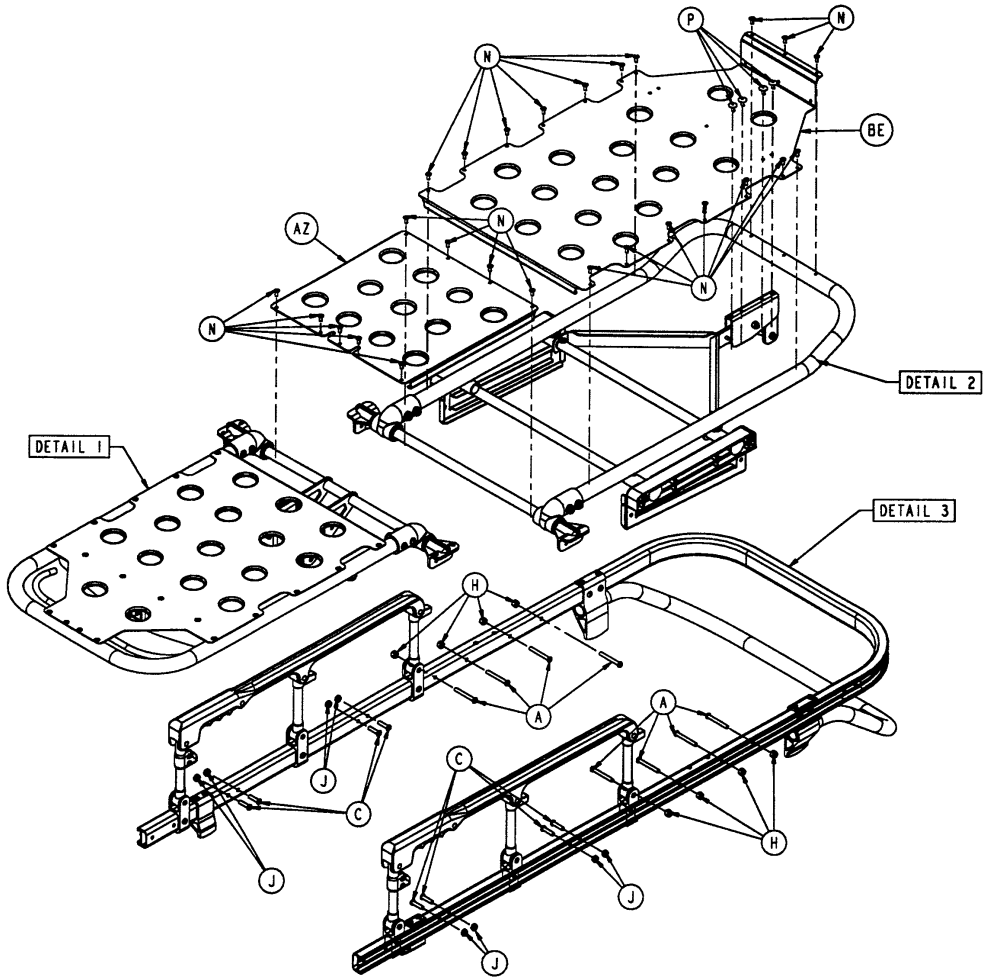

Assembly part number 6070-30-11

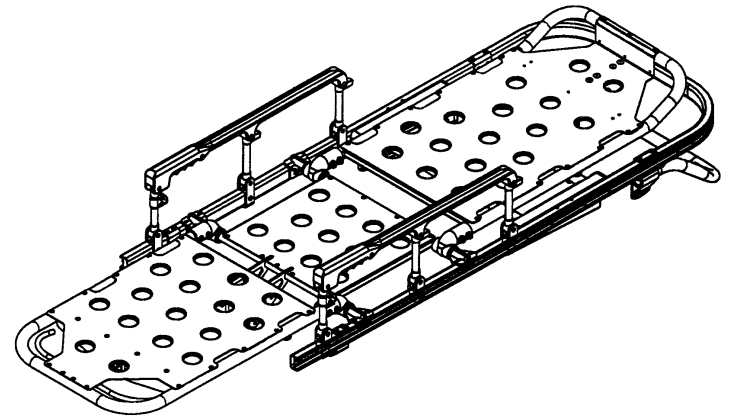

Litter Assembly (6070)

Assembly part number 6070-30-11

37

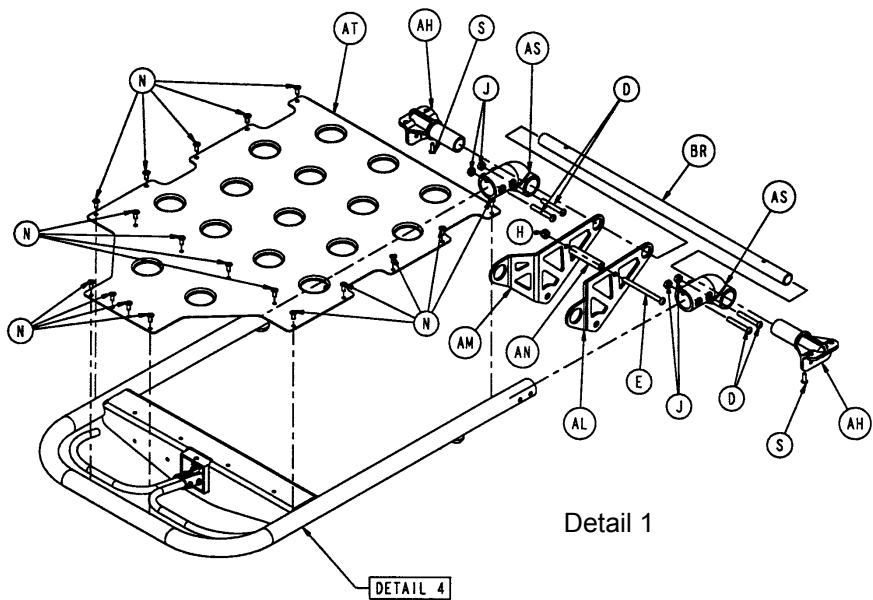

Detail 1

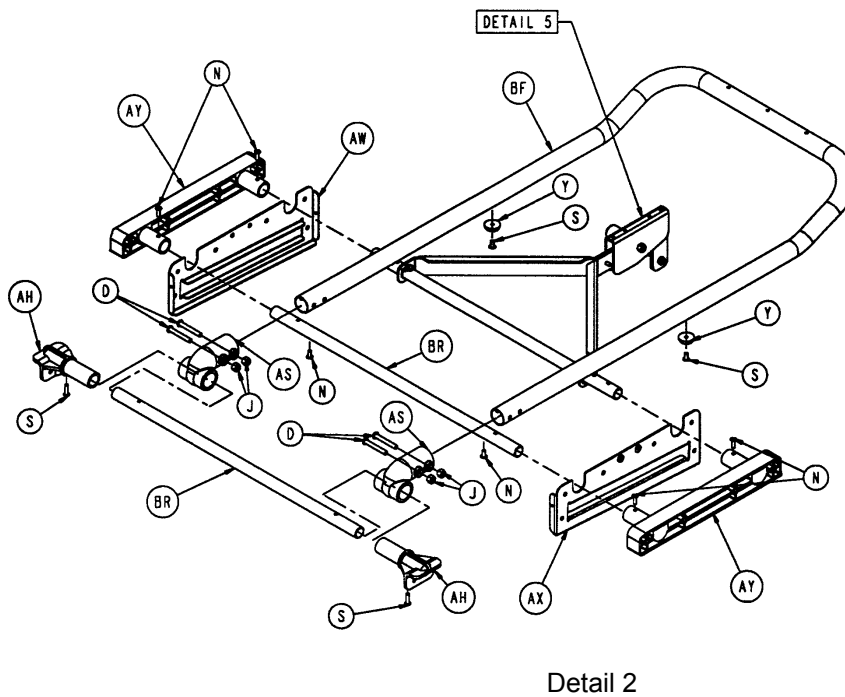

Detail 2

Assembly part number 6070-30-11

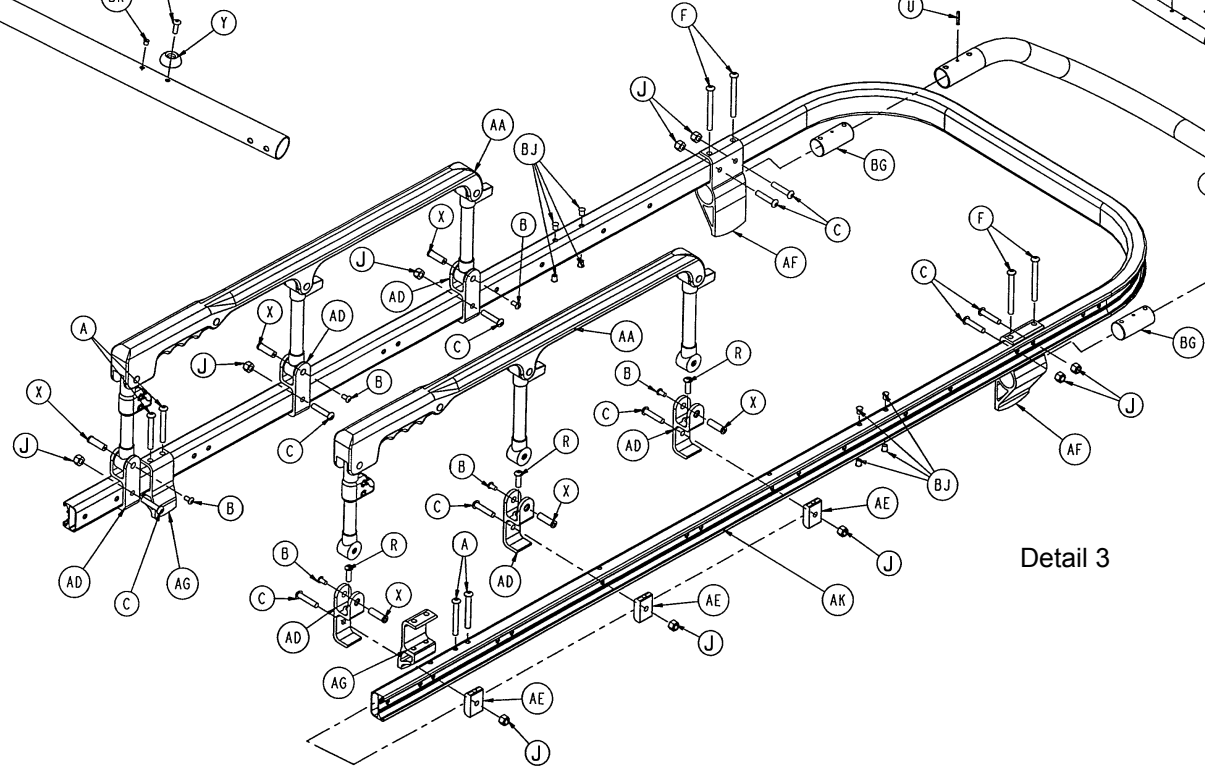
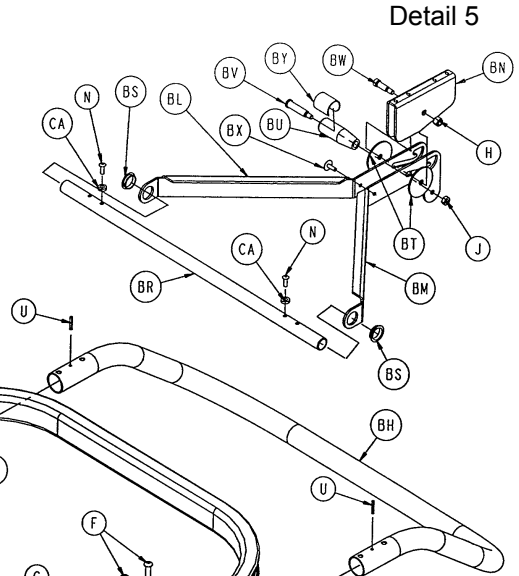
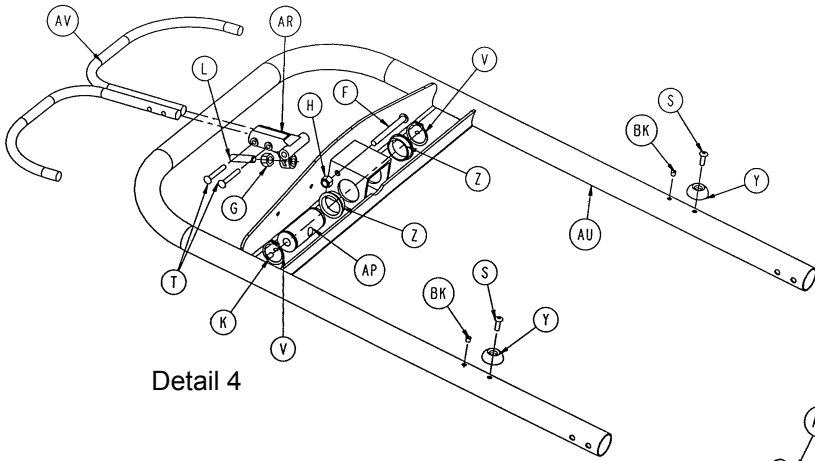

# Litter Assembly (6070)

---

Item	Part No.	Part Name	Qty.	Item	Part No.	Part Name	Qty.
A	4-97	Hex Soc. B. Hd. Cap Scr.	12	AN	6060-31-47	Litter/Base Intfce. Spcr.	1
B	4-136	Pan Hd. Mach. Screw	6	AP	6060-32-38	Yoke	1
C	4-197	Hex Soc. B. Hd. Cap Scr.	18	AR	6060-32-40	Pivot	1
D	4-204	Hex Soc. B. Hd. Cap Scr.	8	AS	6060-32-42	Adapter Pivot	4
E	4-218	Hex Soc. B. Hd. Cap Scr.	1	AT	6060-32-45	Fowler Skin	1
F	4-234	Hex Soc. B. Hd. Cap Scr.	5	AU	6060-32-50	Fowler Weldment	1
G	15-50	Hex Nut	1	AV	6060-32-52	Release Handle Wldmnt.	1
H	16-28	Fiberlock Hex Nut	11	AW	6060-33-32	Side Plate, Left	1
J	16-78	Centerlock Hex Nut	27	AX	6060-33-33	Side Plate, Right	1
K	21-119	Set Screw	1	AY	6060-33-45	Spacer	2
L	21-138	Set Screw	1	AZ	6070-34-46	Midsection Skin	1
N	25-79	Dome Head Rivet	52	BE	6070-38-45	Foot Section Skin	1
P	25-132	Flange Rivet	4	BF	6070-38-46	Foot Section Tube	1
R	4-161	Hex Soc. B. Hd. Cap Scr.	6	BG	6070-39-43	Plug	2
S	25-133	Dome Head Rivet	8	BH	6070-39-46	Lifting Bar	1
T	25-135	Semi-Tubular Rivet	2	BJ	721-31-65	Hole Plug	8
U	26-5	Roll Pin	2	BK	37-74	Hole Plug	2
V	28-76	External Retaining Ring	2	BL	6070-38-31	Calf Stand Support, Lt.	1
X	721-26-66	Pivot Screw	6	BM	6070-38-32	Calf Stand Support, Rt.	1
Y	946-1-155	Bumper	4	BN	6070-38-33	Calf Stand Retainer	1
Z	946-35-25	Liner	2	BR	6070-38-35	Trend Pivot Cross Brace	4
AA	(page 43)	Siderail Assembly	2	BS	81-255	Split Bearing	2
AD	6060-25-55	Pivot Mount	6	BT	14-55	Flat Washer	4
AE	6060-25-33	Pivot Mount Spacer	6	BU	938-1-177	Knob	1
AF	6060-30-39	Litter Stop, Foot	2	BV	378-24-29	Shoulder Bolt	1
AG	6060-30-40	Litter Stop	2	BW	8-27	Shoulder Bolt	1
AH	6060-30-31	Support Mount	4	BX	25-128	Flange Rivet	5
AK	6060-30-46	Outer Support Rail	1	BY	6070-90-7	Trend Lift Handle Label	1
AL	6060-31-35	Outer Plate, Right	1	CA	14-67	Nylon Flat Washer	2
AM	6060-31-36	Outer Plate, Left	1				



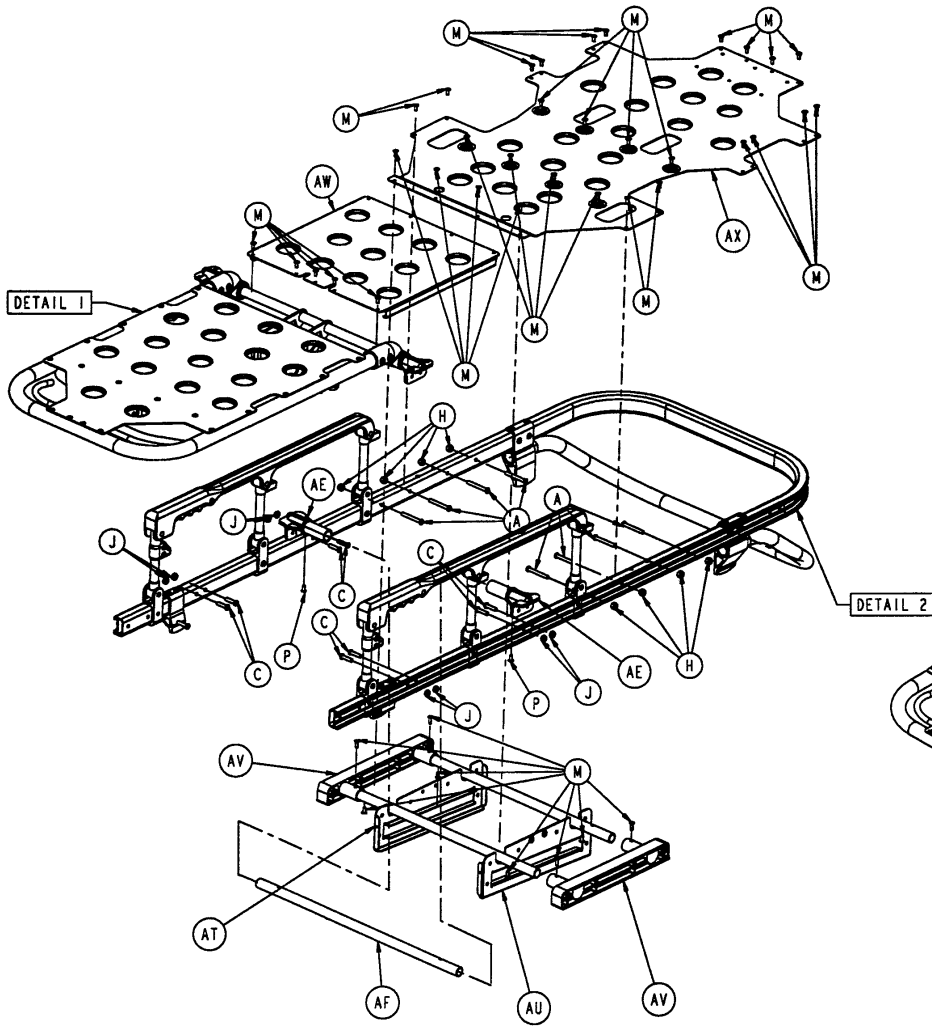

Assembly part number 6060-30-11

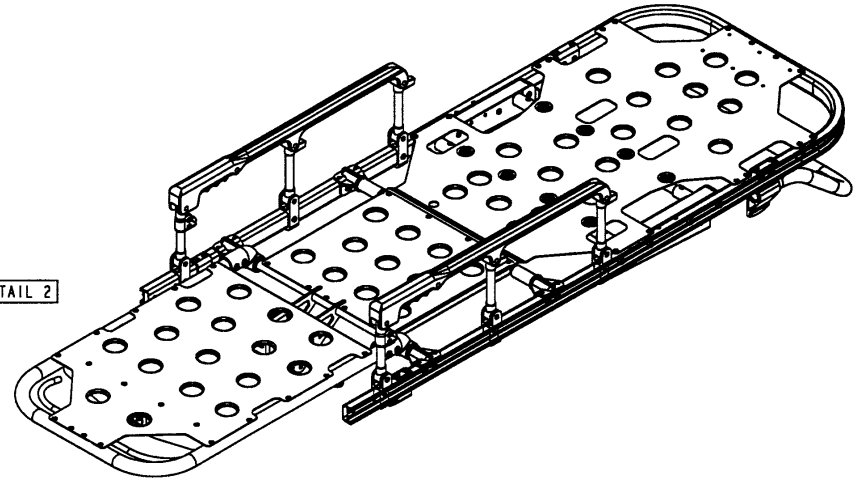

Litter Assembly (6060)

# Litter Assembly (6060)

Assembly part number 6060-30-11

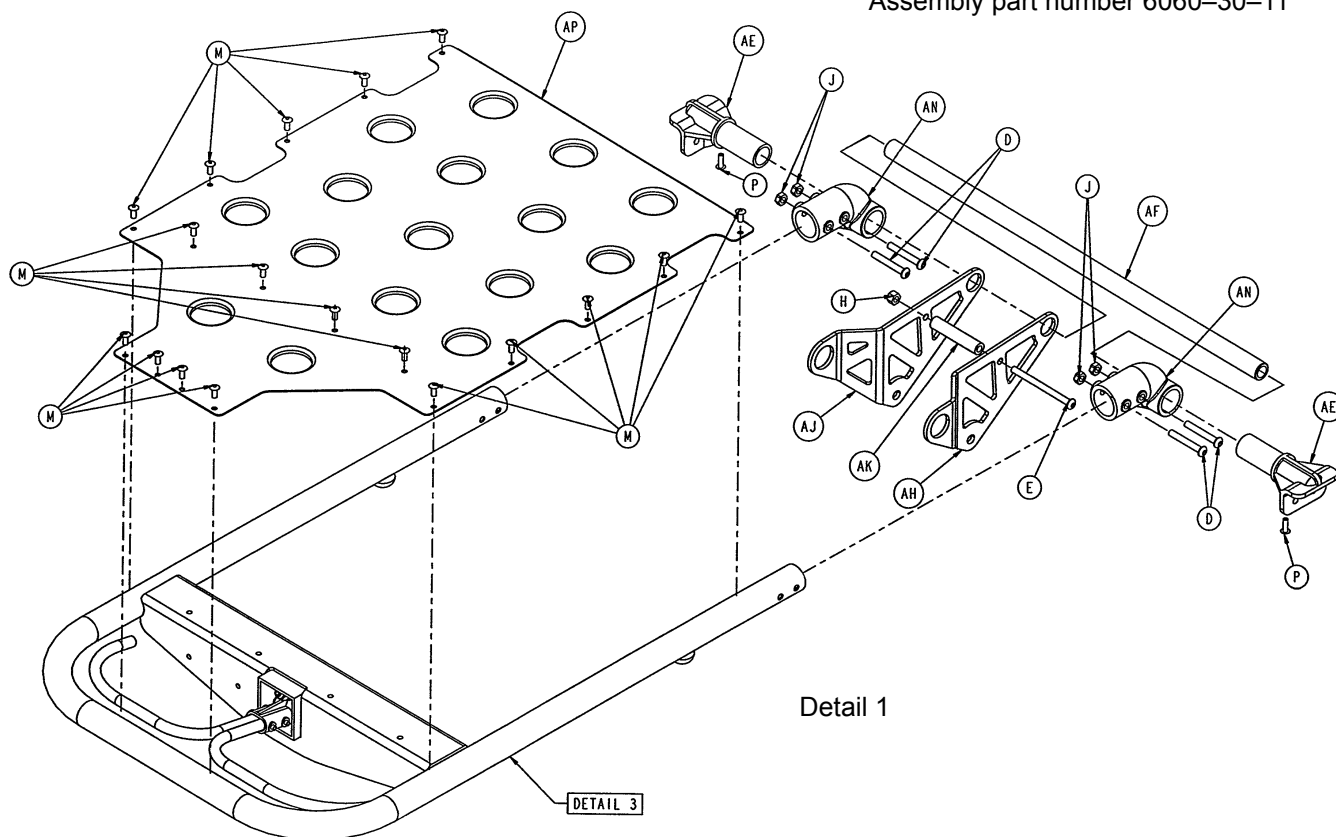

Item	Part No.	Part Name	Qty.	Item	Part No.	Part Name	Qty.
A	4-97	Hex But. Hd. Cap Screw	12	AC	6060-30-39	Litter Stop, Foot End	2
B	4-136	Pan Hd. Mach. Screw	6	AD	6060-30-40	Litter Stop	2
C	4-197	Hex But. Hd. Cap Screw	18	AE	6060-30-31	Support Mount	4
D	4-204	Hex But. Hd. Cap Screw	4	AF	6070-38-35	Trend Pivot Cross Brace	4
E	4-218	Hex But. Hd. Cap Screw	1	AG	6060-30-46	Outer Support Rail	1
F	4-234	Hex But. Hd. Cap Screw	5	AH	6060-31-35	Outer Plate, Right	1
G	15-50	Hex Nut	1	AJ	6060-31-36	Outer Plate, Left	1
H	16-28	Fiberlock Hex Nut	10	AK	6060-31-47	Litter/Base Intrfce. Sprc.	1
J	16-78	Centerlock Hex Nut	22	AL	6060-32-38	Yoke	1
K	21-119	Set Screw	1	AM	6060-32-40	Pivot	1
L	21-138	Set Screw	1	AN	6060-32-42	Adapter Pivot	2
M	25-79	Dome Hd. Rivet	59	AP	6060-32-45	Fowler Skin	1
P	25-133	Dome Hd. Rivet	6	AR	6060-32-50	Fowler Weldment	1
R	25-135	Semi-Tubular Rivet	2	AS	6060-32-52	Release Handle Wldmt.	1
S	26-5	Roll Pin	2	AT	6060-33-32	Side Plate, Left	1
T	28-76	Ext. Retaining Ring	2	AU	6060-33-33	Side Plate, Right	1
V	721-26-66	Pivot Screw	6	AV	6060-33-45	Spacer	2
W	721-31-65	Hole Plug	8	AW	6070-34-46	Midsection Skin	1
X	946-1-155	Bumper	2	AX	6060-234-45	Stat. Foot Section Skin	1
Y	946-35-25	Liner	2	AY	6070-39-43	Plug	2
Z	(page 43)	Siderail Assembly	2	AZ	6070-39-46	Lifting Bar	1
AA	6060-25-55	Pivot Mount	6	BA	37-74	Hole Plug	2
AB	6060-25-33	Pivot Mount Spacer	6	BB	4-161	Hex Soc. B. Hd. Cap Scr.	6

Litter Assembly (6060)

Assembly part number 6060-30-11

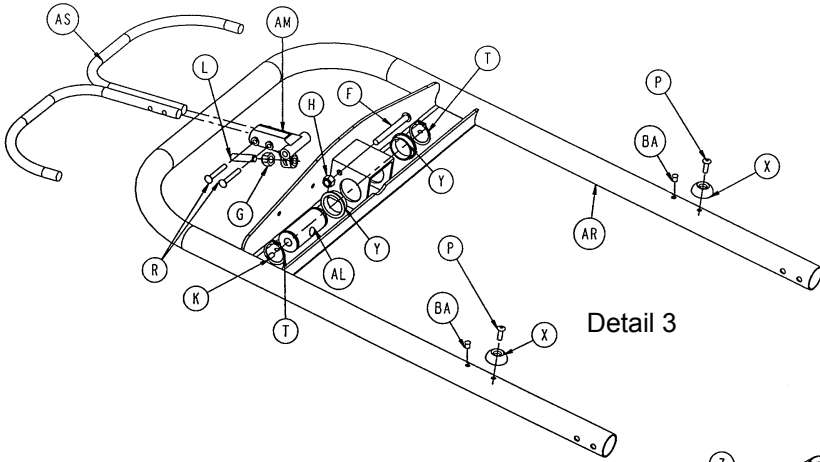

Detail 3

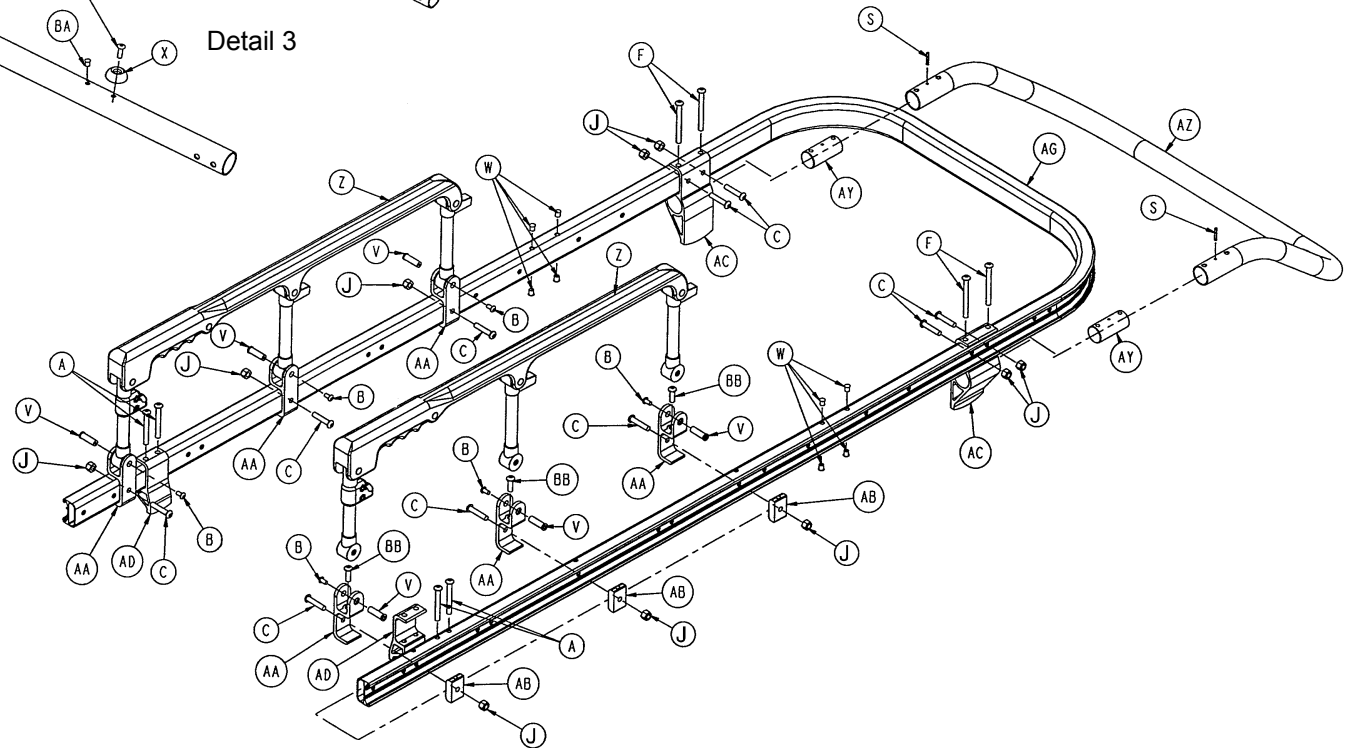

# 6060-26-10 Siderail Assembly

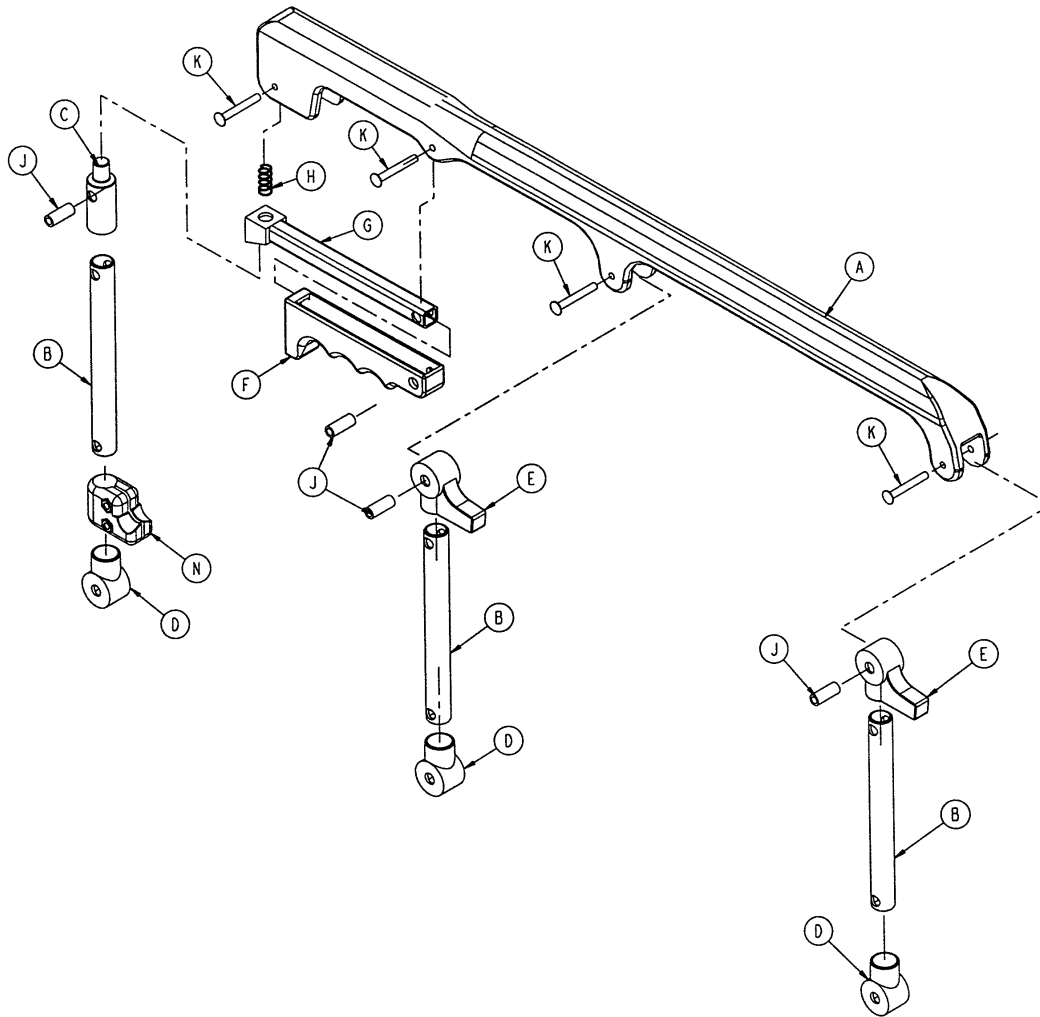

Item	Part No.	Part Name	Qty.
A	6060-25-24	Top Rail	1
B	6060-25-43	Spindle	3
C	6060-25-47	Spindle Lock	1
D	6060-25-41	Spindle Pivot	3
E	6060-25-40	Spindle Pivot Stop	2
F	6060-25-29	Lock Release Grip	1
G	6060-25-30	Lock Bar Weldment	1
H	38-344	Compression Spring	1
J	6060-25-35	Pivot Bushing	4
K	25-131	Rivet	4
N	1001-26-39	Ring Spacer Assembly	1

# 2-Stage I.V. Pole Mounting Assembly, Patient Right

Assembly part number 6070-110-10

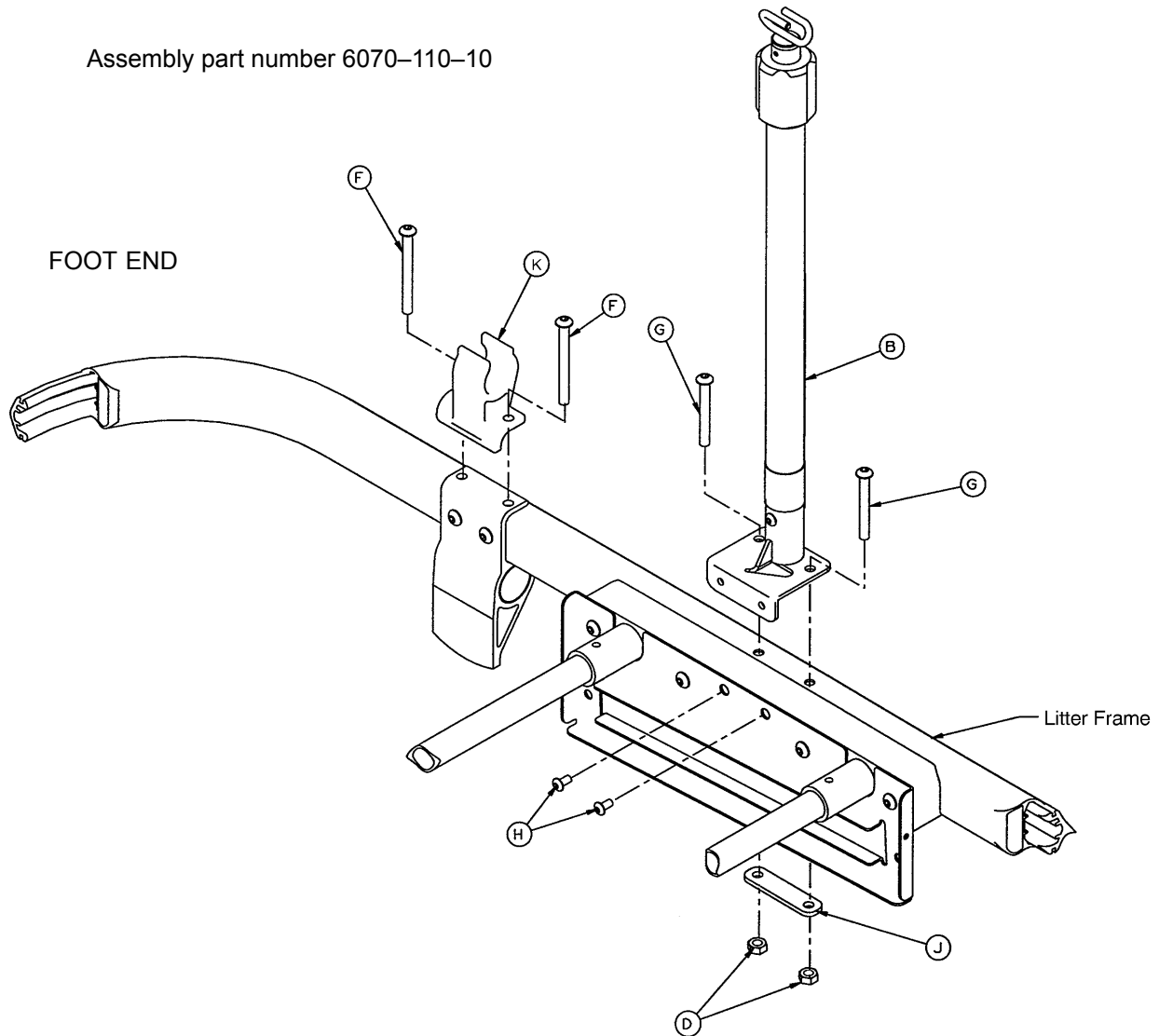

Item	Part No.	Part Name	Qty.
B	(page 46)	I.V. Pole, Patient Right	1
D	16-78	Centerlock Hex Nut	2
F	4-234	Hex Soc. But. Hd. Cap Screw	2
G	4-97	Hex Soc. But. Hd. Cap Screw	2
H	4-149	Pan Hd. Machine Screw	2
J	6070-110-32	Retainer Plate	1
K	6080-110-35	I.V. Clip	1

# 2-Stage I.V. Pole Mounting Assembly, Patient Left

Assembly part number 6070-111-10

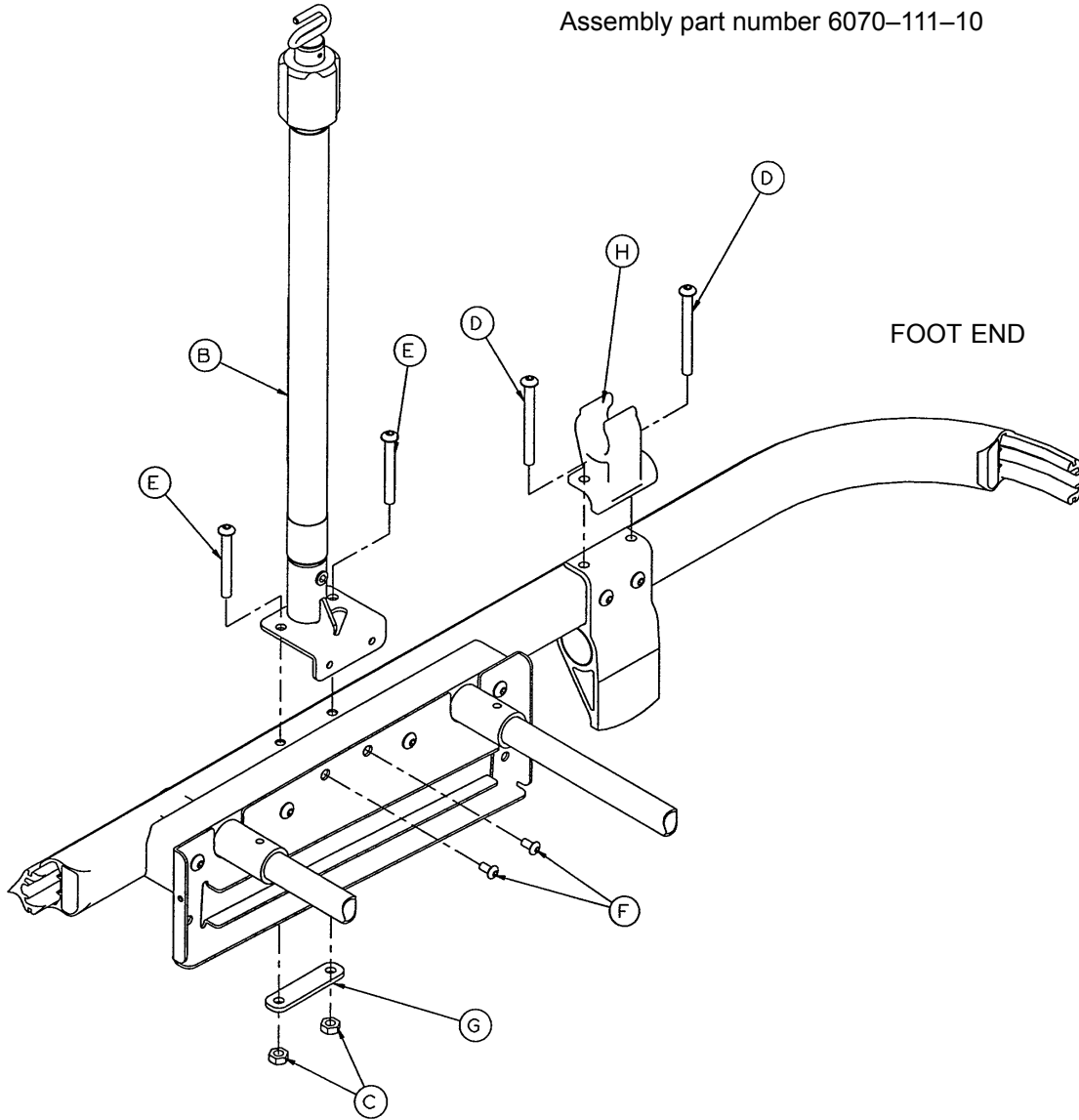

Item	Part No.	Part Name	Qty.
B	(page 47)	I.V. Pole, Patient Left	1
C	16-78	Centerlock Hex Nut	2
D	4-234	Hex Soc. But. Hd. Cap Screw	2
E	4-97	Hex Soc. But. Hd. Cap Screw	2
F	4-149	Pan Hd. Machine Screw	2
G	6070-110-32	Retainer Plate	1
H	6080-110-35	I.V. Clip	1

# 2-Stage I.V. Pole Assembly, Patient Right

Assembly part number 6070-110-20

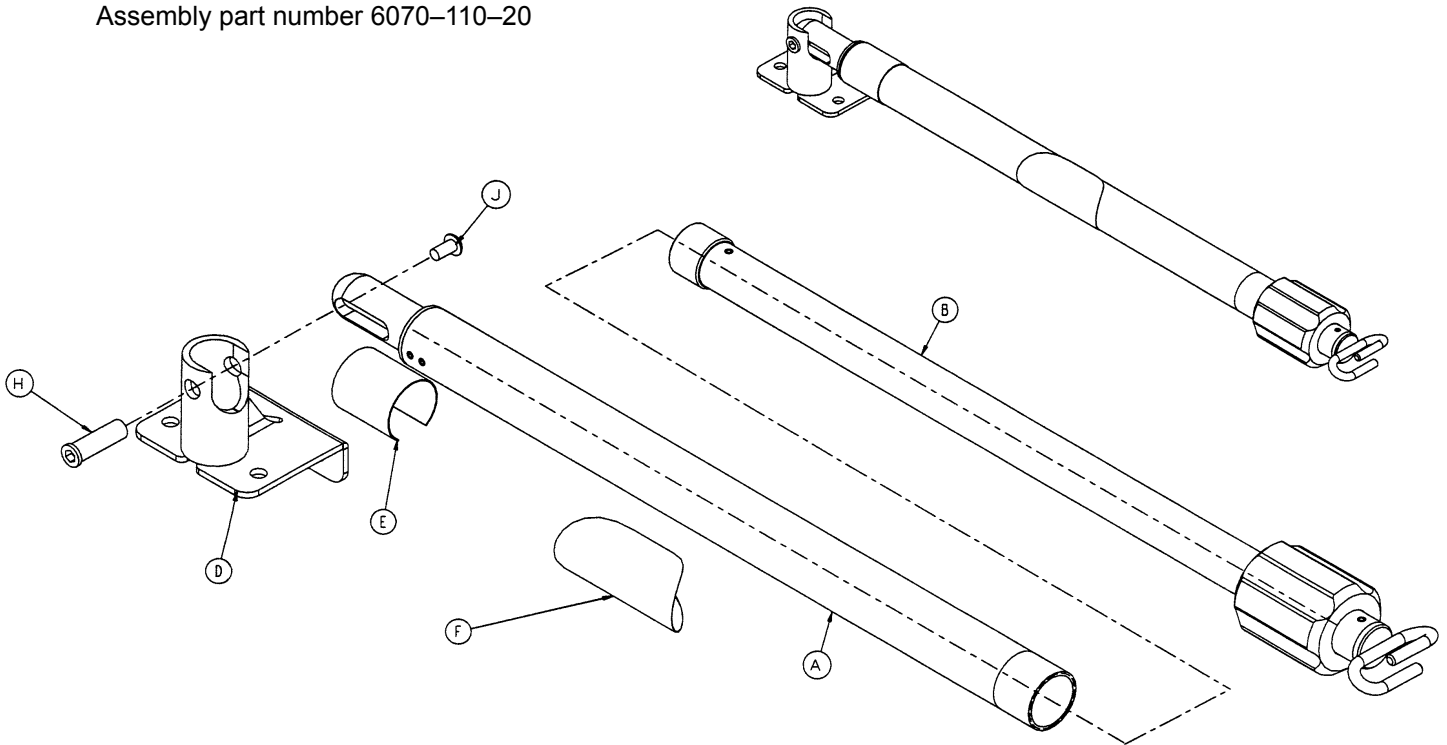

Item	Part No.	Part Name	Qty.
A	(page 48)	I.V. Base Assembly	1
B	(page 49)	2nd Stage Assembly	1
D	6070-110-52	I.V. Socket Weldment	1
E	6070-90-4	Specification Label	1
F	6070-90-105	No Push/Pull Label	1
H	721-26-66	Pivot Screw	1
J	4-136	Hex Soc. But. Hd. Cap Screw	1

# 2-Stage I.V. Pole Assembly, Patient Left

Assembly part number 6070-111-20

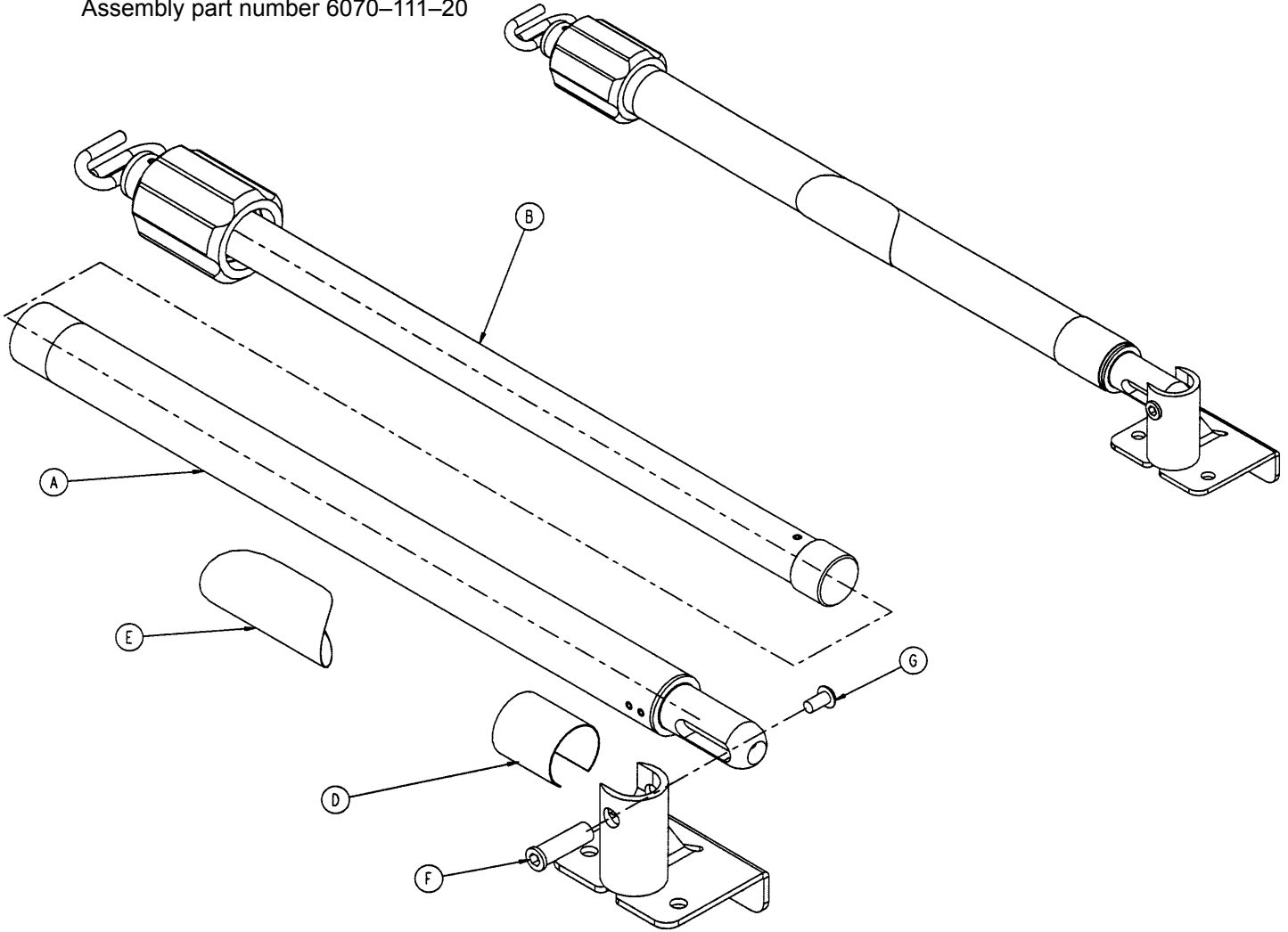

Item	Part No.	Part Name	Qty.
A	(page 48)	I.V. Base Assembly	1
B	(page 49)	2nd Stage Assembly	1
D	6070-111-52	I.V. Socket Weldment, Left	1
E	6070-90-6	Specification Label	1
F	6070-90-105	No Push/Pull Label	1
H	721-26-66	Pivot Screw	1
J	4-136	Hex Soc. But. Hd. Cap Screw	1



# I.V. Pole Base Assembly

---

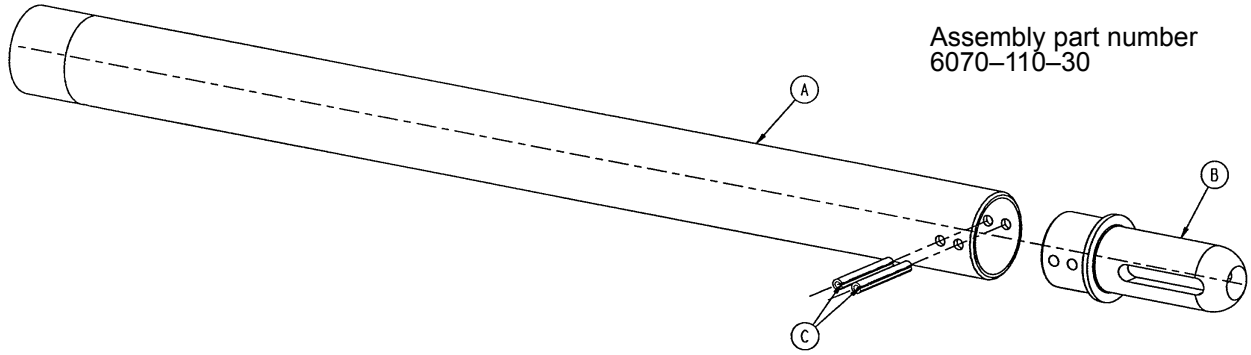

Item	Part No.	Part Name	Qty.
A	6070-110-41	Base Tube	1
B	6070-110-46	Pivot	1
C	26-7	Roll Pin	2

# 2nd Stage Assembly – 2-Stage I.V. Pole

Assembly part number  
6070-110-40

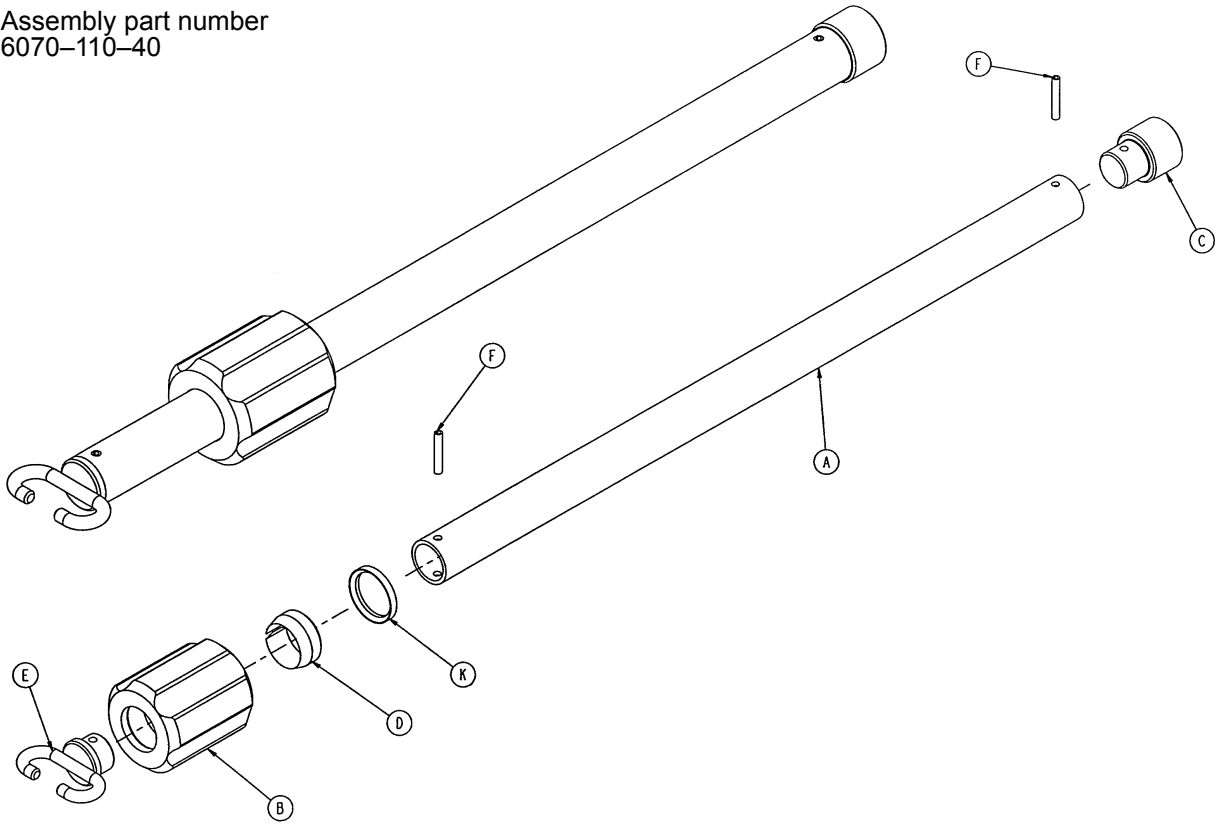

Item	Part No.	Part Name	Qty.
A	6070-110-42	2nd Stage Tube	1
B	1210-110-49	Actuator	1
C	6070-110-44	Slide Plug	1
D	1210-110-47	Lock Ring	1
E	6070-110-50	Hook Weldment	1
F	26-6	Roll Pin	2
K	1210-110-46	Back-Up Ring	1

# 3-Stage I.V. Pole Mounting Assembly, Patient Right

Assembly part number 6070-115-10

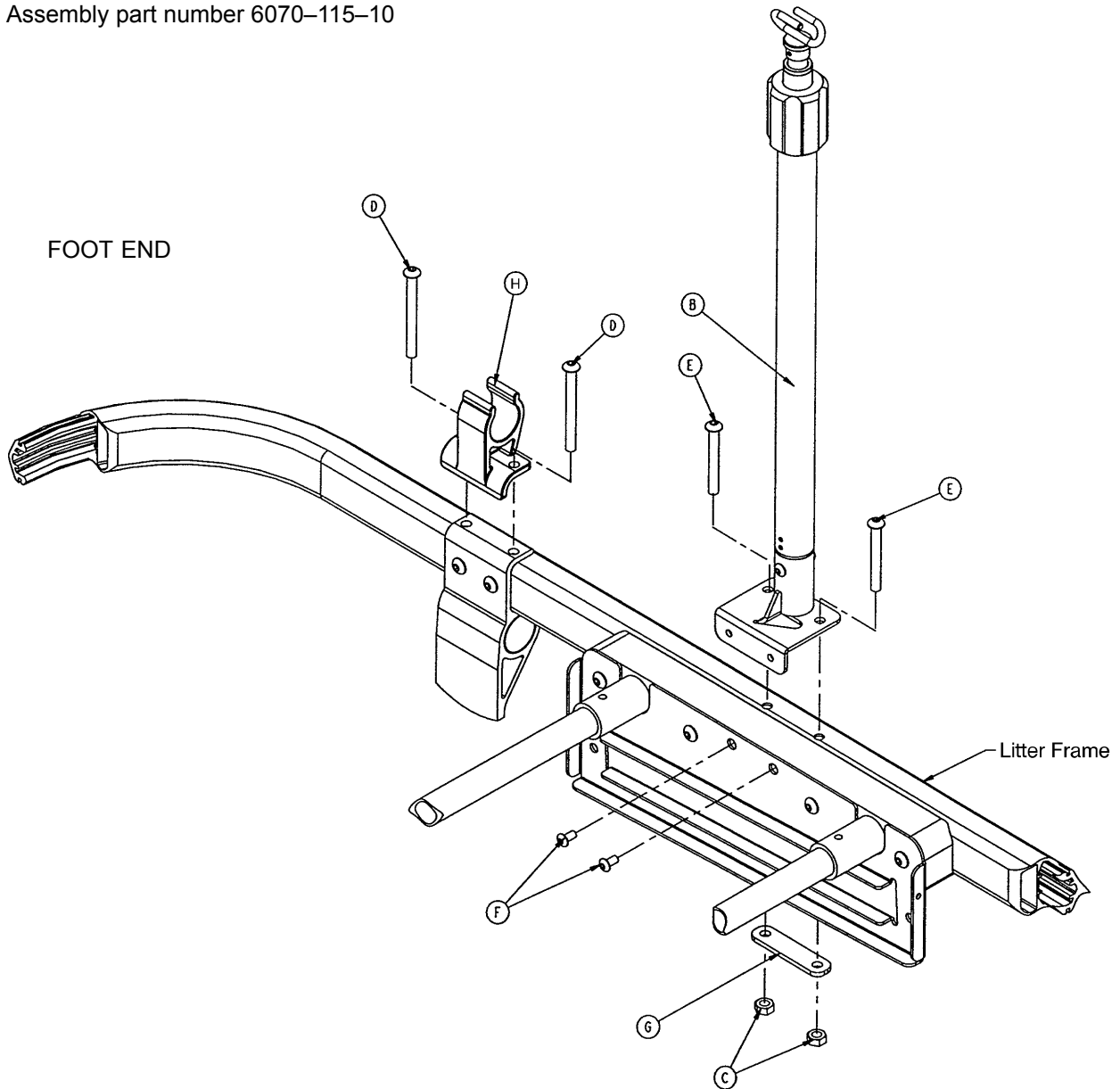

Item	Part No.	Part Name	Qty.
B	(page 52)	I.V. Pole, Patient Right	1
C	16-78	Centerlock Hex Nut	2
D	4-234	Hex Soc. But. Hd. Cap Screw	2
E	4-97	Hex Soc. But. Hd. Cap Screw	2
F	4-149	Pan Hd. Machine Screw	2
G	6070-110-32	Retainer Plate	1
H	6080-110-35	I.V. Clip	1

# 3-Stage I.V. Pole Mounting Assembly, Patient Left

Assembly part number 6070-116-10

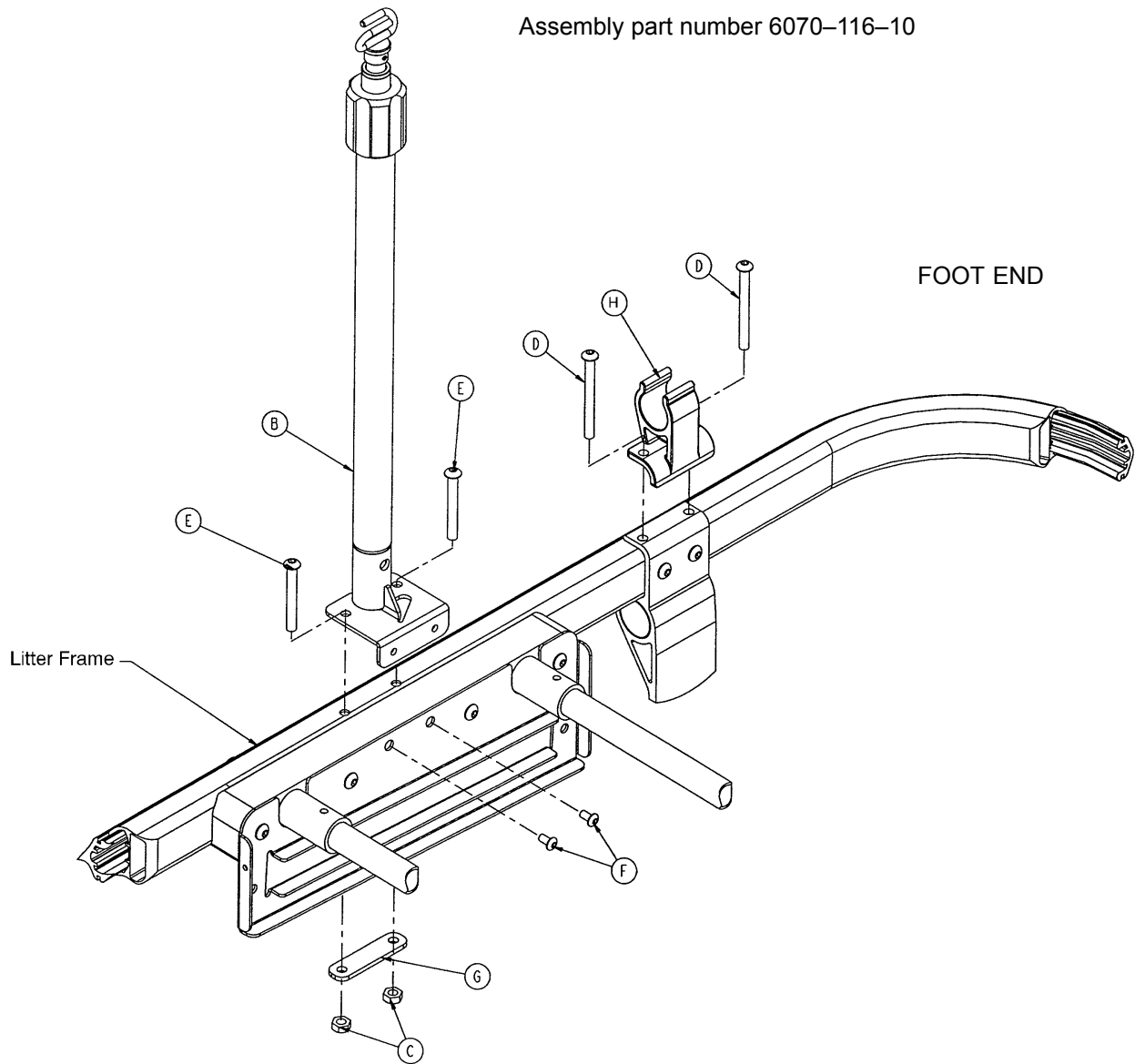

Item	Part No.	Part Name	Qty.
B	(page 53)	I.V. Pole, Patient Left	1
C	16-78	Centerlock Hex Nut	2
D	4-234	Hex Soc. But. Hd. Cap Screw	2
E	4-97	Hex Soc. But. Hd. Cap Screw	2
F	4-149	Pan Hd. Machine Screw	2
G	6070-110-32	Retainer Plate	1
H	6080-110-35	I.V. Clip	1

# 3-Stage I.V. Pole Assembly, Patient Right

Assembly part number 6070-115-20

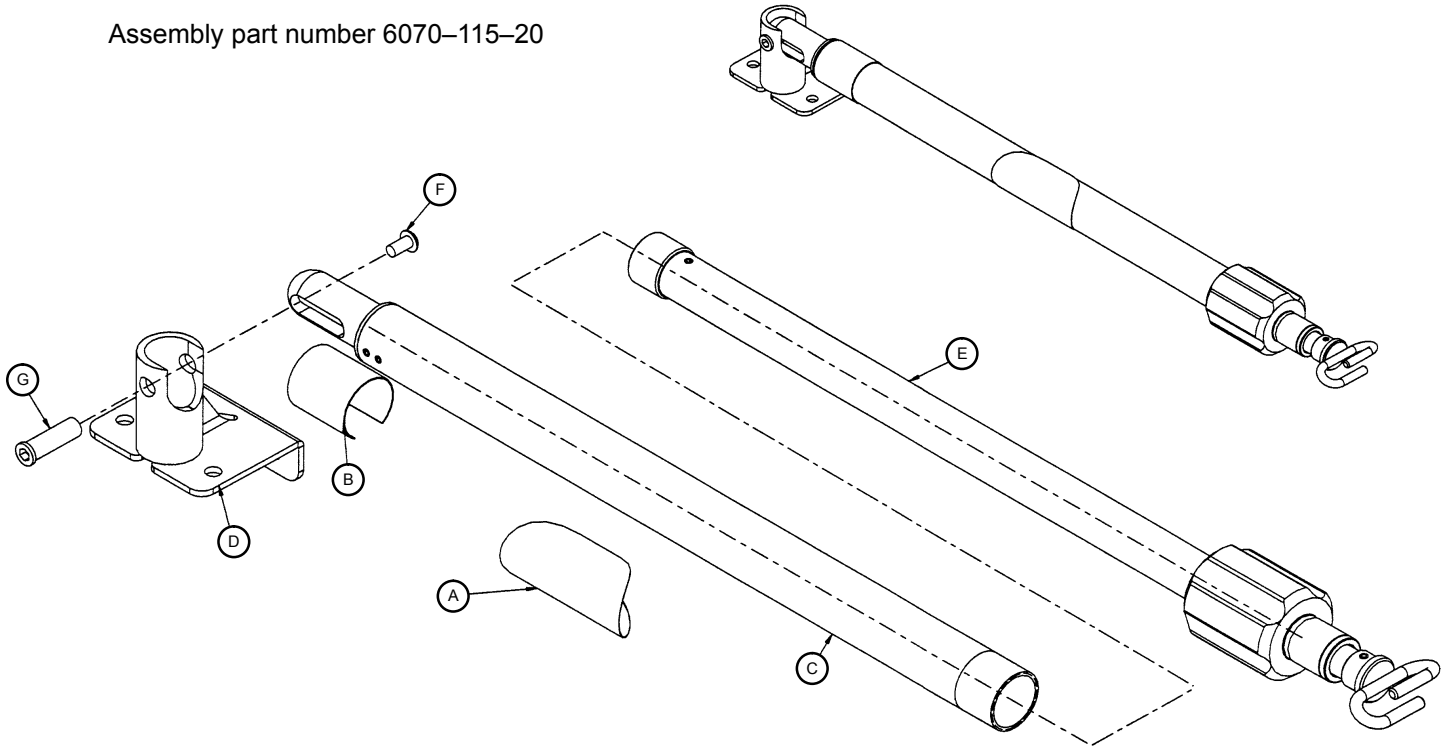

Item	Part No.	Part Name	Qty.
A	6070-90-105	No Push/Pull Label	1
B	6070-90-12	Specification Label	1
C	(page 48)	I.V. Base Assembly	1
D	6070-110-52	I.V. Socket, Patient Right	1
E	(page 54)	2nd Stage Assembly	1
F	4-136	Pan Hd. Machine Screw	1
G	721-26-66	Pivot Screw	1

# 3-Stage I.V. Pole Assembly, Patient Left

Assembly part number 6070-116-20

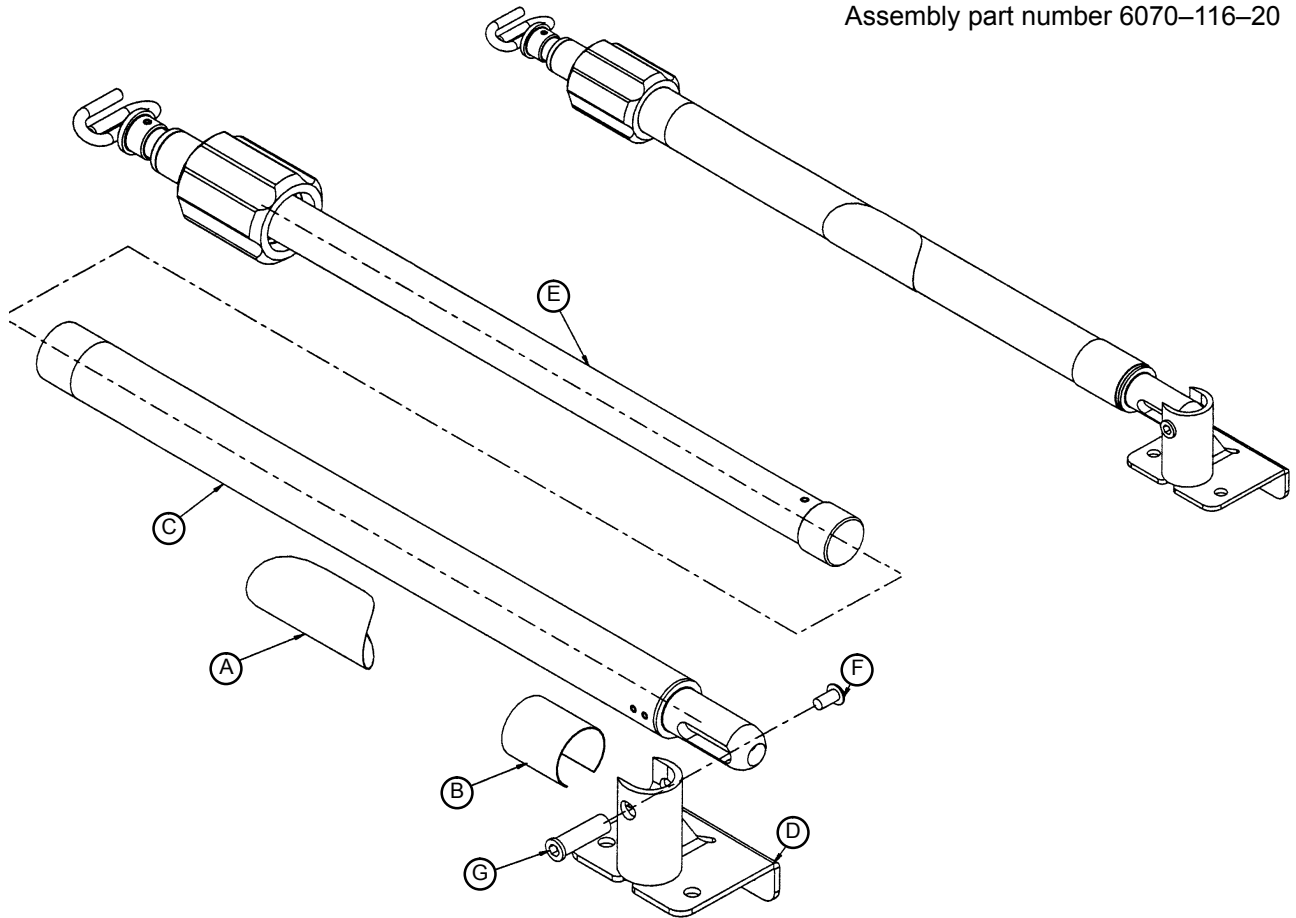

Item	Part No.	Part Name	Qty.
A	6070-90-105	No Push/Pull Label	1
B	6070-90-13	Specification Label	1
C	(page 48)	I.V. Base Assembly	1
D	6070-111-52	I.V. Socket, Patient Left	1
E	(page 54)	2nd Stage Assembly	1
F	4-136	Pan Hd. Machine Screw	1
G	721-26-66	Pivot Screw	1

# 2nd Stage Assembly – 3–Stage I.V. Pole

Assembly part number 6070–115–40

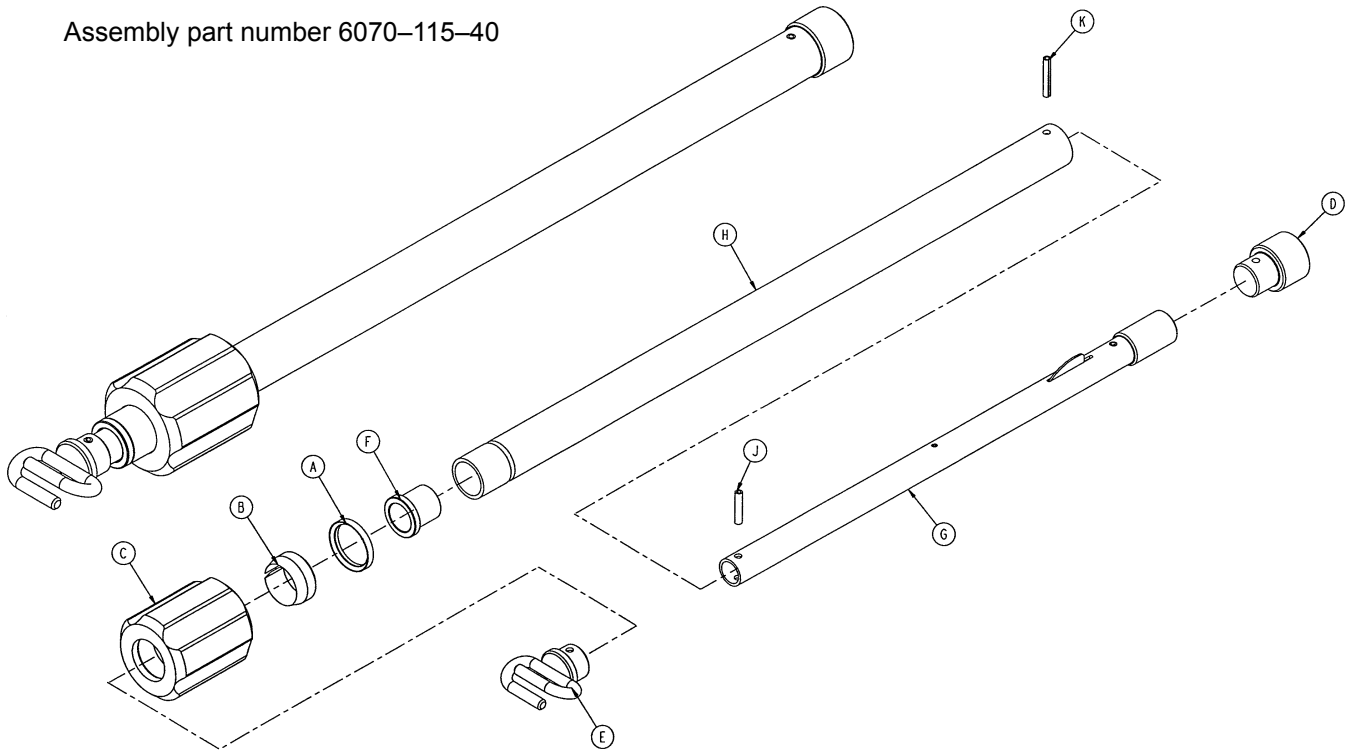

Item	Part No.	Part Name	Qty.
A	1210–110–46	Back–Up Ring	1
B	1210–110–47	Lock Ring	1
C	1210–110–49	Actuator	1
D	6070–110–44	2nd Stage Slide Plug	1
E	6070–110–50	Hook Weldment	1
F	6070–115–45	Bearing Plug	1
G	(page 55)	3rd Stage Assembly	1
H	6070–115–42	2nd Stage Tube	1
J	26–5	Roll Pin	1
K	26–6	Roll Pin	1

# 3rd Stage Assembly – 3-Stage I.V. Pole

Assembly part number  
6070-115-30

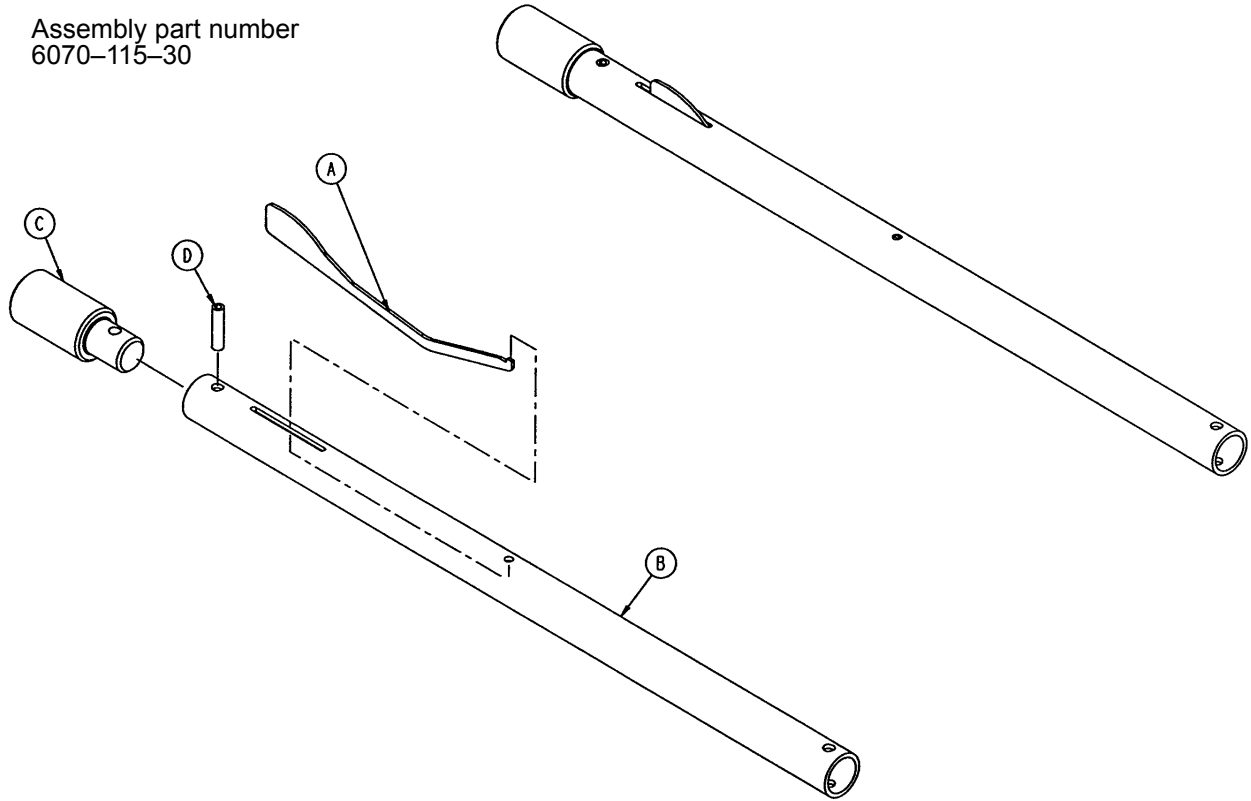

Item	Part No.	Part Name	Qty.
A	6070-115-141	Spring Clip	1
B	6070-115-143	3rd Stage Tube	1
C	6070-115-44	3rd Stage Slide Plug	1
D	26-4	Roll Pin	1



# Oxygen Bottle Holder Assembly

---

Assembly part number 6080-140-10

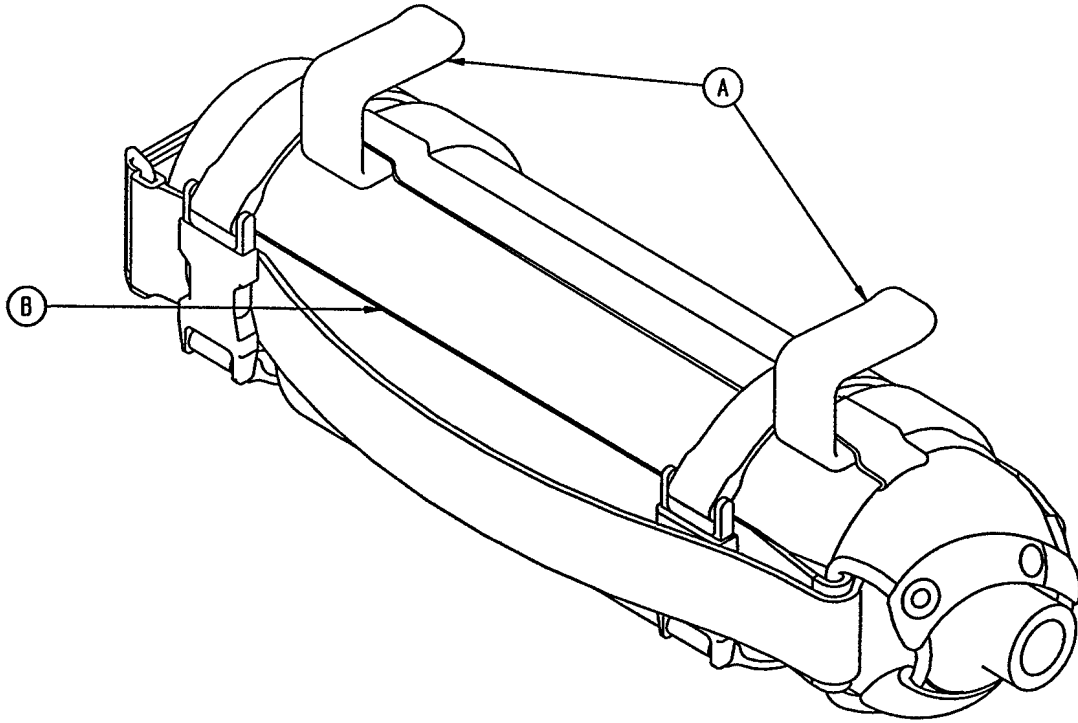

Item	Part No.	Part Name	Qty.
A	6080-140-11	Bottle Holder Hanger	2
B	6080-140-12	Oxygen Bottler Holder	1

# Oxygen Bottle Holder Assembly – DX

Assembly part number 6060-140-10

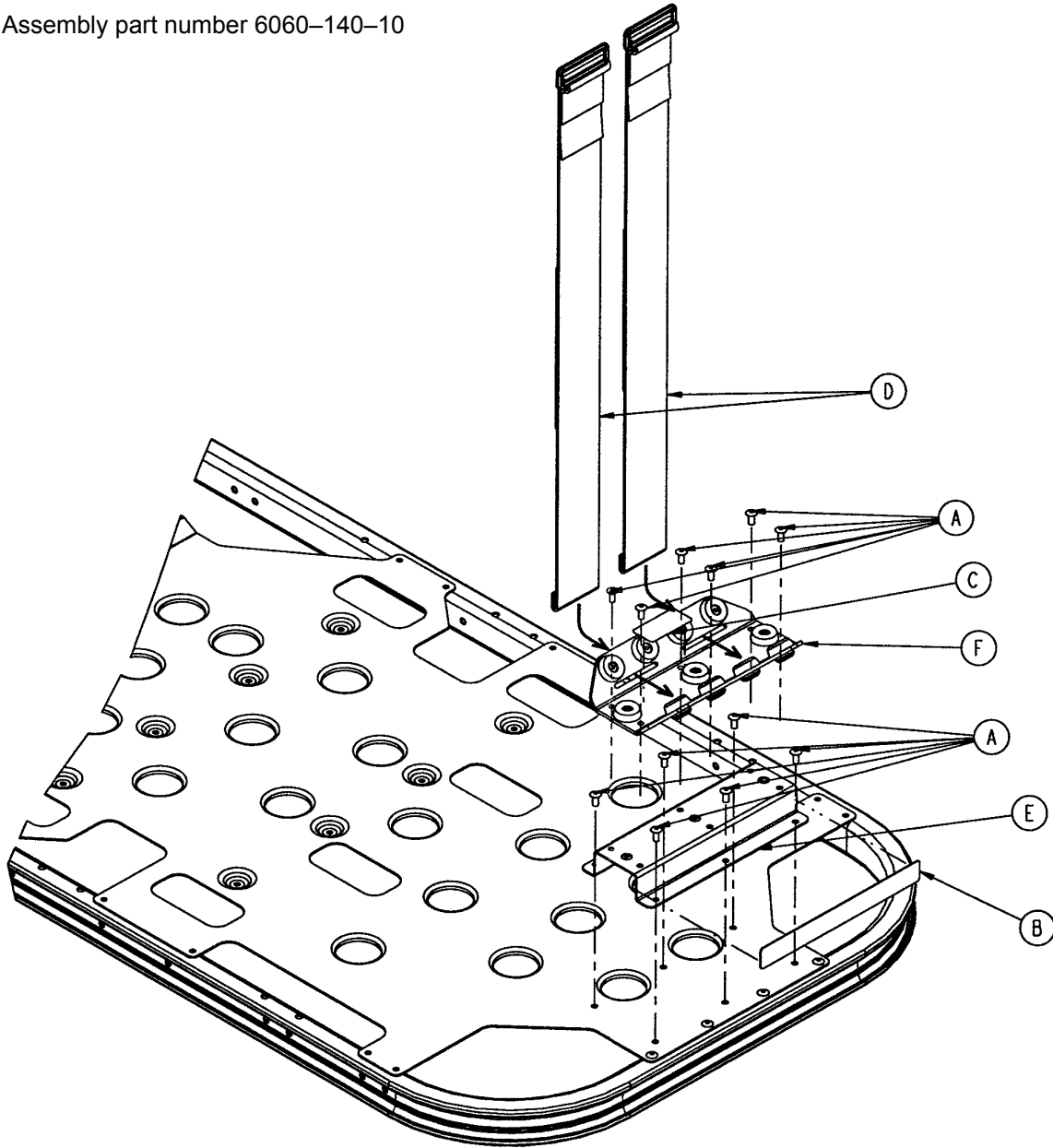

Item	Part No.	Part Name	Qty.
A	25-79	Rivet	12
B	6060-90-10	Warning Label	1
C	6060-90-19	Specification Label	1
D	6060-140-13	Strap Assembly	2
E	6060-140-18	Support Bracket	1
F	(page 59)	Bottle Holder Tray Ass'y	1

# Oxygen Bottle Holder Assembly – LX

Assembly part number 6070-140-10

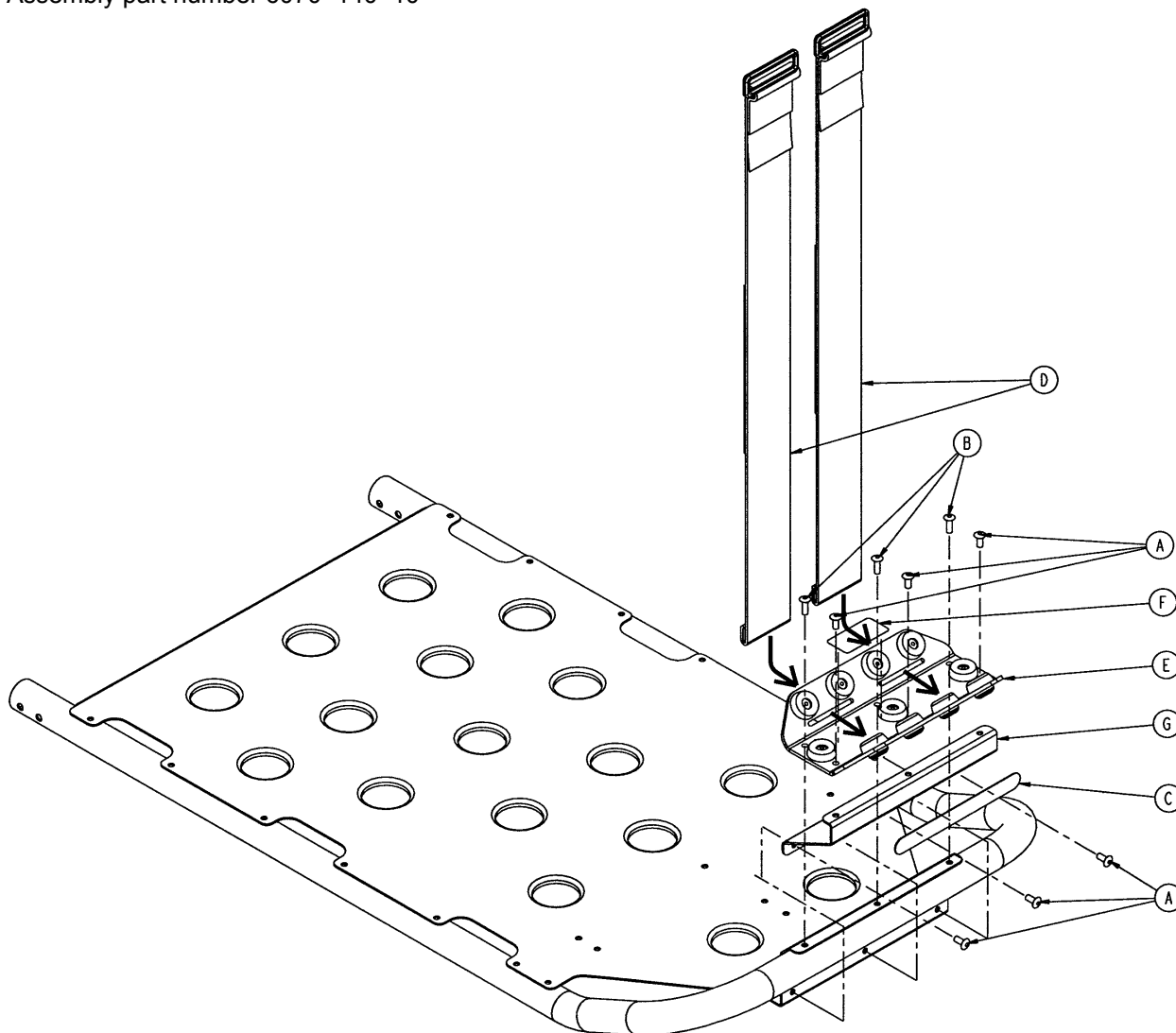

Item	Part No.	Part Name	Qty.
A	25-79	Rivet	6
B	25-133	Rivet	3
C	6060-90-4	"Rugged" Label	1
D	6060-140-13	Strap Assembly	2
E	(page 59)	Bottle Holder Tray Ass'y	1
F	6070-90-14	Specification Label	1
G	6070-140-17	Support Bracket	1

# Oxygen Bottle Holder Tray Assembly

Assembly part number  
6060-140-20

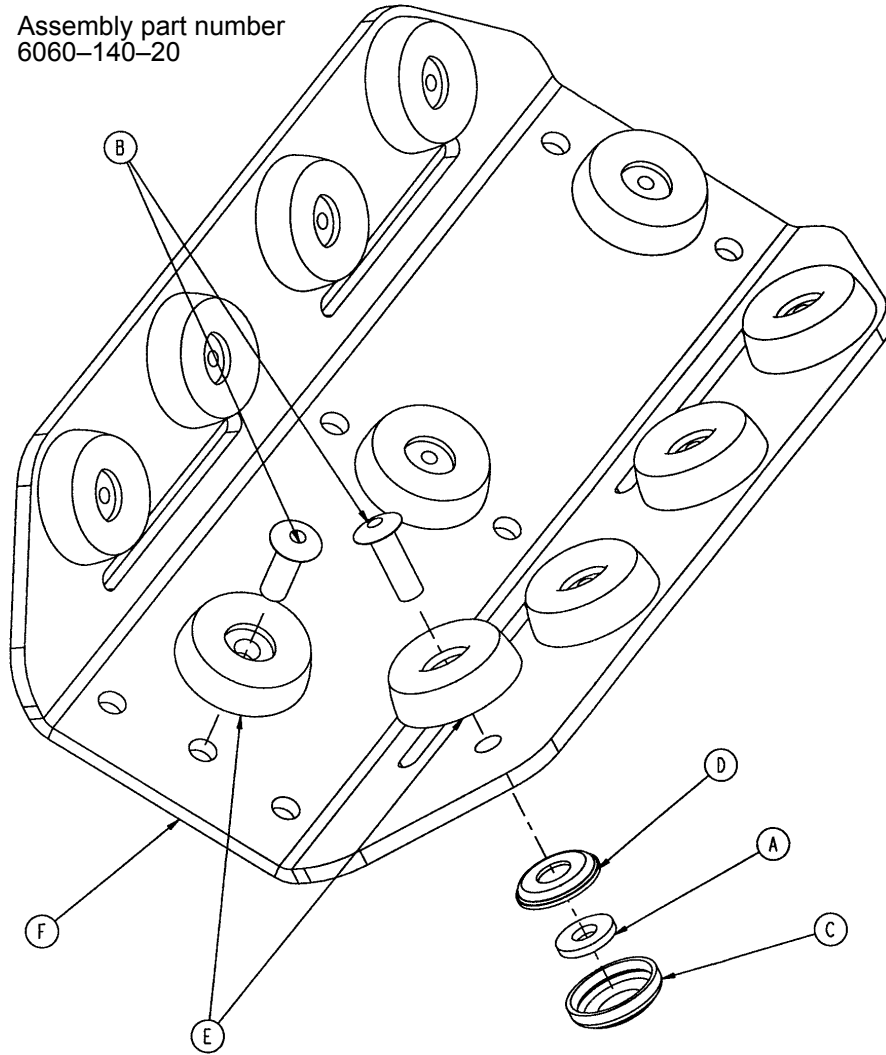

Item	Part No.	Part Name	Qty.
A	11-436	Flat Washer	8
B	25-133	Rivet	11
C	37-55	Cap	8
D	37-56	Washer	8
E	946-1-155	Bumper	11
F	6060-140-15	Bottle Holder Tray	1

# Base Storage Tray Assembly

Assembly part number 6060-150-10

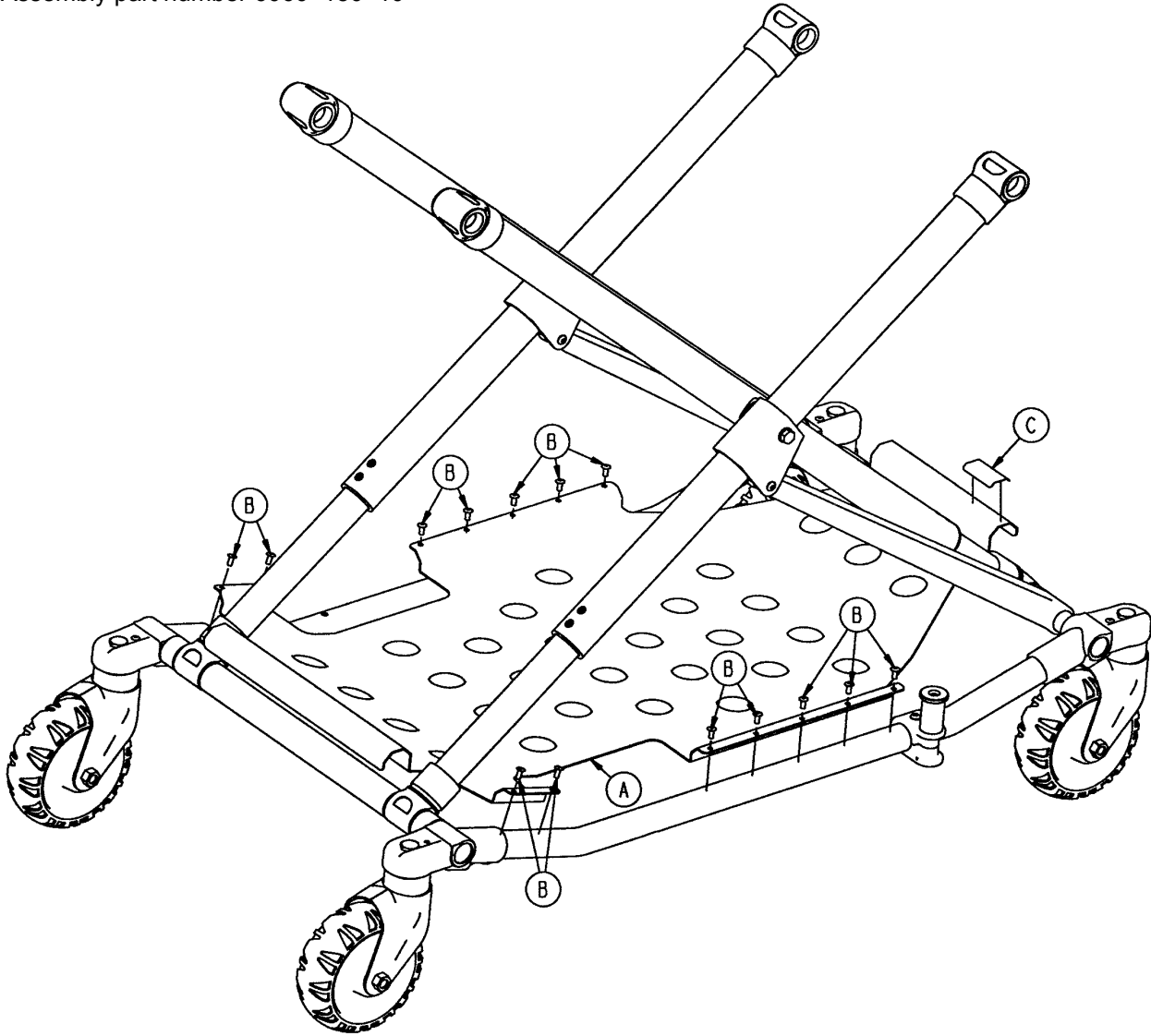

Item	Part No.	Part Name	Qty.
A	6060-150-11	Base Storage Tray	1
B	25-79	Dome Head Rivet	14
C	6060-90-20	Specification Label	1

# Replacement Part Numbers

---

<b><u>ITEM</u></b>	<b><u>PART NUMBER</u></b>
Litter Foot Section Bumper .....	6060-30-43
Litter Break-Away Head Section Bumper .....	6060-36-44
Break-Away Head Lock Release Handle .....	6060-36-37
Fowler Gas Cylinder .....	1010-31-77
Fowler Bumper .....	946-1-155
Litter Adhesive Loop Pile .....	6060-32-46
Base Wheel Assembly .....	6060-2-10
Wheel Bearing .....	81-226
Caster (Wheel) Mount Cover .....	6060-1-21
Rivet (For Caster Mount Cover) .....	25-133
Height Adjustment Extension Spring .....	38-348
Complete Siderail Assembly .....	6060-26-10
Short Safety Hook .....	6060-36-17
Long Safety Hook .....	6060-36-18
Mattress .....	6060-42-10
Sealed Bolster Mattress .....	6060-41-10
Restraint, Lap Belt (2 Used per Unit) .....	6060-160-44
Restraint, Shoulder Harness .....	6060-160-45
Head End Storage Pouch .....	6070-128-10
Fowler Storage Bag Set (2) .....	6070-126-10
Permanent I.V. Pole Kit, Right .....	6070-110-100
Permanent I.V. Pole Kit, Left .....	6070-111-100
Oxygen Bottle Holder – DX Model .....	6060-140
Oxygen Bottle Holder – LX Model .....	6070-140
Oxygen Bottle Holder (Hanging) .....	6080-140
Base Storage Tray .....	6060-150
Touch-Up Paint (Yellow) .....	6060-199-10
Touch-Up Paint (Black) .....	6060-199-11
In-Service Video .....	6080-90-2
Cot Maintenance/Operations Manual .....	6080-90-1
Cot Fastener Installation/Operation Manual .....	6370-90-10
Cot I.V. Pole Caution Label .....	6070-90-5
Cot Usage Warning Label .....	6060-90-10
Cot Base "Lift Here" Label .....	6060-90-6

---

## **European Representative**

Stryker EMEA RA/QA Director  
Stryker France  
ZAC Satolas Green Pusignan  
Av. De Satolas Green  
69881 MEYZIEU Cedex  
France

**stryker**<sup>®</sup>

3800 E. Centre Ave., Portage, MI 49002  
(800) 327-0770  
[www.stryker.com](http://www.stryker.com)



JH 1/06 6080-090-001 REV W