

Operation Guide

ALTERNATIVE USE: TRANSFERRING PATIENT ONTO COT

1. Remove one Speed-Sheet from the dispenser.
2. Verify that the Speed-Sheet has not reached its expiration date.
3. Unfold Speed-Sheet.
4. Gently tilt the patient onto their side.
5. Center Speed-Sheet under the patient and put a linen sheet on top of Speed-Sheet.
6. Lower the patient onto the linen sheet.
7. See Transferring Patient Off the Cot instructions to transfer the patient onto the cot. **Note: A separate Speed-Sheet may be prepared on the cot mattress for later use when transferring the patient off the cot. That Speed-Sheet should be tucked underneath the Speed-Sheet that was placed under the patient.**

Safety Precautions



WARNING

- Do not place Speed-Sheet under patients that are not being transported.
- Remove Speed-Sheet from under the patient if it is activated before the cot reaches the receiving surface.
- Do not use Speed-Sheet to transfer patients with suspected spinal injuries.
- Do not attempt to transfer patient loads greater than what the operators can safely manage. Evaluate the load and use additional assistance if necessary.
- Do not reuse an activated Speed-Sheet; it is not stable for patient transport.
- Inspect Speed-Sheet for obvious damage (tears, abrasions, or punctures) before placing it back on the cot mattress to make sure that it was not activated or damaged.
- Do not use a Speed-Sheet if any obvious damage is observed upon inspection.
- Failure to properly clean or dispose of a contaminated Speed-Sheet increases the risk of exposure to bloodborne pathogens.

Note: Speed-Sheet is made with latex-free materials.

Cleaning

CLEANING SPEED-SHEET (IF NOT ACTIVATED)

If Speed-Sheet was not activated for a patient transfer, it can be manually cleaned (up to 10 times) and placed back on the cot mattress for the next response. To clean, apply one of the suggested cleaners by spray or pre-soaked wipes and allow the cleaner to dry. Inspect the cleaned Speed-Sheet for obvious damage (tears, abrasions, or punctures) before placing it back on the cot mattress to make sure that it was not activated or damaged.

Suggested cleaners for Speed-Sheet include:

- Quaternary Cleaners (active ingredient - ammonium chloride)
- Phenolic Cleaners (active ingredient - o-phenylphenol)
- Chlorinated Bleach Solution (5.25% - less than 1 part bleach to 100 parts water)

Note: Use these cleaners in the concentrations recommended by their manufacturer. Do not use Virex® TB germicidal or alcohol-based products on Speed-Sheet.

Warranty

Stryker EMS warrants to the original purchaser that the Stryker Speed-Sheet should be free from manufacturing non-conformances that affect product performance and customer satisfaction for a period of one (1) year after date of delivery. Stryker's obligation under this warranty is expressly limited to supplying replacement parts.

STRYKER MAKES NO OTHER WARRANTY OR REPRESENTATION EITHER EXPRESSED OR IMPLIED, EXCEPT AS SET FORTH HEREIN. THERE IS NO WARRANTY OF MERCHANTABILITY AND THERE ARE NO WARRANTIES OF FITNESS FOR ANY PARTICULAR PURPOSE. IN NO EVENT SHALL STRYKER BE LIABLE HEREUNDER FOR INCIDENTAL OR CONSEQUENTIAL DAMAGES ARISING FROM OR IN ANY MANNER RELATED TO SALES OR USE OF ANY SUCH EQUIPMENT.

RETURN POLICY

Speed-Sheet may be returned up to 60 days of receipt under the following conditions:

Prior to 30 Days

- Product must be **unused, undamaged**, and in the original packaging.
- Customer will receive a full refund.

Prior to 60 Days

- Product must be **unused, undamaged**, and in the original packaging.
- Customer is responsible for a 15% restocking fee.

RETURN AUTHORIZATION

Stryker customer service department must approve any merchandise return and will provide an authorization number to be printed on any returned merchandise. Stryker reserves the right to charge shipping and restocking fees on returned items. SPECIAL, MODIFIED, OR DISCONTINUED ITEMS NOT SUBJECT TO RETURN.

DAMAGED MERCHANDISE

ICC Regulations require that claims for damaged merchandise must be made with the carrier within fifteen (15) days of receipt of merchandise. DO NOT ACCEPT DAMAGED SHIPMENTS UNLESS SUCH DAMAGE IS NOTED ON THE DELIVERY RECEIPT AT THE TIME OF RECEIPT. Upon prompt notification, Stryker will file a freight claim with the appropriate carrier for damages incurred. Claim will be limited in amount to the actual replacement cost. In the event that this information is not received by Stryker within the fifteen (15) day period following the delivery of the merchandise, or the damage was not noted on the delivery receipt at the time of receipt, the customer will be responsible for payment of the original invoice in full. Claims for any short shipment must be made within thirty (30) days of invoice.

INTERNATIONAL WARRANTY CLAUSE

This warranty reflects U.S. domestic policy. Warranty outside the U.S. may vary by country. Please contact your local Stryker Medical representative for additional information.

PATENT INFORMATION

Stryker Speed-Sheet is covered by one or more of the following patents:

| | |
|---------------|-----------|
| United States | 7,650,654 |
|---------------|-----------|

The yellow and black color scheme is a proprietary trademark of Stryker Corporation.

Manufactured For
Stryker Medical
3800 E. Centre Ave.
Portage, MI 49002
U.S.A.

| | |
|----|-----|
| EC | REP |
|----|-----|

European Representative
Stryker France
ZAC Satolas Green Pusignan
Av. De Satolas Green
69881 MEYZIEU Cedex
France



stryker®

Speed-Sheet™

REF Model 6010

stryker®

Operations Manual



For technical assistance:
USA: 1-800-327-0770



2010/10

6010-009-001 REV D

www.stryker.com

2010/10

6010-009-001 REV D

www.stryker.com

Introduction

This manual is designed to assist you with the operation of the Stryker Speed-Sheet™. Read this manual thoroughly before using the equipment and keep a copy on file. To ensure safe operation, establish procedures for training all staff according to the usage described in this manual.

INTENDED USE OF PRODUCT

The model 6010 Speed-Sheet is intended to be used by trained personnel as a manual lateral patient transfer aid. The device is primarily intended to assist in the transfer of a body in a supine position from an ambulance cot or mortuary cot to an adjacent surface. Alternatively, the device may be used to transfer a body from an adjacent surface onto an ambulance cot or mortuary cot.

PRODUCT DESCRIPTION

Speed-Sheet is a disposable device that significantly reduces the force required to transfer a patient from one surface to another. Speed-Sheet is stable before activation, so it can be placed on the cot mattress before a response and remain under the patient while they are transported. When transferring the patient to another support surface, Speed-Sheet can then be activated to minimize the friction between the linen sheet and cot mattress. Speed-Sheet also provides a fluid-impermeable barrier between the patient and cot mattress for faster clean up.

SPECIFICATIONS

| | | |
|---|------------------------------|-----------------------|
| 10-Pack Part Number | 6010-001-010 | |
| Maximum Patient Weight | 700 lb | 318 kg |
| Speed-Sheet Dimensions | 72 in x 23.5 in | 183 cm x 60 cm |
| Dispenser Dimensions | 12.75 in x 8.75 in x 4.75 in | 32 cm x 22 cm x 12 cm |
| Dispenser Weight (includes 10 Speed-Sheets) | 4.5 lb | 2 kg |
| Storage Temperature | -4°F - 104°F | -20°C - 40°C |
| Storage Relative Humidity | 0% - 100% | |

SYMBOLS

| | | |
|---|------------------------------------|-----------------|
| Warning, consult accompanying documentation | Single Use (when activated) | Manual Cleaning |
| Resin Identification Code | Batch Code | Expiration Date |
| Relative Humidity Limitation | Temperature Limitation | Manufacturer |
| Model Number | Authorized European Representative | |

WARNING/NOTE DEFINITION

The words **WARNING** and **NOTE** carry special meanings and should be carefully reviewed.

WARNING

Alerts the reader about a situation which, if not avoided, could result in death or serious injury. It may also describe potential serious adverse reactions and safety hazards.

Note: Provides special information to make maintenance easier or important instructions clearer.

Operation Guide

PREPARING THE COT BEFORE A RESPONSE

1. Remove one Speed-Sheet from the dispenser.
2. Verify that the Speed-Sheet has not reached its expiration date (Figure 1).

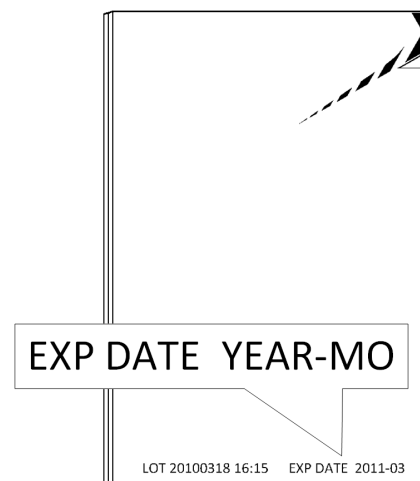

Figure 1

3. Unfold and center Speed-Sheet directly on top of the cot mattress.
4. Inspect Speed-Sheet for obvious damage (tears, abrasions, or punctures).
5. Place a linen sheet on top of Speed-Sheet (Figure 2).

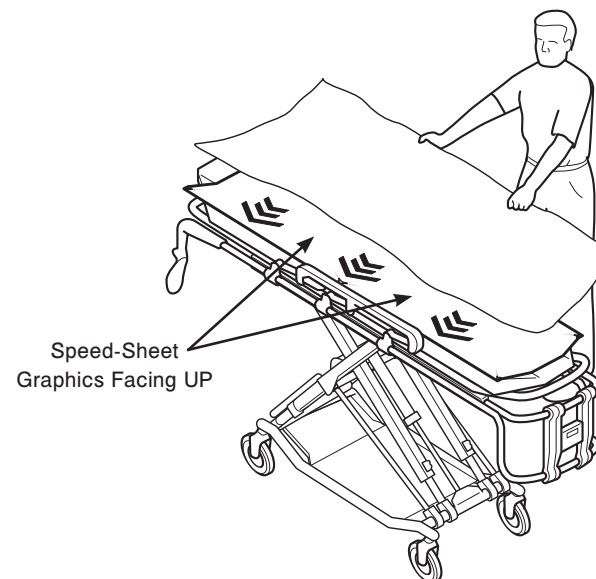

Figure 2

Operation Guide

TRANSFERRING PATIENT OFF THE COT

1. Position the cot alongside the receiving patient support platform.
2. Adjust the cot height so the cot mattress is flat and approximately 1 in (2.5 cm) above the receiving patient support surface.
3. Secure the cot and patient support platform together to prevent separation.
4. Lower all siderails.
5. Tear at least one red tab 3-6 in (8-16 cm) to activate Speed-Sheet (Figure 3 or Figure 4). **Note: Tearing more than one tab can improve performance.**

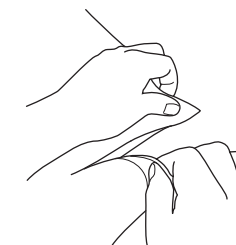

Figure 3

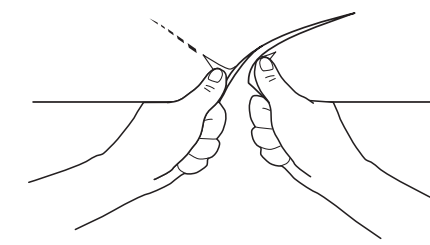

Figure 4

6. With at least one operator on each side of the patient, pull on the linen sheet to transfer the patient (Figure 5).

Note: Pull on the linen sheet. Do NOT pull on Speed-Sheet. Pull horizontally. Do NOT lift the linen sheet.

An overhand grip on the linen sheet encourages proper pulling technique. If the patient's condition permits, the operator on the cot side of the transfer may gently push on the patient rather than grasping the linen sheet.

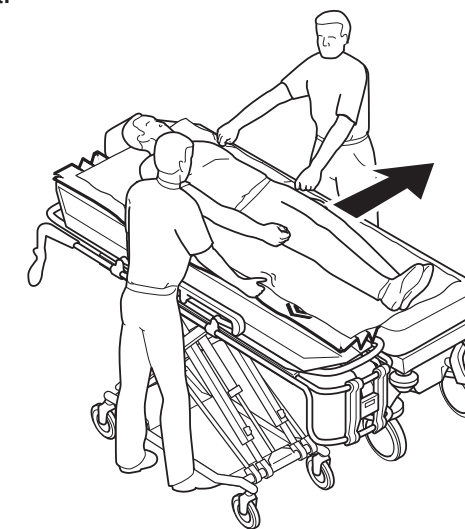

Figure 5

7. Raise the siderails on both sides of the patient after the transfer.
8. Dispose of the activated Speed-Sheet according to local medical disposal protocol and replace it with a new one before the next response.