

stryker[®]
Medical

LY1600/3300-000-300 Series

Operations/Maintenance Manual

For Parts or Technical Assistance
800-327-0770

LY1600/3300-000-300 Series

Table of Contents

Style	LY1601/3300-000-301	
	LY1602/3300-000-302	
	LY1603/3300-000-303	2-3
Specification	LY1601/3300-000-301	4
Specification	LY1602/3300-000-302	5
Specification	LY1603/3300-000-303	6

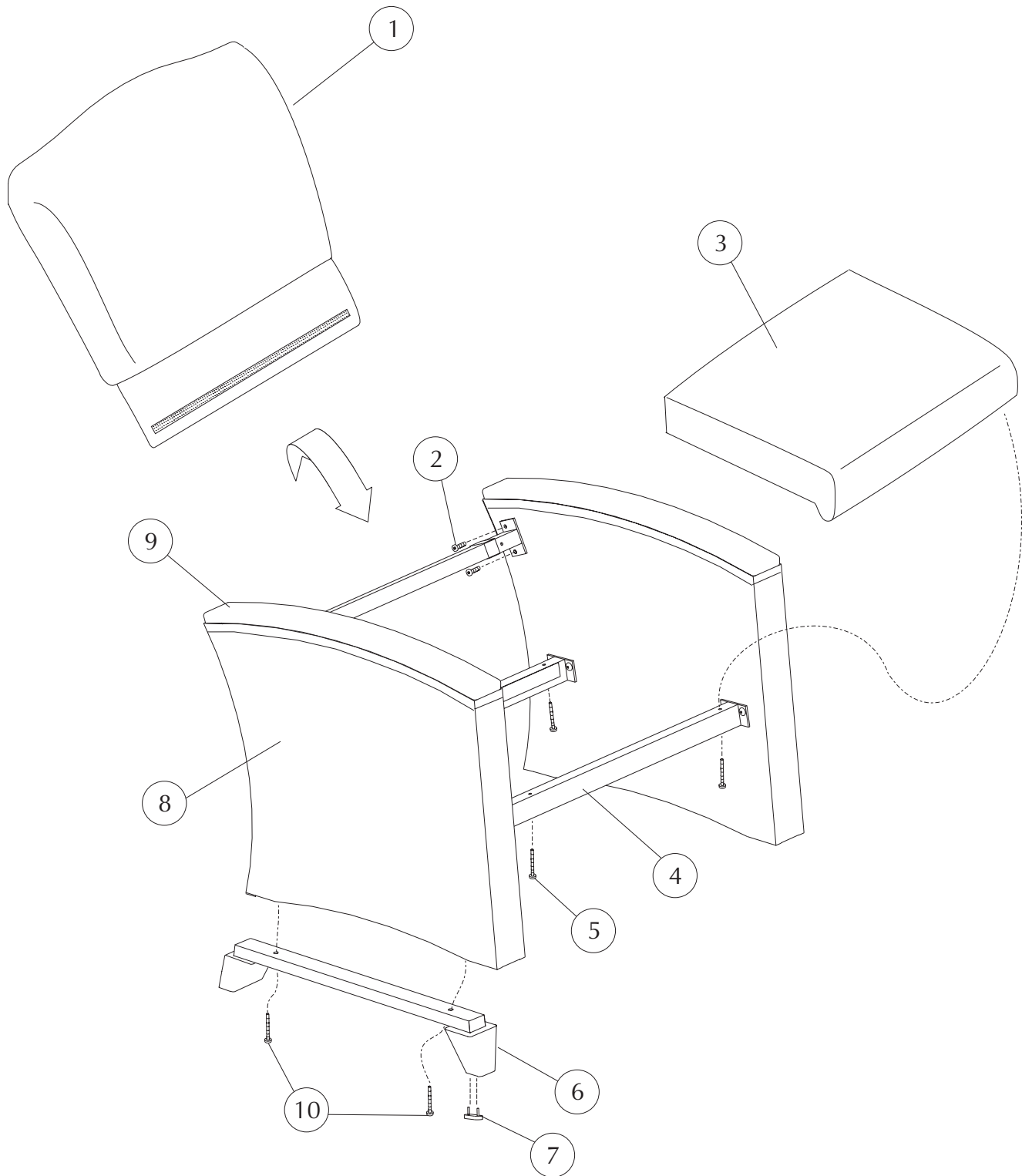

- STYLE LY1601/3300-000-301 = SINGLE UPHOLSTERED LOUNGE CHAIR (FEATURED)
- LY1602/3300-000-302 = DOUBLE UPHOLSTERED LOUNGE CHAIR
- LY1603/3300-000-303 = TRIPLE UPHOLSTERED LOUNGE CHAIR

STRYKER MEDICAL HEALTHCARE SERIES

Note: When replacing parts, specify style and acknowledgment numbers.

DETAIL#	SYK PN	LZB PN	DESCRIPTION	QUANTITY
Single Upholstered Lounge Chair (LY1601/3300-000-301):				
1	3304-048-000	61990480-00**	Back Upholstered plus 1.5 yd cover required	1
2	3300-002-402	96000024-02	1/4-20 x 1" Torx Truss Head Screw	12
3	3309-102-801	51991028-01**	Seat Upholstered plus 1 yd cover required	1
4	3307-018-101	52970181-01	Support Tube Subassembly	3
5	3300-081-500	96000815-00	#10 x 2 1/2" Phillips Pan Head Screw	4
6	3309-047-500	61990475-00*	Foot Subassembly, Finished	2
7	3300-047-500	96000475-00	Glide	4
8	3309-047-600	61990476-00**	Arm Upholstered plus 2.5 yd cover required	2
9	3309-057-400	61990574-00*	Top Arm Finished (standard)	2
	3309-047-400	64990474-00**	Top Arm Upholstered plus 1 yd cover required (option)	2
10	3300-002-403	96000024-03	1/4-20 x 1 3/4" Torx Truss Head Screw	4
Double Upholstered Lounge Chair (LY1602/3300-000-302):				
1	3304-048-000	61990480-00**	Back Upholstered plus 1.5 yd cover required	2
2	3300-002-402	96000024-02	1/4-20 x 1" Torx Truss Head Screw	12
3	3309-102-801	51991028-01**	Seat Upholstered plus 1 yd cover required	2
4	3307-018-102	52970181-02	Support Tube Subassembly	3
5	3300-081-500	96000815-00	#10 x 2 1/2" Phillips Pan Head Screw	8
6	3309-047-500	61990475-00*	Foot Subassembly Finished	2
7	3300-047-500	96000475-00	Glide	4
8	3309-047-600	61990476-00	Arm Upholstered plus 2.5 yd cover required	2
9	3309-057-400	61990574-00*	Top Arm Finished (standard)	2
	3309-047-400	64990474-00*	Top Arm Upholstered plus 1 yd cover required (option)	2
10	3300-002-403	96000024-03**	1/4-20 x 1 3/4" Torx Truss Head Screw	4
Triple Upholstered Lounge Chair (LY1603/3300-000-303):				
1	3304-048-000	61990480-00**	Back Upholstered plus 1.5 yd cover required	3
2	3300-002-402	96000024-02	1/4-20 x 1" Torx Truss Head Screw	12
3	3309-102-801	51991028-01**	Seat Upholstered plus 1 yd cover required	3
4	3307-018-103	52970181-03	Support Tube Subassembly	3
5	3300-081-500	96000815-00	#10 x 2 1/2" Phillips Pan Head Screw	12
6	3309-047-500	61990475-00	Foot Subassembly Finished	2
7	3300-047-500	96000475-00	Glide	4
8	3309-047-600	61990476-00	Arm Upholstered plus 2.5 yd cover required	2
9	3309-057-400	61990574-00*	Top Arm Finished (standard)	2
	3309-047-400	64990474-00**	Top Arm Upholstered plus 1 yd cover required (option)	2
10	3300-002-403	96000024-03**	1/4-20 x 1 3/4" Torx Truss Head Screw	4

* Indicate finish or color when ordering
 ** Indicate fabric cover number when ordering

Style LY1601/3300-000-301 Single Upholstered Lounge Chair

Dimensions:	Back Height from Floor	33.38"		
	Back Height from Seat	18.75"		
	Seat Height from Floor	16.75"		
	Seat Width	22.50"		
	Seat Depth	20.00"		
	Arm Height from Floor	25.00"		
	Arm Height from Seat	9.50"		
	Distance between Arms	22.50"		
	Overall Width	28.75"		
	Overall Depth	30.25"		
	Weight	84 lbs.		
Finish:	Type of Finish	High Solids Catalyzed Lacquer		
	Available Colors	150	Hard Rock Maple	051 Natural
		154	Fine Oak	431 Dark Cherry
		151	Port Maple	143 White Blush
		152	Wild Cherry	435 Classic Cherry
		447	Cayenne Maple	
		448	Honey Maple	
		449	Select Cherry	
Frame Construction:	Frame Material	Furniture grade plywood		
	Frame Construction	Steel channel cross members		
	Arm Cap Attachment	Arm attached to body with spring steel compression dowels		
Seat Construction:	Frame Material	Furniture grade plywood		
	Suspension	Woven Ultraflex latex webbing		
	Foam Type	High resilient (HR) polyurethane foam MFG-8-33, 33 lb ILD, 2.50-2.70 density		
Back Construction:	Frame Material	Furniture grade plywood		
	Foam Type	High resilient (HR) polyurethane foam MFG-8-20, 20 lb ILD, 2.25-2.45 density		
Upholstery Details:	Patterns Available	Fabric, leather, leather finesse, vinyl, C.O.M.		
Test Data:	Fabric Tests	Consult specific fabric card		
	BIFMA Tests	Meets ANSI/BIFMA X5.4 - 1990 American National Standard for Office Furnishings -Lounge Seating. Tests conducted in La-ZBoy's accredited test facility.		
	Flammability Tests	Meets BIFMA First Generation Voluntary Upholstered Furniture Flammability Standard for Business and Institutional Markets, F1-1978-revised 1980. California Bureau of Home Furnishings - Technical Bulletin 117. Meets Flammability Requirements of California Bureau of Home Furnishings Technical Bulletin 133 when ordered with La-Z-Boy Code Red Fabrics and Vinyl's. Consult a Stryker Customer Service Representative at 1-800-STRYKER for further information. Upholstered Furniture Action Council Class 1.		

Style LY1602/3300-000-302 Double Upholstered Lounge Chair

Dimensions:	Back Height from Floor	33.38"		
	Back Height from Seat	18.75"		
	Seat Height from Floor	16.75"		
	Seat Width	44.63"		
	Seat Depth	20.00"		
	Arm Height from Floor	25.00"		
	Arm Height from Seat	9.50"		
	Distance between Arms	44.63"		
	Overall Width	50.88"		
	Overall Depth	30.25"		
	Weight	110 lbs.		
Finish:	Type of Finish	High Solids Catalyzed Lacquer		
	Available Colors	150	Hard Rock Maple	051 Natural
		154	Fine Oak	431 Dark Cherry
		151	Port Maple	143 White Blush
		152	Wild Cherry	435 Classic Cherry
		447	Cayenne Maple	
		448	Honey Maple	
		449	Select Cherry	
Frame Construction:	Frame Material	Furniture grade plywood		
	Frame Construction	Steel channel cross members		
	Arm Cap Attachment	Arm attached to body with spring steel compression dowels		
Seat Construction:	Frame Material	Furniture grade plywood		
	Suspension	Woven Ultraflex latex webbing		
	Foam Type	High resilient (HR) polyurethane foam MFG-8-33, 33 lb ILD, 2.50-2.70 density		
Back Construction:	Frame Material	Furniture grade plywood		
	Foam Type	High resilient (HR) polyurethane foam MFG-8-20, 20 lb ILD, 2.25-2.45 density		
Upholstery Details:	Patterns Available	Fabric, leather, leather finesse, vinyl, C.O.M.		
Test Data:	Fabric Tests	Consult specific fabric card		
	BIFMA Tests	Meets ANSI/BIFMA X5.4 - 1990 American National Standard for Office Furnishings -Lounge Seating. Tests conducted in La-Z-Boy's accredited test facility.		
	Flammability Tests	Meets BIFMA First Generation Voluntary Upholstered Furniture Flammability Standard for Business and Institutional Markets, F1-1978-revised 1980. California Bureau of Home Furnishings - Technical Bulletin 117. Meets Flammability Requirements of California Bureau of Home Furnishings Technical Bulletin 133 when ordered with La-Z-Boy Code Red Fabrics and Vinyl's. Consult a Stryker Customer Service Representative at 1-800-STRYKER for further information. Upholstered Furniture Action Council Class 1.		

Style LY1603/3300-000-303 Triple Upholstered Lounge Chair

Dimensions:	Back Height from Floor	33.38"		
	Back Height from Seat	18.75"		
	Seat Height from Floor	16.75"		
	Seat Width	66.75"		
	Seat Depth	20.00"		
	Arm Height from Floor	25.00"		
	Arm Height from Seat	9.50"		
	Distance between Arms	66.75"		
	Overall Width	73.00"		
	Overall Depth	30.25"		
	Weight	135 lbs.		
Finish:	Type of Finish	High Solids Catalyzed Lacquer		
	Available Colors	150	Hard Rock Maple	051 Natural
		154	Fine Oak	431 Dark Cherry
		151	Port Maple	143 White Blush
		152	Wild Cherry	435 Classic Cherry
		447	Cayenne Maple	
		448	Honey Maple	
		449	Select Cherry	
Frame Construction:	Frame Material	Furniture grade plywood		
	Frame Construction	Steel channel cross members		
	Arm Cap Attachment	Arm attached to body with spring steel compression dowels		
Seat Construction:	Frame Material	Furniture grade plywood		
	Suspension	Woven Ultraflex latex webbing		
	Foam Type	High resilient (HR) polyurethane foam MFG-8-33, 33 lb ILD, 2.50-2.70 density		
Back Construction:	Frame Material	Furniture grade plywood		
	Foam Type	High resilient (HR) polyurethane foam MFG-8-20, 20 lb ILD, 2.25-2.45 density		
Upholstery Details:	Patterns Available	Fabric, leather, leather finesse, vinyl, C.O.M.		
Test Data:	Fabric Tests	Consult specific fabric card		
	BIFMA Tests	Meets ANSI/BIFMA X5.4 - 1990 American National Standard for Office Furnishings -Lounge Seating. Tests conducted in La-Z-Boy's accredited test facility.		
	Flammability Tests	Meets BIFMA First Generation Voluntary Upholstered Furniture Flammability Standard for Business and Institutional Markets, F1-1978-revised 1980. California Bureau of Home Furnishings - Technical Bulletin 117. Meets Flammability Requirements of California Bureau of Home Furnishings Technical Bulletin 133 when ordered with La-Z-Boy Code Red Fabrics and Vinyl's. Consult a Stryker Customer Service Representative at 1-800-STRYKER for further information. Upholstered Furniture Action Council Class 1.		